

BOEING
707
PARTS CATALOG (MAINTENANCE)

CHAPTER 36

PNEUMATIC

TABLE OF CONTENTS

SECTION	FIGURE
36-01 TURBOCOMPRESSOR	
COOLER INSTL, TURBOCOMPRESSOR OIL	18
DRAIN INSTL, FAN ENGINE	13
DRAIN INSTL, FAN ENGINE TURBOCOMPRESSOR	13A
DUCT INSTL, WING THERMAL ANTI-ICING AND AIR CONDITIONING	10
DUCT INSTL, WING THERMAL ANTI-ICING AND AIR CONDITIONING.	11
FAIRING ASSY, NACELLE TURBOCOMPRESSOR FORWARD	17
FAIRING ASSY, TURBOCOMPRESSOR INLET	16
PANEL INSTL, TURBOCOMPRESSOR OIL COOLER	18
PLUMBING INSTL, ENGINE TURBOCOMPRESSOR OIL SUPPLY LINE.	15
PLUMBING INSTL, FAN ENGINE TURBOCOMPRESSOR STATIC SENSING	15A
TURBOCOMPRESSOR INSTL, FAN ENGINE	2
36-04 MISCELLANEOUS	
EQUIPMENT INSTL, ELECTRONIC RACK.	2
EQUIPMENT INSTL, LH ELECTRONIC RACK	1
EQUIPMENT INSTL, RACK LOWER SECTION 41.	2

BOEING
Intercontinental
707 
PARTS CATALOG

SECTION 01
TURBOCOMPRESSOR

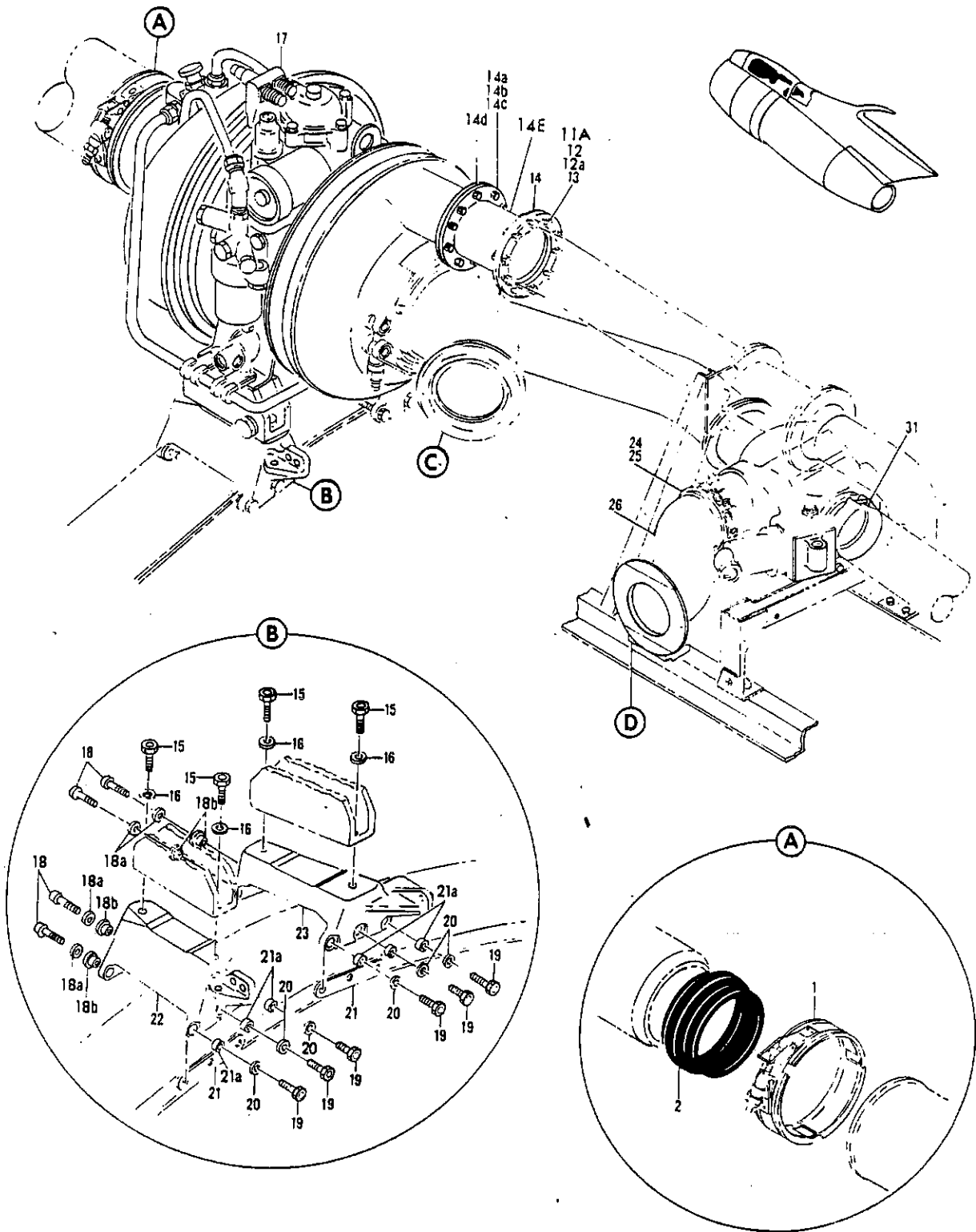

FIGURE 2. TURBOCOMPRESSOR INSTL, FAN ENGINE (SHEET 1)

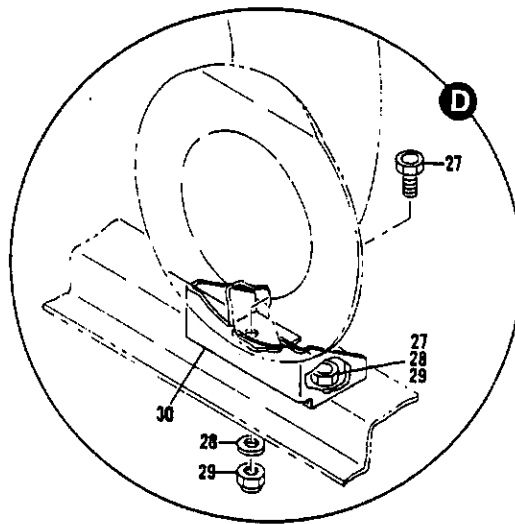
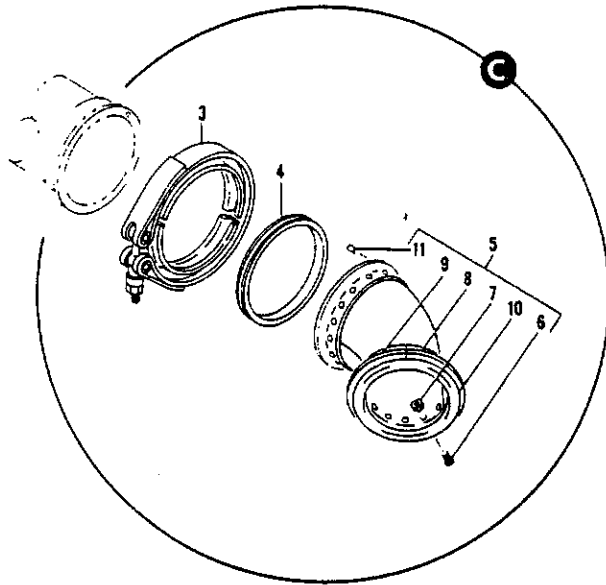

FIGURE 2. TURBOCOMPRESSOR INSTL, FAN ENGINE (SHEET 2)

NOV 21/90

36-01-2

DETAILED PARTS LIST
36-01-2
PAGE 1



PARTS CATALOG

FIGURE & ITEM NO.	MANUFACTURER'S PART NUMBER	NOMENCLATURE							EFF FROM TO	UNITS PER ASSY
		1	2	3	4	5	6	7		
2	65-11792	TURBOCOMPRESSOR INSTL, FAN ENGINE (ENGINES NO. 2, 3 AND 4) (SEE 71-1, FIG. 5, ITEM 18, 71-1, FIG. 5B, ITEM 50, 71-1, FIG. 5E, ITEM 64, 71-1, FIG. 5G, ITEM 59 AND 71-1, FIG. 5H, ITEM 50)								RF
1	BACC10AJ550	. CLAMP								1
2	BAC313J550	. SLEEVE								1
3	BACC10AC581	. COUPLING								1
4	BACG10R506	. GASKET								1
5	65-15981	. DUCT ASSY, TURBOCOMPRESSOR EXHAUST								1
6	NAS514P632-8	. SCREW								16
7	NAS679A06W	. NUT								16
8	66-11718-1	. RETAINER, TURBOCOMPRESSOR EXHAUST DUCT SEAL								1
9	66-11718-2	. RETAINER, TURBOCOMPRESSOR EXHAUST DUCT SEAL								1
10	66-11719	. SEAL, TURBOCOMPRESSOR EXHAUST								1
11	NAS561C2-4	. PIN								1
11A	BACB30LM4U7	. BOLT								9
12	BACB30LM4U8	. BOLT								1
13	NAS679C4W	. NUT								10
14	5-67133-16	. GASKET ASSY, AIR DUCT JOINT								1
15	NAS1305-12	. BOLT								4
16	MS20002C5	. WASHER								4
17	10-3079-14	. TURBOCOMPRESSOR ASSY, CABIN AIR CONDITIONING							0150	1
17	10-3079-23	. TURBOCOMPRESSOR ASSY, CABIN AIR CONDITIONING							5199	1
24	BACC10AC356	. COUPLING								1
25	BACG10R281	. GASKET								1
26	65-11983-4	. DUCT ASSY, TURBOCOMPRESSOR EXHAUST SURGE BLEED								1
27	NAS1104-3W	. BOLT								2
28	AN960-416L	. WASHER								2
29	NAS679A4W	. NUT								2
30	69-10915-10	. BRACKET, SURGE BLEED VALVE SUPPORT								1
31	TA4C67SS48T	. CLAMP, (V84971)								1
	AN3-4	ATTACHING PARTS								
		. BOLT								2
		-----*								

MISSING ITEM NUMBERS ARE NOT APPLICABLE

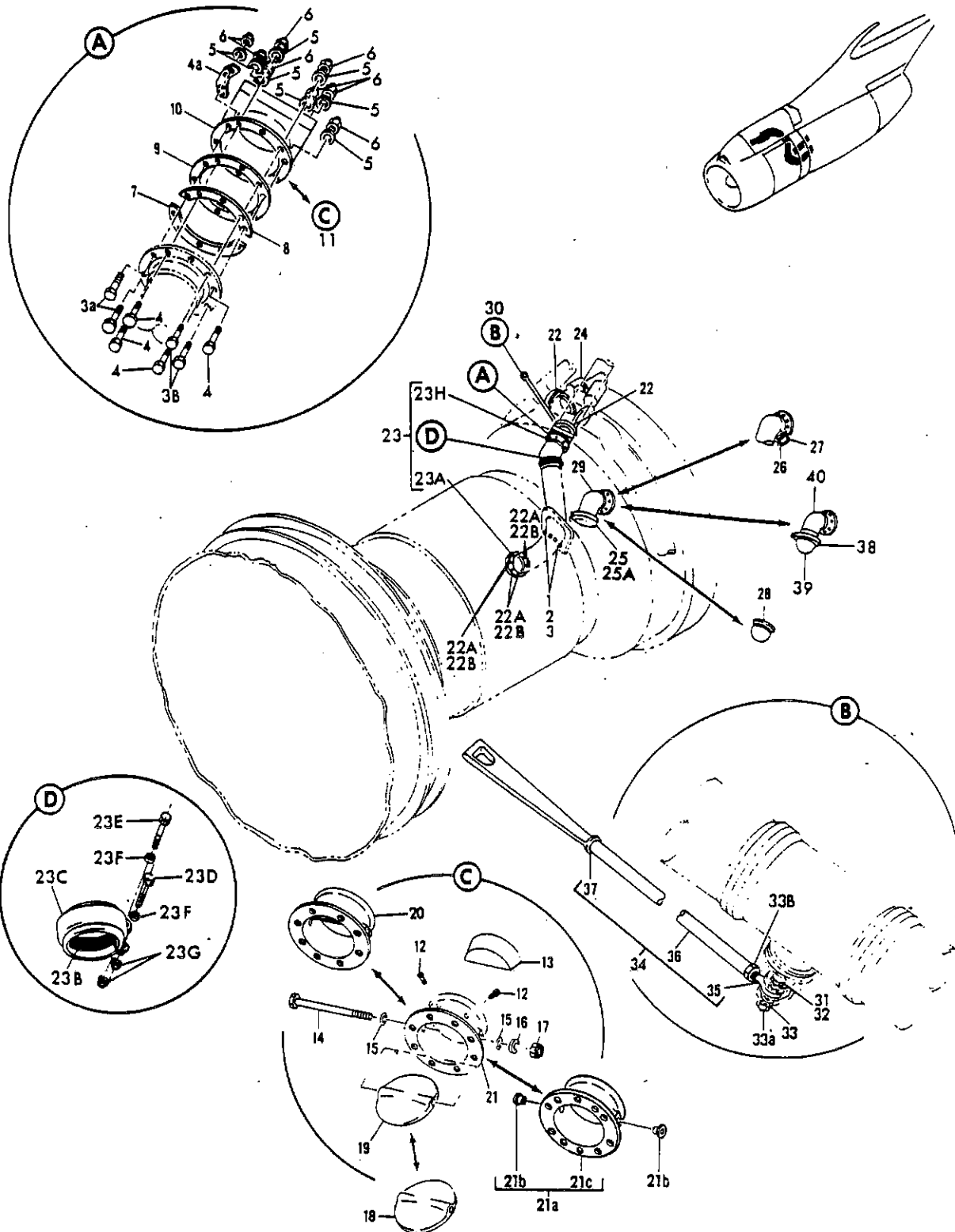

FIGURE 10. DUCT INSTL, WING THERMAL ANTI-ICING AND AIR CONDITIONING



PARTS CATALOG

FIGURE & ITEM NO.	MANUFACTURER'S PART NUMBER	NOMENCLATURE	EFF FROM TO	UNITS PER ASSY		
					1	2
10	65-11899-1	DUCT INSTL, WING THERMAL ANTI-ICING AND AIR CONDITIONING . DUCT INSTL, WING THERMAL ANTI-ICING AND AIR CONDITIONING (ENGINE NO. 1) (SEE 71-1, FIG. 5, ITEM 27, 71-1, FIG. 5B, ITEM 51, 71-1, FIG. 5E, ITEM 65, 71-1, FIG. 5G, ITEM 60 AND 71-1, FIG. 5H, ITEM 51)		RF		
R	1	BACB30NF3-3	5199	4		
R	1	BACB30NF3-3	0150	4		
R	2	AN960C416	5199	4		
R	2	AN960C416	0150	4		
R	3	BACN10JC3	5199	4		
R	3	BACN10JC3	0150	4		
R	3A	BACB30NF3-8		2		
R	3B	BACB30NF3-8	0150	2		
R	3B	BACB30NF3H8	5199	2		
R	3B	BACB30NF3H8	0150	2		
	4	BACB30NF3-8		6		
	4A	66-18982-2		1		
	5	AN960-10L		10		
	6	BACN10JC3		10		
	7	66-4173-2		1		
	8	66-4173-1		1		
R	9	BACG10R321	5199	1		
R	9	BACG10R321	0150	1		
	11	65-22777-4		1		
	12	BACS12AE3C		2		
	13	69-43132-1		1		
	14	69-43161-1		1		
	15	AN900-3		2		
	16	AN960C10		1		
	17	NAS679C3W		1		
	19	69-16574-2		1		
	21A	65-23742-2		1		
	21B	BACB28X3B24		2		
	21C	65-23742-3		1		
	22	BACCI0DP300		2		
R	22A	BACB30GB3H0B	0450	6		
R	22A	BACB30GB3H0B	5199	6		
R	22A	BACB30LE5HU2	0450	6		
R	22B	BACW10BP5ACU	0450	6		
	23	65-11899-66	0103	1		
	23	65-69311-1	0103	1		
	23	65-69311-1	0499	1		
	23B	65-11899-75		RF		
	23B	40017-48	0499	1		
	23B	40017-48	0103	1		
	23C	4133-48S	0499	1		
	23C	4133-48S	0103	1		
R	23D	BACB30NF3-4	5199	1		
R	23D	BACB30NF3-4	0103	1		
R	23E	BACB30NF3H4	5199	1		
R	23E	BACB30NF3H4	0150	1		
R	23E	BACB30NF3-4	0450	1		
	23F	AN960C10L	0499	2		
	23F	AN960C10L	0103	2		
	23G	NAS679C3W	0499	2		
	23G	NAS679C3W	0103	2		
	23H	66-4162-1		1		
	24	10-60404-9		1		
		ATTACHING PARTS				
		BOLT.		2		
		NUT		2		
	25	C40C60		1		
	30	65-27130-1		1		
	31	BACB30NE30B		1		
	32	NAS620-10L		1		
	33	AN320C3		1		
	34	66-18950-1		1		
	35	BACB10J11		1		

MISSING ITEM NUMBERS ARE NOT APPLICABLE

BOEING
Intercontinental

PARTS CATALOG

FIGURE & ITEM NO.		MANUFACTURER'S PART NUMBER	NOMENCLATURE							EFF FROM TO	UNITS PER ASSY
			1	2	3	4	5	6	7		
10	35	AHM3		1
	36	66-18949-1		1
	37	69-25815-1		1
MISSING ITEM NUMBERS ARE NOT APPLICABLE											

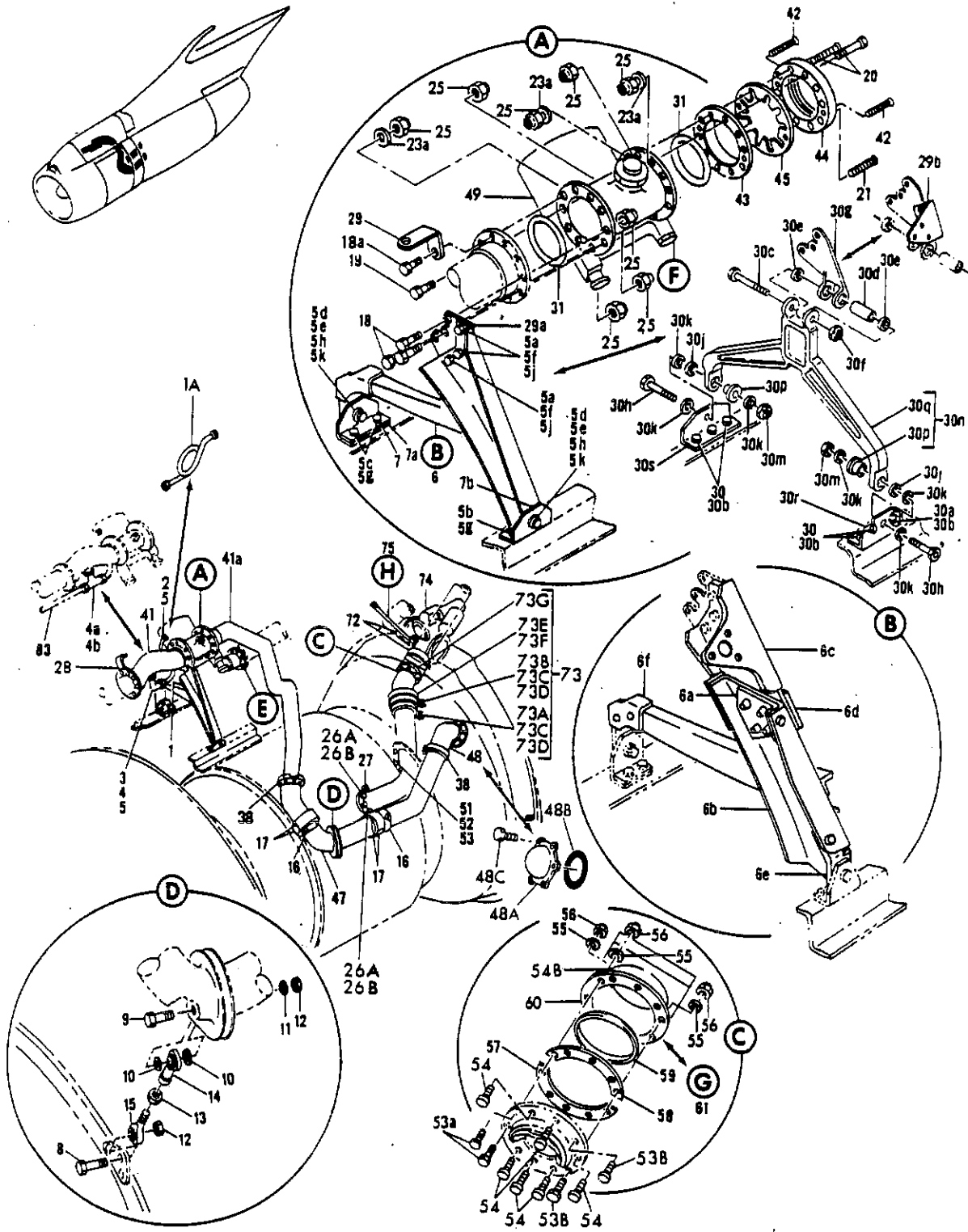

FIGURE 11. DUCT INSTL, WING THERMAL ANTI-ICING AND AIR CONDITIONING (ENGINES NO. 2, 3, AND 4) (SHEET 1)

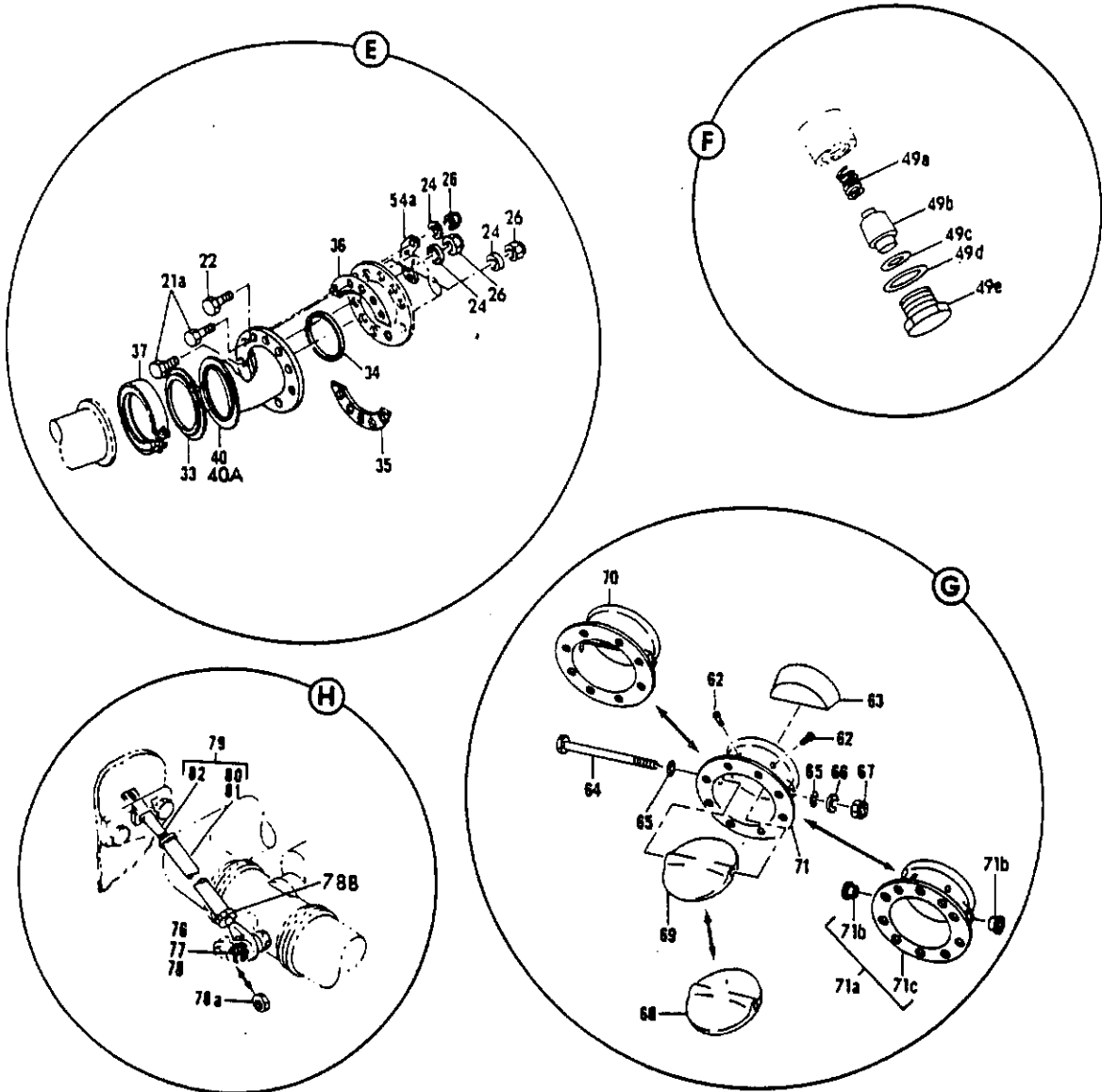

FIGURE 11. DUCT INSTL, WING THERMAL ANTI-ICING AND AIR CONDITIONING (ENGINES NO. 2, 3, AND 4) (SHEET 2)



PARTS CATALOG

FIGURE & ITEM NO.	MANUFACTURER'S PART NUMBER	NOMENCLATURE	EFF	UNITS
			FROM TO	PER ASSY
11	65-11899	DUCT INSTL, WING THERMAL ANTI-ICING AND AIR CONDITIONING (ENGINES NO. 2, 3 AND 4) (SEE 71-1, FIG. 5, ITEM 27, 71-1, FIG. 5B, ITEM 51, 71-1, FIG. 5E, ITEM 65, 71-1, FIG. 5G, ITEM 60 AND 71-1, FIG. 5H, ITEM 51)		RF
1	65-11899-824	. TUBE ASSY, PRESSURE SENSING 3/8 IN. .028 AISI321. (OPTIONAL AISI347)	0103	1
1	65-11899-876	. TUBE ASSY, PRESSURE SENSING 3/8 IN. .028 AISI321. (OPTIONAL AISI347)	0499	1
	MS21921-6C NUT		2
	BACS13AP6 SLEEVE. (OPTIONAL MS21922-6)		2
	MS21922-6 SLEEVE. (OPTIONAL TO BACS13AP6)		2
2	MS21902-6C UNION		1
3	AN924-6C NUT		1
4	MS21926-6C ELBOW		1
5	AN901-6C GASKET.		2
8	BACB30NF3-8 BOLT.		1
9	BACB30NF3-11 BOLT.		1
10	AN960C10 WASHER.		2
11	AN960C10L WASHER.		1
12	BACN10JC3 NUT		2
13	NAS509-3 NUT		1
14	BACB10A188D BEARING		1
15	BACB10A182D BEARING		1
16	BACCI0816 CLAMP		2
17	69-14540-1 GUARD, PNEUMATIC DUCT UNIVERSAL JOINT BELLOWS		4
18	BACB30LM4U8 BOLT.		3
18A	BACB30LM4U8 BOLT.		1
19	BACB30LM4U6 BOLT.		6
20	BACB30LM4U17 BOLT.		9
21	BACB30LM4U18 BOLT.		1
21A	BACB30NF3-8 BOLT.		2
22	BACB30NF3-8 BOLT.		8
24	AN960-10L WASHER.		10
25	BACN10JC4 NUT		20
26	BACN10JC3 NUT		10
26A	BACB30G83H08 BOLT, (ADDED BY SB 2655).	0450	6
26A	BACB30G83H08 BOLT.	5199	6
26A	BACB30LE5HU2 BOLT, (DELETED BY SB 2655).	0450	6
26B	BACW10PB5ACU WASHER, (DELETED BY SB 2655).	0450	6
27	65-11899-37 BRACKET, WING THERMAL ANTI-ICING AND AIR CONDITIONING DUCT		1
28	66-10951-800 CLIP, THERMAL ANTI-ICING AND AIR CONDITIONING DUCT. SUPPORT BRACKET		1
29	66-10951-801 CLIP, THERMAL ANTI-ICING AND AIR CONDITIONING DUCT. SUPPORT BRACKET		1
	65-42336-1 BRACKET INSTL, PRESSURE REGULATOR SUPPORT		1
	NAS1104-4 BOLT.		5
30A	NAS1104-6 BOLT.		1
30B	AN960D416L WASHER.		6
30C	NAS1104-31 BOLT.		1
30D	NAS74A4E109P BUSHING		1
30E	AN960-716L WASHER.		2
30F	NAS679A4W NUT		1
30G	65-42194-1 BRACKET, PRESSURE REGULATOR VALVE UPPER SUPPORT		1
30H	NAS1104-10 BOLT.		2
30J	NAS72-4E007 BUSHING		2
30K	AN960-416L WASHER.		6
30M	NAS679A4W NUT		2
30N	65-42186-1 BRACKET ASSY.	0150	1
30N	65-42186-4 BRACKET ASSY.	5199	1
30P	NAS77A7-30P BUSHING		2
30Q	65-42186-2 BRACKET	0150	1
30Q	65-42186-5 BRACKET	5199	1
30R	69-33677-800 BRACKET, FAN ENGINE PRESSURE REGULATOR SUPPORT.		1
30S	69-33677-3 BRACKET, FAN ENGINE PRESSURE REGULATOR SUPPORT.		1
31	5-67133-16 GASKET ASSY, AIR DUCT JOINT		2
33	BACG10Y300 GASKET.		1
34	BACG10R321 GASKET.		1
35	66-4173-2 RING, AIR DUCT JOINT FILLER HALF (ALTERED FROM. 66-4173)		1
36	66-4173-1 RING, AIR DUCT JOINT FILLER HALF.		1

MISSING ITEM NUMBERS ARE NOT APPLICABLE



PARTS CATALOG

FIGURE & ITEM NO.	MANUFACTURER'S PART NUMBER	NOMENCLATURE	EFF FROM TO	UNITS PER ASSY		
					1	2
11	37	BACC10AU300		1		
	38	C40C60		2		
	40A	66-4162-1		1		
	41A	65-60464-2		1		
	42	NAS514P832-8		2		
	43	69-14532-1		1		
	44	69-14531-1		1		
	45	69-14534-1		1		
	47	65-60464-1		1		
R	48	65-11899-58	5199	1		
R	48	65-11899-57	0150	1		
R	49	10-3079-11	0150	1		
R	49	10-3079-22	5199	1		
R	51	BACB30NF3-3	5199	4		
R	51	BACB30NF3-3	0150	4		
R	52	AN960C416	5199	4		
R	52	AN960C416	0150	4		
R	53	BACN10J3C	5199	4		
R	53	BACN10J3C	0150	4		
R	53A	BACB30NF3-8		2		
R	53B	BACB30NF3-8	0150	2		
R	53B	BACB30NF3H8	5199	2		
R	53B	BACB30NF3H8	0150	2		
	54	BACB30NF3-8		6		
	54A	66-18982-2		1		
	54B	66-18982-2		1		
	55	AN960-10L		10		
	56	BACN10JC3		10		
	57	66-4173-2		1		
	58	66-4173-1		1		
	58	66-4173-1		1		
	59	BACG10R321		1		
	61	65-22777-4		1		
	62	BACS12AE3C		2		
	63	69-43132-1		1		
	64	66-13694-2		1		
	64	69-43161-1		1		
	65	AN900-3		2		
	66	AN960C10		1		
	67	NAS679A3W		1		
	67	NAS679C3W		1		
	69	69-16574-2		1		
	71A	65-23742-2		1		
	71B	BACB28X3B24		2		
	71C	65-23742-3		2		
	72	BACC10DP300		2		
	73	65-11899-66	0103	1		
	73	65-69311-1	0103	1		
	73	65-11899-75		RF		
	73	65-69311-1	0499	1		
R	73A	BACB30NF3-4	5199	1		
R	73B	BACB30NF3-4	0450	1		
R	73B	BACB30NF3H4	5199	1		
R	73B	BACB30NF3H4	0450	1		
R	73B	BACB30NF3-4	0450	1		
	73C	AN960C10L	0499	2		
	73D	NAS679C3W	0499	2		
	73E	4133-485	0499	1		
	73F	40017-48	0499	1		
	73G	66-4162-1		1		
	74	10-60404-9		1		
		NAS1103-2W		2		
		NAS679A3W		2		

MISSING ITEM NUMBERS ARE NOT APPLICABLE



PARTS CATALOG

FIGURE & ITEM NO.	MANUFACTURER'S PART NUMBER	1 2 3 4 5 6 7	NOMENCLATURE	EFF FROM TO	UNITS
					PER ASSY
11 75	65-27130-1		. ROD INSTL, FAN ENGINE STARTER VALVE MANUAL OVERRIDE CONTROL		1
76	BACB30NE3D8		. . BOLT.		1
77	NAS620-10L		. . WASHER.		1
78	AN320C3		. . NUT		1
79	66-18950-1		. . ROD ASSY, STARTER VALVE MANUAL OVERRIDE CONTROL		1
80	BACB10J11		. . . BEARING, (OPTIONAL TO AHM3 (V50294)		1
80	AHM3		. . . BEARING, (V50294) (OPTIONAL BACB10J11).		1
81	66-18949-1		. . . ARM, START VALVE MANUAL OVERRIDE CONTROL ROD.		1
82	69-25815-1		. . . FITTING, STARTER VALVE MANUAL OVERRIDE CONTROL ROD		1

MISSING ITEM NUMBERS ARE NOT APPLICABLE

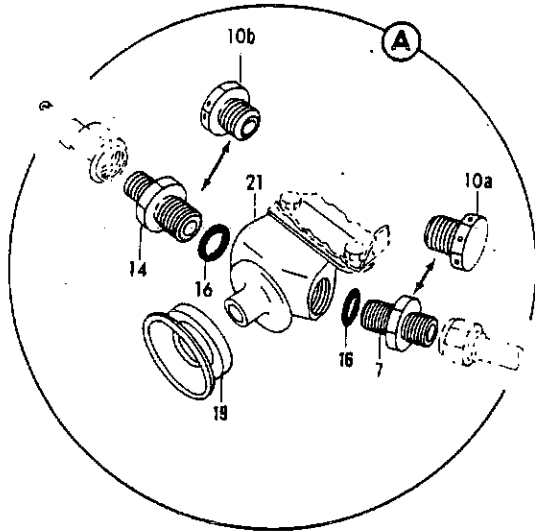
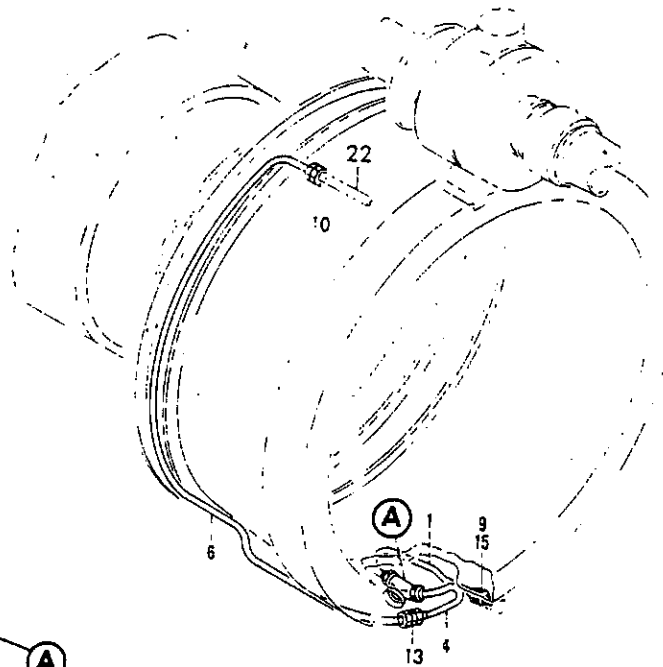
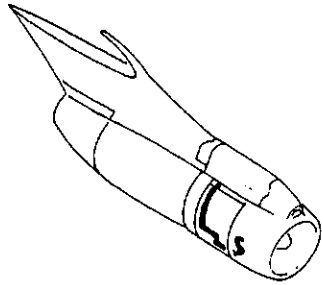

FIGURE 13. DRAIN INSTL, FAN ENGINE (PNEUMATIC ONLY)



PARTS CATALOG

FIGURE & ITEM NO.	MANUFACTURER'S PART NUMBER	NOMENCLATURE							EFF FROM TO	UNITS PER ASSY	
		1	2	3	4	5	6	7			
R R R R	13	65-11660-89	DRAIN INSTL, FAN ENGINE (PNEUMATIC ONLY) (SEE 71-1, . . . FIG. 5E, ITEM 53, 71-1, FIG. 5G, ITEM 48 AND 71-1, FIG. 5H, ITEM 41)							0150	RF
		65-11660-99	DRAIN INSTL, FAN ENGINE (PNEUMATIC ONLY) (SEE 71-1, . . . FIG. 5G, ITEM 48 AND 71-1, FIG. 5H, ITEM 41)							5199	RF
	4	65-11660-886	. TUBE ASSY, DRAIN 3/8 .028 6061-T6								1
		MS21921-6	. . . NUT								2
		BACS13AP6	. . . SLEEVE, (OPTIONAL MS21922-6).								2
	6	65-11660-63	. TUBE ASSY, DRAIN 1/2 .035 6061-T6								1
		MS21921-8	. . . NUT								2
		BACS13AP8	. . . SLEEVE, (OPTIONAL MS21922-8).								2
	7	MS21902D6	. UNION, (ENGINE NO. 1)								1
	7	MS21902D6	. UNION, (ENGINES NO. 2, 3 AND 4)								1
	10	MS21913D8	. PLUG, (ENGINE NO. 1).								1
	108	AN814-6L	. PLUG AND BLEEDER.								1
	13	MS21916D8-6	. REDUCER								1
	16	BACG10U6	. GASKET.								2
	19	3-86461-2	. SEAL, ENGINE COMBUSTION CHAMBER								1
	21	50-9588-2	. FITTING, RIGHT HAND SIDE FUEL AND HYDRAULIC DRAIN . . . ATTACHING PARTS								1
		NAS1103-2W	. BOLT.								2
		NAS679A3W	. NUT								2
22		DRAIN INSTL, FAN ENGINES NO. 2, 3 AND 4 (FOR REF SEE. . FIG. 13A) . FOR REFERENCE TO OTHER DRAIN DETAILS, SEE NHA								RF	

MISSING ITEM NUMBERS ARE NOT APPLICABLE

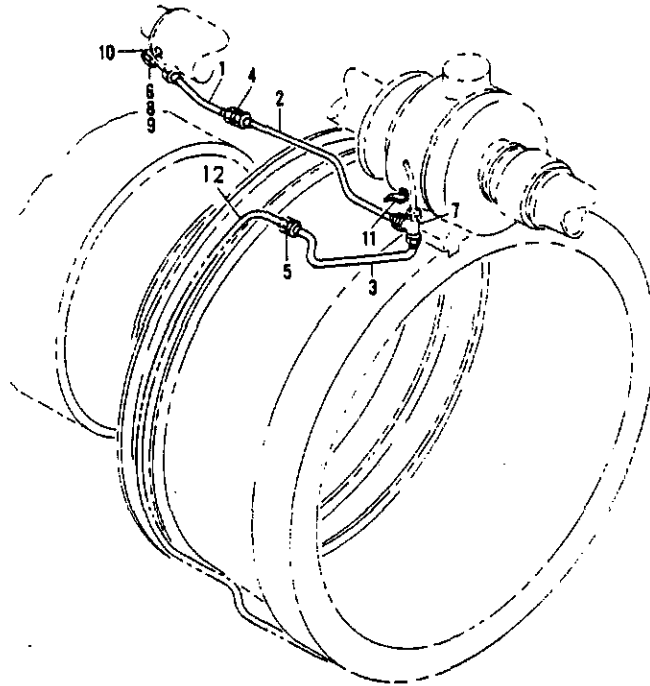
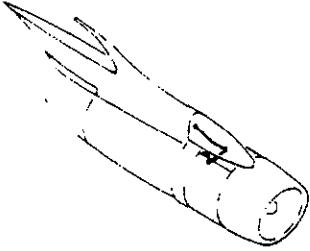

FIGURE 13A. DRAIN INSTL. FAN ENGINE NO. 2, 3 AND 4 (PNEUMATIC ONLY)
DRAIN INSTL. FAN ENGINE TURBOCOMPRESSOR ENGINE NO. 2, 3 AND 4

PARTS CATALOG

FIGURE & ITEM NO.	MANUFACTURER'S PART NUMBER	NOMENCLATURE							EFF FROM TO	UNITS PER ASSY
		1	2	3	4	5	6	7		
13A	65-11660-93	DRAIN INSTL, FAN ENGINE TURBOCOMPRESSOR (ENGINES NO. 2, 3 AND 4) (SEE 71-1, FIG. 5E, ITEM 55, 71-1, FIG. 5G, ITEM 50 AND 71-1, FIG. 5H, ITEM 43)								RF
1	65-11660-61	. TUBE ASSY, DRAIN 3/8 IN. .028 6061-T6 (ENGINES NO. 2 AND 3)								1
1	65-11660-61	. TUBE ASSY, DRAIN 3/8 IN. .028 6061-T6 (ENGINE NO. 4)								1
2	65-11660-802	. TUBE ASSY, DRAIN 3/8 IN. .028 6061-T6 (ENGINES NO. 2 AND 3)								1
2	65-11660-802	. TUBE ASSY, DRAIN 3/8 IN. .028 6061-T6 (ENGINE NO. 4)								1
	MS21921-6	. . NUT								2
	BACS13AP6	. . SLEEVE, (OPTIONAL MS21922-6).								2
3	65-11660-59	. TUBE ASSY, DRAIN 1/2 IN. .035 6061-T6 (ENGINES NO. 2 AND 3)								1
3	65-11660-59	. TUBE ASSY, DRAIN 1/2 IN. .035 6061-T6 (ENGINE NO. 4)								1
	MS21921-8	. . NUT								2
	BACS13AP8	. . SLEEVE, (OPTIONAL MS21922-8).								2
4	MS21902D6	. UNION, (ENGINES NO. 2 AND 3).								1
4	MS21902D6	. UNION, (ENGINE NO. 4)								1
5	MS21902D8	. UNION, (ENGINES NO. 2 AND 3).								1
5	MS21902D8	. UNION, (ENGINE NO. 4)								1
6	NAS551-6H	. BOLT, (ENGINES NO. 2 AND 3)								1
6	NAS551-6H	. BOLT, (ENGINE NO. 4)								1
7	BACT16H8D6	. TEE, (ENGINES NO. 2 AND 3).								1
7	BACT16H8D6	. TEE, (ENGINE NO. 4)								1
8	BACG10U6	. GASKET, (ENGINES NO. 2 AND 3)								1
8	BACG10U6	. GASKET, (ENGINE NO. 4)								1
9	BACG10T8	. GASKET, (ENGINES NO. 2 AND 3)								1
9	BACG10T8	. GASKET, (ENGINE NO. 4)								1
10	65-11660-808	. FITTING, FAN ENGINE DRAIN UNIVERSAL (ALTERED FROM NAS1238A6) (ENGINES NO. 2 AND 3)							0151	1
10	65-11660-100	. FITTING, FAN ENGINE DRAIN UNIVERSAL (ALTERED FROM NAS1238A6) (ENGINES NO. 2 AND 3)							5299	1
10	65-11660-808	. FITTING, FAN ENGINE DRAIN UNIVERSAL (ALTERED FROM NAS1238A6) (ENGINE NO. 4)							0151	1
10	65-11660-100	. FITTING, FAN ENGINE DRAIN UNIVERSAL (ALTERED FROM NAS1238A6) (ENGINE NO. 4)							5299	1
11	65-11660-801	. BRACKET, FAN ENGINE DRAIN (ENGINES NO. 2 AND 3)								1
11	65-11660-801	. BRACKET, FAN ENGINE DRAIN (ENGINE NO. 4)								1
12		DRAIN INSTL, FAN ENGINES NO. 2, 3 AND 4 (FOR REF SEE FIG. 13)								RF

R
R
R
R
R
R
R

MISSING ITEM NUMBERS ARE NOT APPLICABLE

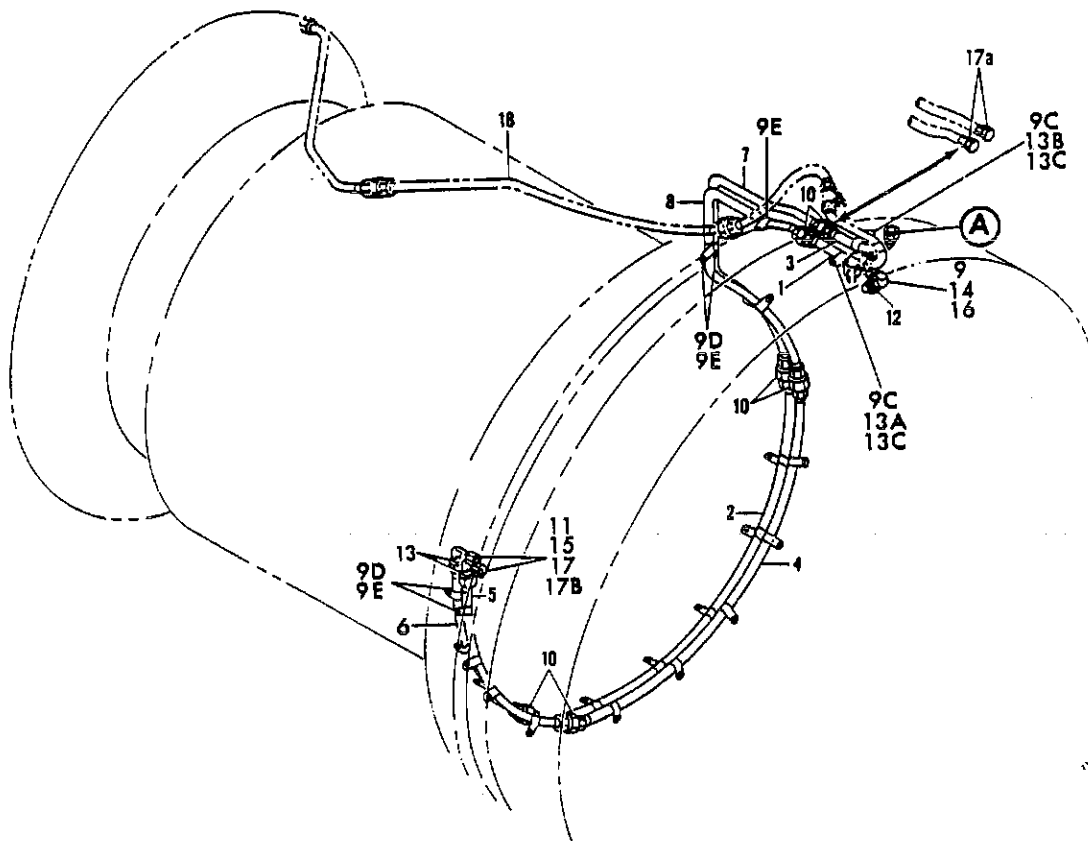
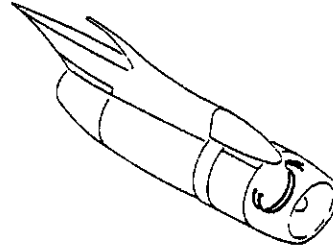
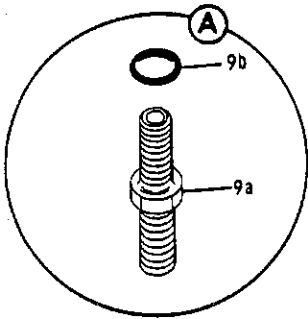

FIGURE 15. PLUMBING INSTL, FAN ENGINE TURBOCOMPRESSOR OIL COOLER AND SUPPLY (PNEUMATIC ONLY)



PARTS CATALOG

FIGURE & ITEM NO.	MANUFACTURER'S PART NUMBER	1 2 3 4 5 6 7	NOMENCLATURE	EFF	UNITS
				FROM TO	PER ASSY
15	65-61937-1		PLUMBING INSTL, ENGINE TURBOCOMPRESSOR OIL SUPPLY LINE (ENGINES NO. 2, 3 AND 4) (SEE 71-1, FIG. 5B, ITEM 35, 71-1, FIG. 5G, ITEM 38 AND 71-1, FIG. 5H, ITEM 33)		RF
1	65-11687-126		. TUBE ASSY, LUBRICATION OIL 1/2 IN. .035 AISI304 (OPTIONALS AISI321, AISI347) (ENGINES NO. 2, 3 AND 4)		1
2	65-11687-877		. TUBE ASSY, LUBRICATION OIL 1/2 .035 AISI304 (OPTIONALS AISI321, AISI347)		1
3	65-11687-876		. TUBE ASSY, LUBRICATION OIL 1/2 IN. .035 AISI304 (OPTIONALS AISI321, AISI347) (ENGINES NO. 2, 3 AND 4)		1
4	65-11687-127		. TUBE ASSY, LUBRICATION OIL 1/2 .035 AISI304 (OPTIONALS AISI321, AISI347)		1
5	65-11687-879		. TUBE ASSY, LUBRICATION OIL 1/2 .035 AISI304 (OPTIONALS AISI321, AISI347)		1
6	65-11687-878		. TUBE ASSY, LUBRICATION OIL 1/2 .035 AISI304 (OPTIONALS AISI321, AISI347)		1
7	65-61937-4		. TUBE ASSY, LUBRICATION OIL 1/2 IN. .035 AISI304		1
8	65-61937-5		. TUBE ASSY, LUBRICATION OIL 1/2 IN. .035 AISI304		1
	MS21921-8		. . . NUT		2
	MS21922-8		. . . SLEEVE		2
	BACS13AP8		. . . SLEEVE (OPTIONAL BACS13AP8)		2
9	MS21926-8		. . . SLEEVE (OPTIONAL TO MS21922-8)		1
9E	BACC10DDC8		. ELBOW, (ENGINES NO. 2, 3 AND 4)		23
10	MS21902-8		. CLAMP, (ENGINES NO. 2, 3 AND 4) (USED ON 65-61937-1)		6
11	ER833-1008		. UNION		2
12	AN6289-8		. REDUCER, (V88334)		1
13	AN6289-10		. NUT, (ENGINES NO. 2, 3 AND 4)		2
14	MS28777-8		. NUT		1
15	MS28777-10		. RING, (ENGINES NO. 2, 3 AND 4)		2
16	BACG10UB		. RING		1
17	BACG10U10-		. GASKET, (ENGINES NO. 2, 3 AND 4)		2
18			. GASKET		RF
			PLUMBING INSTL, FAN ENGINE TURBOCOMPRESSOR STATIC SENSING (FOR REF SEE FIG. 15A)		

MISSING ITEM NUMBERS ARE NOT APPLICABLE

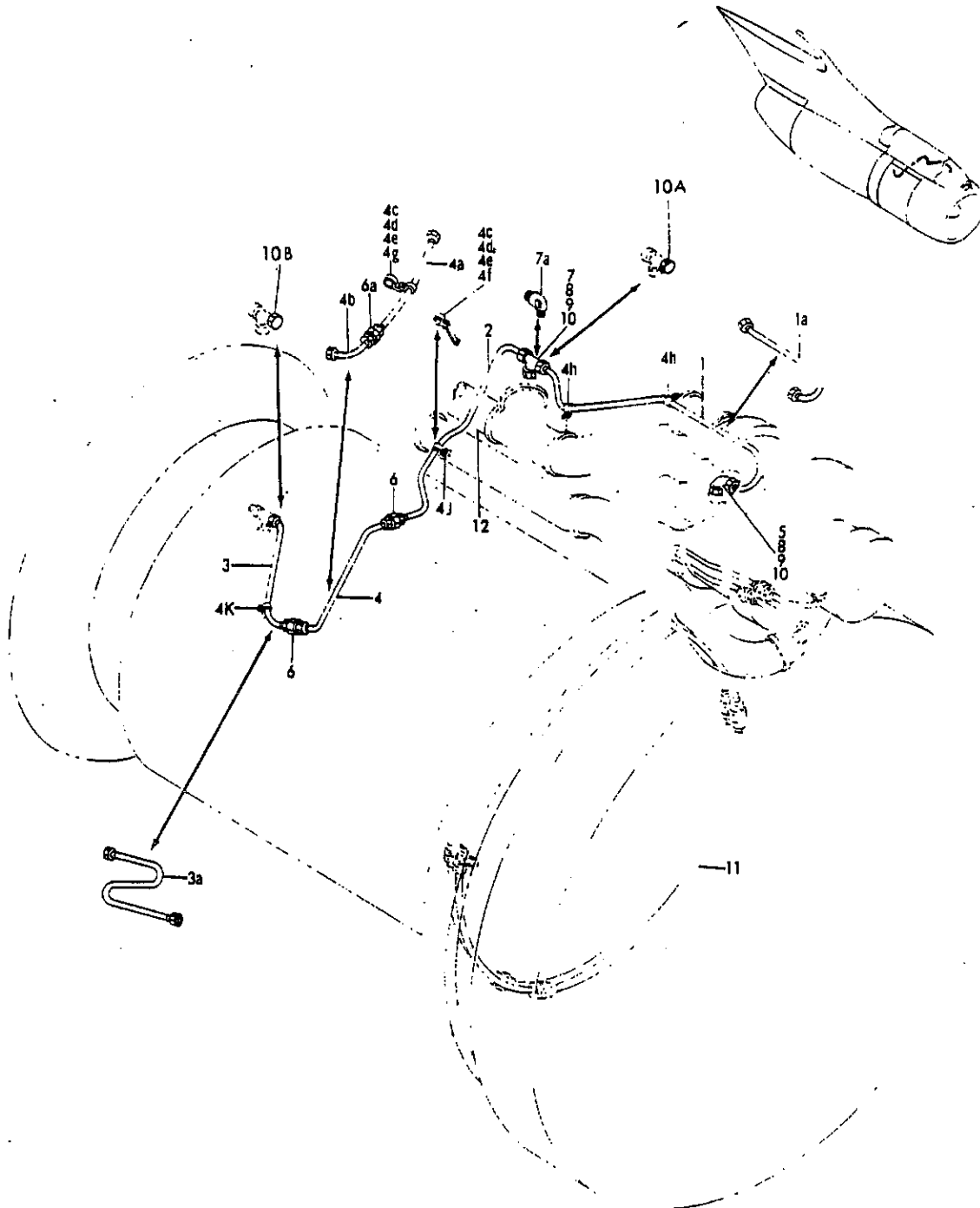

FIGURE 15A. PLUMBING INSTL, FAN ENGINES NO. 2 AND 3 (PNEUMATIC ONLY)



PARTS CATALOG

FIGURE & ITEM NO.	MANUFACTURER'S PART NUMBER	NOMENCLATURE							EFF FROM TO	UNITS PER ASSY	
		1	2	3	4	5	6	7			
R R R R R R R R R R R	15A	65-11687-227	PLUMBING INSTL, FAN ENGINE TURBOCOMPRESSOR STATIC . . .							0150	RF
			SENSING (ENGINES NO. 2, 3 AND 4) (SEE 71-1, FIG. 5E, ITEM 41, 71-1, FIG. 5G, ITEM 39 AND 71-1, FIG. 5H, ITEM 34)								
	1	65-11687-882	. TUBE ASSY, PRESSURE SENSING 3/8 IN. .028 AISI304. . .							0150	1
			(OPTIONALS AISI321, AISI347) (ENGINES NO. 2 AND 3)								
	1	65-11687-882	. TUBE ASSY, PRESSURE SENSING 3/8 IN. .028 AISI304. . .							0150	1
			(OPTIONALS AISI321, AISI347) (ENGINE NO. 4)								
	2	65-11687-883	. TUBE ASSY, PRESSURE SENSING 3/8 IN. .028 AISI304. . .							0150	1
			(OPTIONALS AISI321, AISI347) (ENGINES NO. 2 AND 3)								
	2	65-11687-883	. TUBE ASSY, PRESSURE SENSING 3/8 IN. .028 AISI304. . .							0150	1
			(OPTIONALS AISI321, AISI347) (ENGINE NO. 4)								
	3	65-11687-242	. TUBE ASSY, PRESSURE SENSING 3/8 IN. .028 AISI304. . .							0150	1
		(OPTIONALS AISI321, AISI347) (ENGINES NO. 2 AND 3)									
3	65-11687-242	. TUBE ASSY, PRESSURE SENSING 3/8 IN. .028 AISI304. . .							0150	1	
		(OPTIONALS AISI321, AISI347) (ENGINE NO. 4)									
4	65-11687-179	. TUBE ASSY, PRESSURE SENSING 3/8 IN. .028 AISI304. . .							0150	1	
		(OPTIONALS AISI321, AISI347) (ENGINES NO. 2 AND 3)									
4	65-11687-179	. TUBE ASSY, PRESSURE SENSING 3/8 IN. .028 AISI304. . .							0150	1	
		(OPTIONALS AISI321, AISI347) (ENGINE NO. 4)									
		MS21921-6	. . . NUT							0150	2
		MS21922-6	. . . SLEEVE, (OPTIONAL BACS13AP6).							0150	2
4H		BACC10DD6	. CLAMP, (ENGINES NO. 2 AND 3).							0150	2
4H		BACC10DD6	. CLAMP, (ENGINE NO. 4)							0150	2
5		MS21926-6	. ELBOW, (ENGINES NO. 2 AND 3).							0150	1
5		MS21926-6	. ELBOW, (ENGINE NO. 4)							0150	1
6		MS21902-6	. UNION, (ENGINES NO. 2 AND 3).							0150	2
6		MS21902-6	. UNION, (ENGINE NO. 4)							0150	2
7		C60W9000	. TEE, (V92003) (ENGINES NO. 2 AND 3)							0150	1
7		C60W9000	. TEE, (V92003) (ENGINE NO. 4).							0150	1
8		AN6289-6	. NUT, (ENGINES NO. 2 AND 3).							0150	2
8		AN6289-6	. NUT, (ENGINE NO. 4)							0150	2
9		MS28777-6	. RING, (ENGINES NO. 2 AND 3)							0150	2
9		MS28777-6	. RING, (ENGINE NO. 4).							0150	2
10		BACG10U6	. GASKET, (ENGINES NO. 2 AND 3)							0150	2
10		BACG10U6	. GASKET, (ENGINE NO. 4).							0150	2
			. FOR REFERENCE TO OTHER PLUMBING DETAILS, SEE NHA.							0150	
11			PLUMBING INSTL, FAN ENGINE TURBOCOMPRESSOR OIL SUPPLY							0150	RF
			(FOR REF SEE FIG. 15)								

MISSING ITEM NUMBERS ARE NOT APPLICABLE

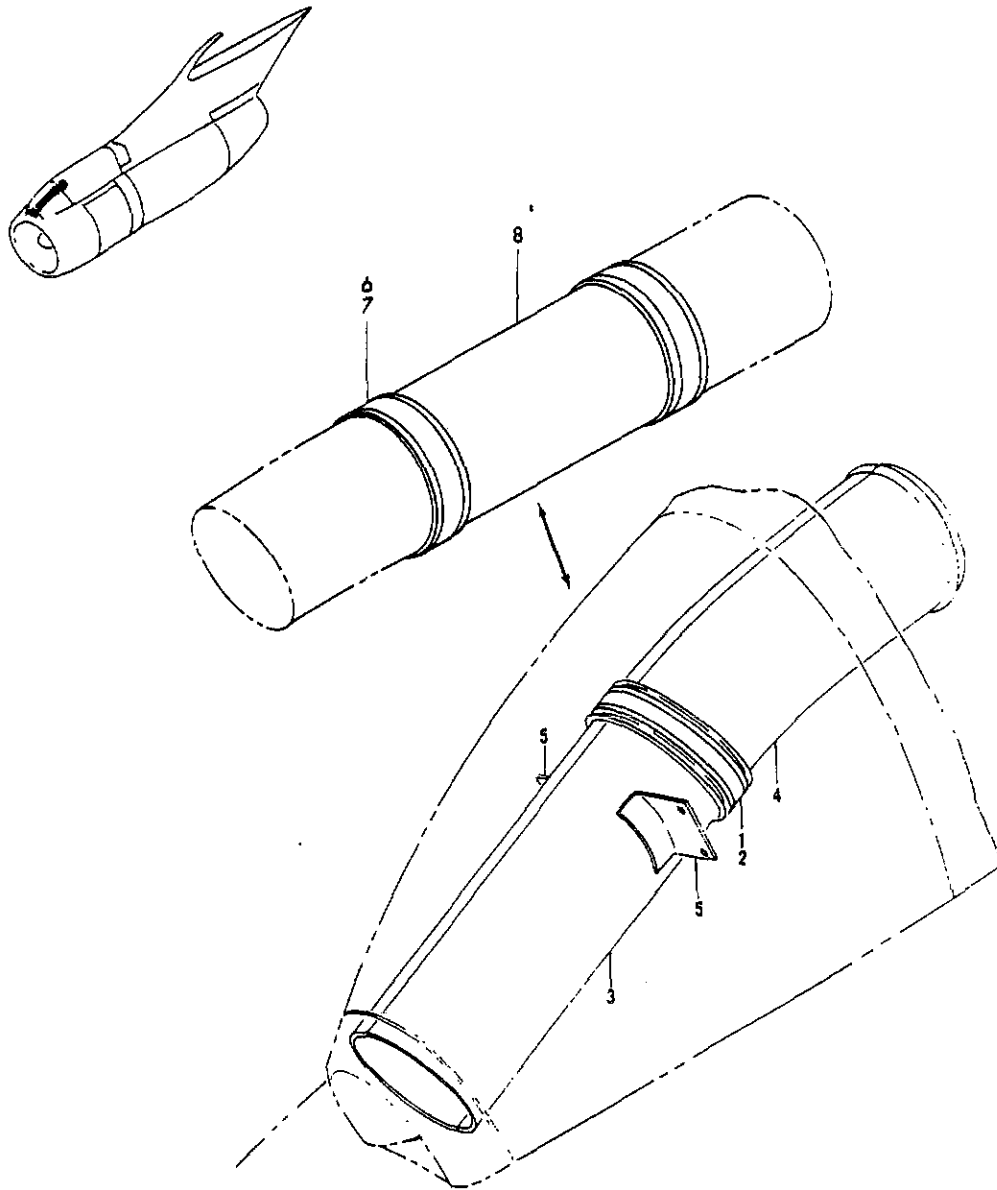

FIGURE 16. FAIRING ASSY, TURBOCOMPRESSOR INLET (ENGINES NO. 2, 3 AND 4) (PNEUMATIC ONLY)



PARTS CATALOG

FIGURE & ITEM NO.	MANUFACTURER'S PART NUMBER	NOMENCLATURE							EFF FROM TO	UNITS PER ASSY
		1	2	3	4	5	6	7		
16	65-10607-38	FAIRING ASSY, TURBOCOMPRESSOR INLET (ENGINES NO. 2, 3 AND 4) (PNEUMATIC ONLY) (SEE 71-2, FIG. 2, ITEM 2)								RF
1	BACC10AJ550	• CLAMP								1
2	BACS13J550	• SLEEVE								1
3	65-10607-32	• DUCT ASSY, TURBOCOMPRESSOR INLET FAIRING.								1
4	65-10607-875	• DUCT ASSY, TURBOCOMPRESSOR INLET FAIRING.								1
5	65-10607-36	• CLIP, TURBOCOMPRESSOR INLET FAIRING								2
		• FOR REFERENCE TO OTHER FAIRING DETAILS, SEE NHA								
MISSING ITEM NUMBERS ARE NOT APPLICABLE										

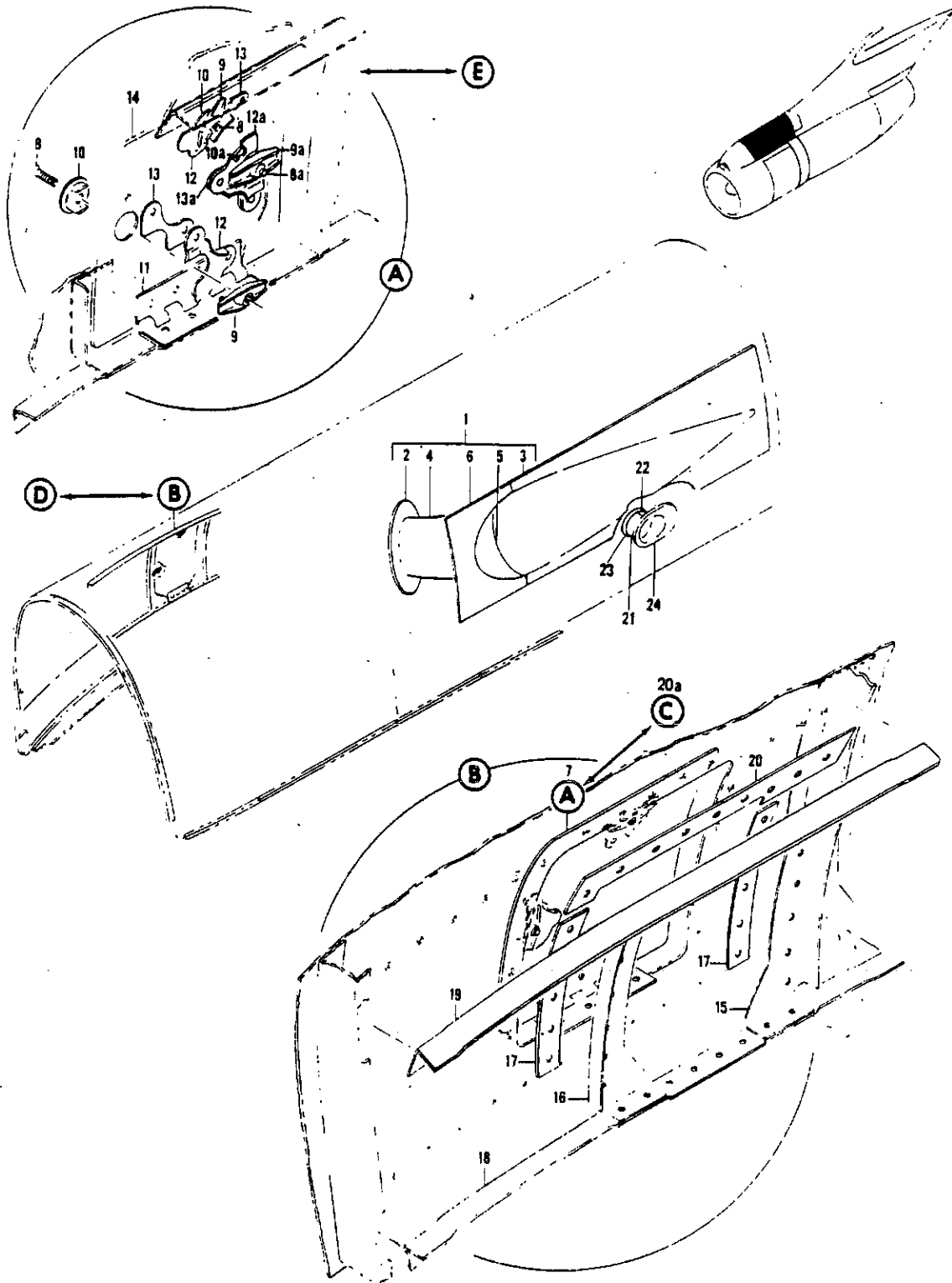

FIGURE 17. FAIRING ASSY, NACELLE TURBO COMPRESSOR FORWARD (PNEUMATIC ONLY) (SHEET 1)

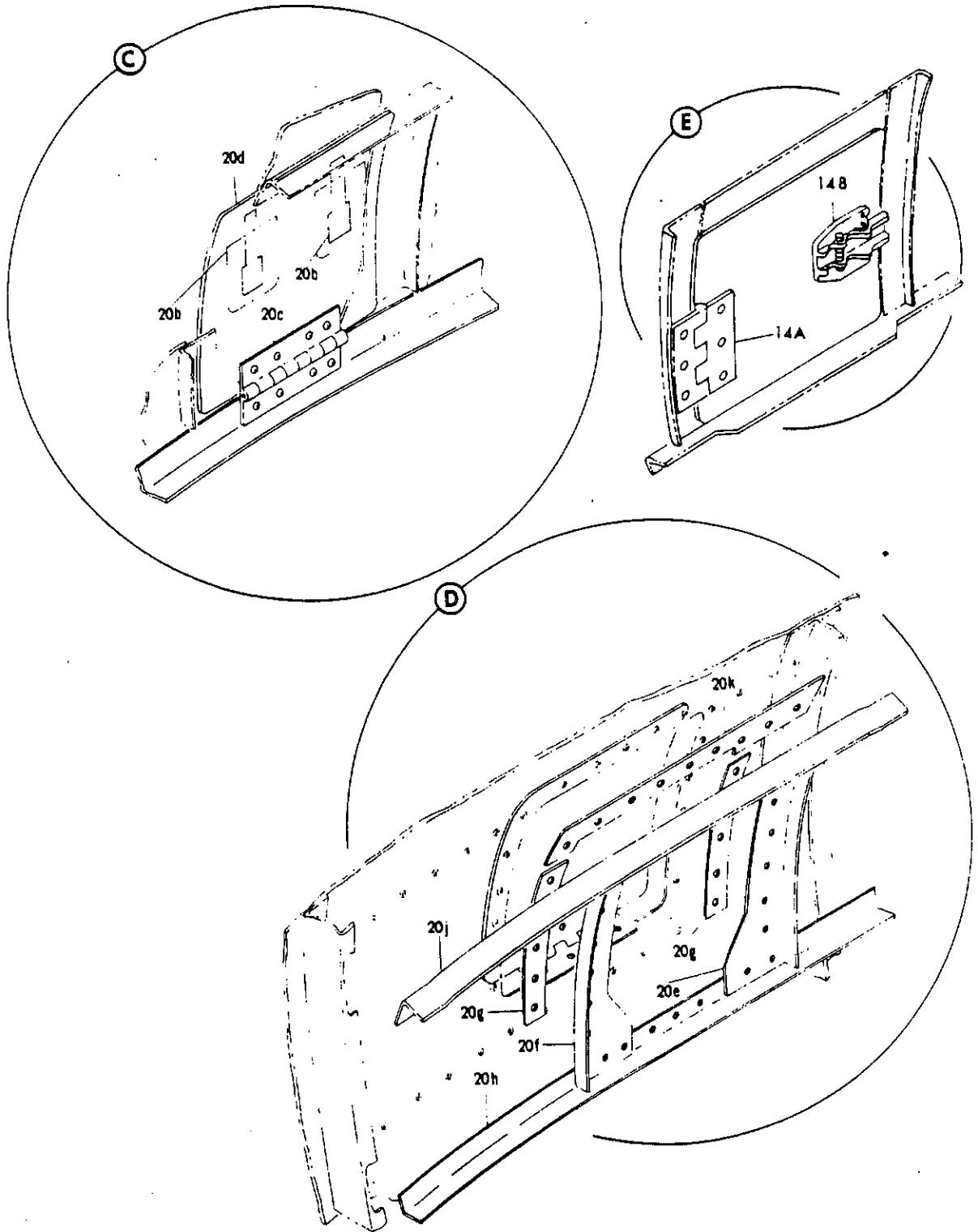

FIGURE 17. FAIRING ASSY, NACELLE TURBO COMPRESSOR FORWARD (PNEUMATIC ONLY) (SHEET 2)



PARTS CATALOG

FIGURE & ITEM NO.	MANUFACTURER'S PART NUMBER	NOMENCLATURE							EFF FROM TO	UNITS PER ASSY	
		1	2	3	4	5	6	7			
R R R R R	17	65-11645-161	FAIRING ASSY, NACELLE TURBOCOMPRESSOR FORWARD (ENGINES NO. 2, 3 AND 4) (PNEUMATIC ONLY) (SEE 71-2, FIG. 2, ITEM 3)							0150	RF
		65-11645-182	FAIRING ASSY, NACELLE TURBOCOMPRESSOR FORWARD (ENGINES NO. 2, 3 AND 4) (PNEUMATIC ONLY) (SEE 71-2, FIG. 2, ITEM 3)							5199	RF
	1	65-15966	. DUCT ASSY, FAN ENGINE TURBOCOMPRESSOR EXHAUST WELDED								1
	2	65-15966-5	. . . FLANGE, FAN ENGINE TURBOCOMPRESSOR EXHAUST WELDED . DUCT SEAL								1
	3	65-15966-4	. . . FLANGE, FAN ENGINE TURBOCOMPRESSOR EXHAUST WELDED . DUCT AFT SKIN								1
	4	65-15966-2	. . . DUCT HALF, FAN ENGINE TURBOCOMPRESSOR EXHAUST . . . WELDED LOWER								1
	5	65-15966-1	. . . DUCT HALF, FAN ENGINE TURBOCOMPRESSOR EXHAUST . . . WELDED UPPER								1
	6	65-15966-3	. . . FLANGE, FAN ENGINE TURBOCOMPRESSOR EXHAUST WELDED . DUCT FORWARD SKIN								1
	7	65-12777	. DOOR INSTL, TURBOCOMPRESSOR DIPSTICK ACCESS								1
	8	65-12777-11	. . . DOOR ASSY, TURBOCOMPRESSOR DIPSTICK ACCESS.								1
	8A	NAS514P428-8	. . . SCREW								2
	9	NAS514P428-8	. . . SCREW								1
	9A	66-10344-1	. . . NUT, NACELLE ACCESS DOOR ROTARY LATCH								2
	10	66-10344-1	. . . NUT, NACELLE ACCESS DOOR ROTARY LATCH								1
	10A	63-9651	. . . INDICATOR, NACELLE ROTARY LATCH								2
	11	63-9651	. . . INDICATOR, NACELLE ACCESS DOOR ROTARY LATCH								1
R		65-12777-800	. . . HINGE, TURBOCOMPRESSOR DIPSTICK ACCESS (ALTERED . FROM AN257-5-250)							5199	1
	12	66-25039	. . . BLOCK, NACELLE ACCESS DOOR ROTARY LATCH ANCHOR.								2
	12A	66-25039	. . . BLOCK, NACELLE ACCESS DOOR ROTARY LATCH ANCHOR.								1
	13	66-25040-1	. . . PLATE, NACELLE ACCESS DOOR ROTARY LATCH SHIM.								2
	13A	66-25040-1	. . . PLATE, NACELLE ACCESS DOOR ROTARY LATCH SHIM.								1
	14	65-12777-12	. . . SKIN, TURBOCOMPRESSOR DIPSTICK ACCESS DOOR.								1
	15	65-12777-5	. . . ANGLE								1
	16	65-12777-6	. . . ANGLE								1
	17	65-12777-8	. . . SHIM.								2
	18	65-12777-801	. . . INTERCOSTAL								1
	19	65-12777-4	. . . INTERCOSTAL								1
	20	65-12777-7	. . . SHIM.								1
R	20L	65-11645-5	. ANGLE, FRAME.							0150	1
	21	69-11107-2	. RING, SURGE BLEED SEAL RETAINER HALF.								1
	22	69-11107-1	. RING, SURGE BLEED SEAL RETAINER HALF.								1
			ATTACHING PARTS								
		NAS600-5	. SCREW								8
		NAS679A04W	. NUT								8
	23	66-10768	. SEAL, TURBOCOMPRESSOR SURGE BLEED EXHAUST RUBBER.								1
	24	69-10949	. OUTLET, TURBOCOMPRESSOR SURGE BLEED								1
			. FOR REFERENCE TO OTHER FAIRING DETAILS SEE NHA.								

MISSING ITEM NUMBERS ARE NOT APPLICABLE

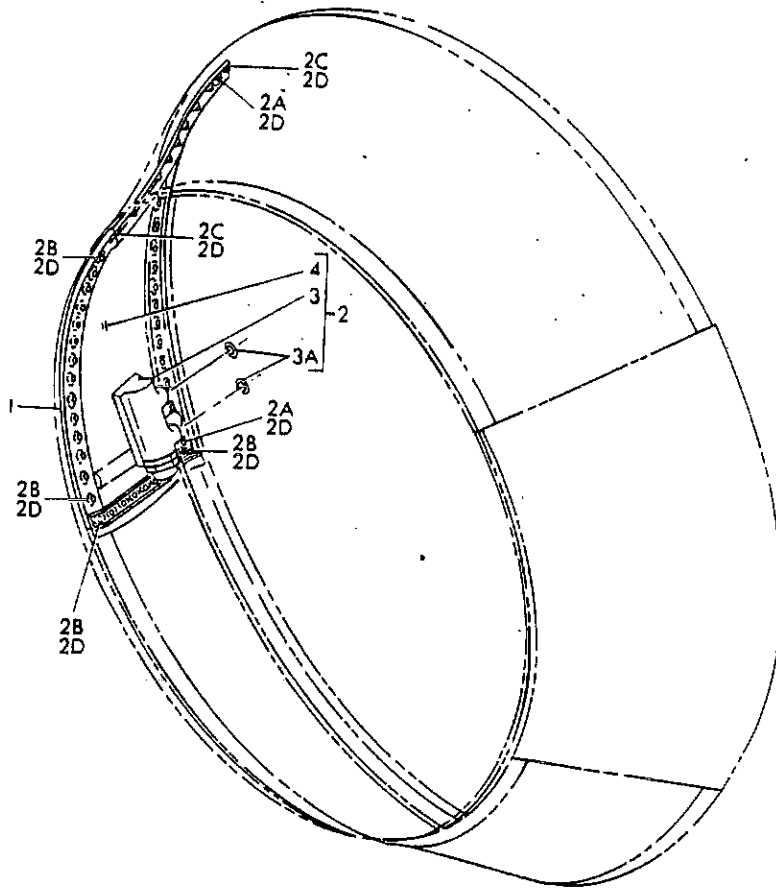
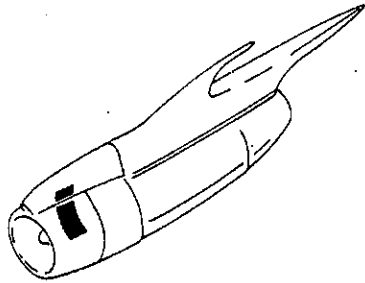

PANEL INSTL. TURBOCOMPRESSOR OIL COOLER
 FIGURE 18. COOLER INSTL. TURBOCOMPRESSOR



PARTS CATALOG

FIGURE & ITEM NO.	MANUFACTURER'S PART NUMBER	NOMENCLATURE							EFF FROM TO	UNITS PER ASSY
		1	2	3	4	5	6	7		
18	65-11657-1	PANEL INSTL, TURBOCOMPRESSOR OIL COOLER (ENGINE NO. 1) (SEE 71-1, FIG. 5, ITEM 19, 71-1, FIG. 5B, ITEM 52, 71-1, FIG. 5E, ITEM 66, 71-1, FIG. 5G, ITEM 61 AND 71-1, FIG. 5H, ITEM 52)								RF
R	65-11657	COOLER INSTL, TURBOCOMPRESSOR OIL (ENGINES NO. 2, 3 AND 4) (SEE 71-1, FIG. 5, ITEM 19, 71-1, FIG. 5B, ITEM 52, 71-1, FIG. 5E, ITEM 66, 71-1, FIG. 5G, ITEM 61 AND 71-1, FIG. 5H, ITEM 52)							0150	RF
R	65-11657-4	COOLER INSTL, TURBOCOMPRESSOR OIL (ENGINES NO. 2, 3 AND 4) (SEE 71-7, FIG. 5B, ITEM 52, 71-1, FIG. 5G, ITEM 61 AND 71-1, FIG. 5H, ITEM 52)							5199	RF
R	1 65-11657-2	. PANEL, TURBOCOMPRESSOR OIL COOLER (ENGINE NO. 1) . . .								1
R	2 10-60405	. COOLER ASSY, SURFACE TYPE (ENGINES NO. 2, 3 AND 4) . . .							0150	1
R	2 10-60405-10	. COOLER ASSY, SURFACE OIL TYPE (ENGINES NO. 2, 3 AND 4)							5199	1
		ATTACHING PARTS								
R	2A NAS517-3-5	. SCREW, (ENGINE NO. 1)								18
R	2A NAS517-3-5	. SCREW, (ENGINE NO. 4)							0150	18
R	2A BACB30LH3-5	. BOLT							5199	18
R	2A NAS517-3-5	. SCREW, (ENGINES NO. 2 AND 3)							0150	18
R	2B NAS517-4-5	. SCREW, (ENGINE NO. 1)								24
R	2B NAS517-4-5	. SCREW, (ENGINE NO. 4)							0150	24
R	2B NAS517-4-5	. SCREW, (ENGINES NO. 2 AND 3)							0150	24
R	2B BACB30LH4-5	. BOLT							5199	24
R	2C NAS517-4-3	. SCREW, (ENGINE NO. 1)								10
R	2C NAS517-4-3	. SCREW, (ENGINE NO. 4)							0150	10
R	2C BACB30LH4-3	. BOLT, (ENGINES NO. 2 AND 3)							5199	10
R	2C NAS517-4-3	. SCREW, (ENGINES NO. 2 AND 3)							0150	10
R	3 10-60405-2	. . VALVE, (ENGINE NO. 4) (USED ON BAC SPEC NO. 10-60405)							0150	1
R	3 10-60405-2	. . VALVE, (ENGINES NO. 2 AND 3) (USED ON BAC SPEC NO. 10-60405)							0150	1
R	3 10-60405-15	. . VALVE, (ENGINE NO. 4) (USED ON BAC SPEC NO. 10-60405-10)							5199	1
R	3 10-60405-15	. . VALVE, (ENGINES NO. 2 AND 3) (USED ON BAC SPEC NO. 10-60405-10)							5199	1
R	4 10-60405-1	. . CORE, (ENGINE NO. 4) (USED ON BAC SPEC NO. 10-60405)							0150	1
R	4 10-60405-1	. . CORE, (ENGINES NO. 2 AND 3) (USED ON BAC SPEC NO. 10-60405)							0150	1
R	4 10-60405-12	. . CORE, (ENGINE NO. 4) (USED ON BAC SPEC NO. 10-60405-10)							5199	1
R	4 10-60405-12	. . CORE, (ENGINES NO. 2 AND 3) (USED ON BAC SPEC NO. 10-60405-10)							5199	1

MISSING ITEM NUMBERS ARE NOT APPLICABLE

BOEING *707* *Intercontinental* 
PARTS CATALOG

SECTION 04
MISCELLANEOUS

STA
600

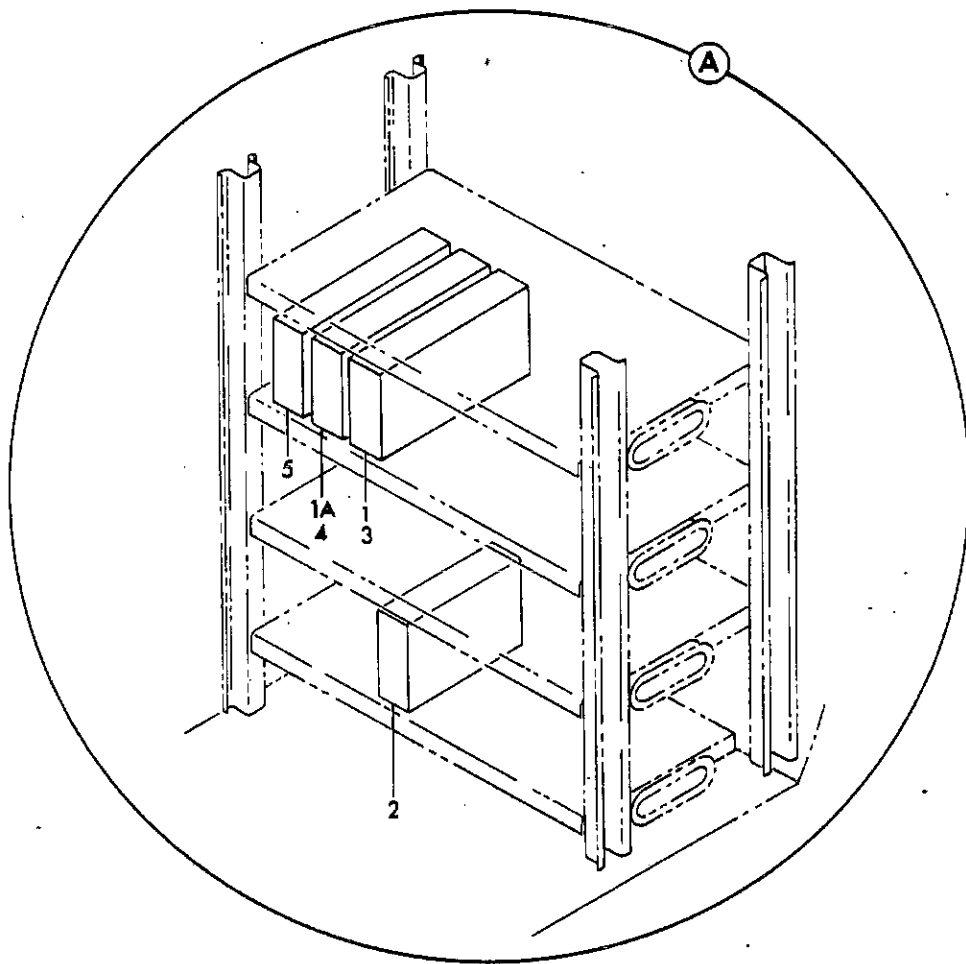
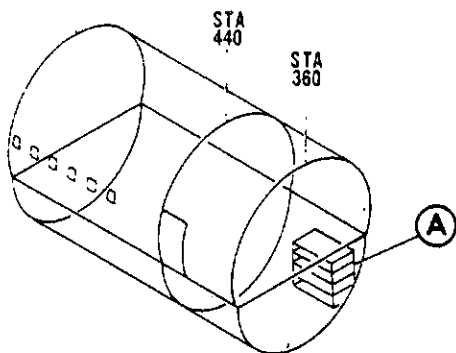

36-4-1 707/300 R 260

FIGURE 1. EQUIPMENT INSTL, ELECTRONIC RACK (AIR CONDITIONING ONLY)



PARTS CATALOG

FIGURE & ITEM NO.	MANUFACTURER'S PART NUMBER	NOMENCLATURE 1 2 3 4 5 6 7	EFF FROM TO	UNITS PER ASSY
1	65-1343-205	EQUIPMENT INSTL, LH ELECTRONIC RACK (PNEUMATIC ONLY). (SEE 24-3, FIG. 6B, ITEM 9A AND 24-3, FIG. 6F, ITEM 9)	5199	RF
1	10-61412-11	. CONTROL, CABIN AIR PRESSURE	5199	1
		. FOR REFERENCE TO OTHER EQUIPMENT DETAILS, SEE NHA . . .	5199	

MISSING ITEM NUMBERS ARE NOT APPLICABLE

BOEING
707
PARTS CATALOG (MAINTENANCE)

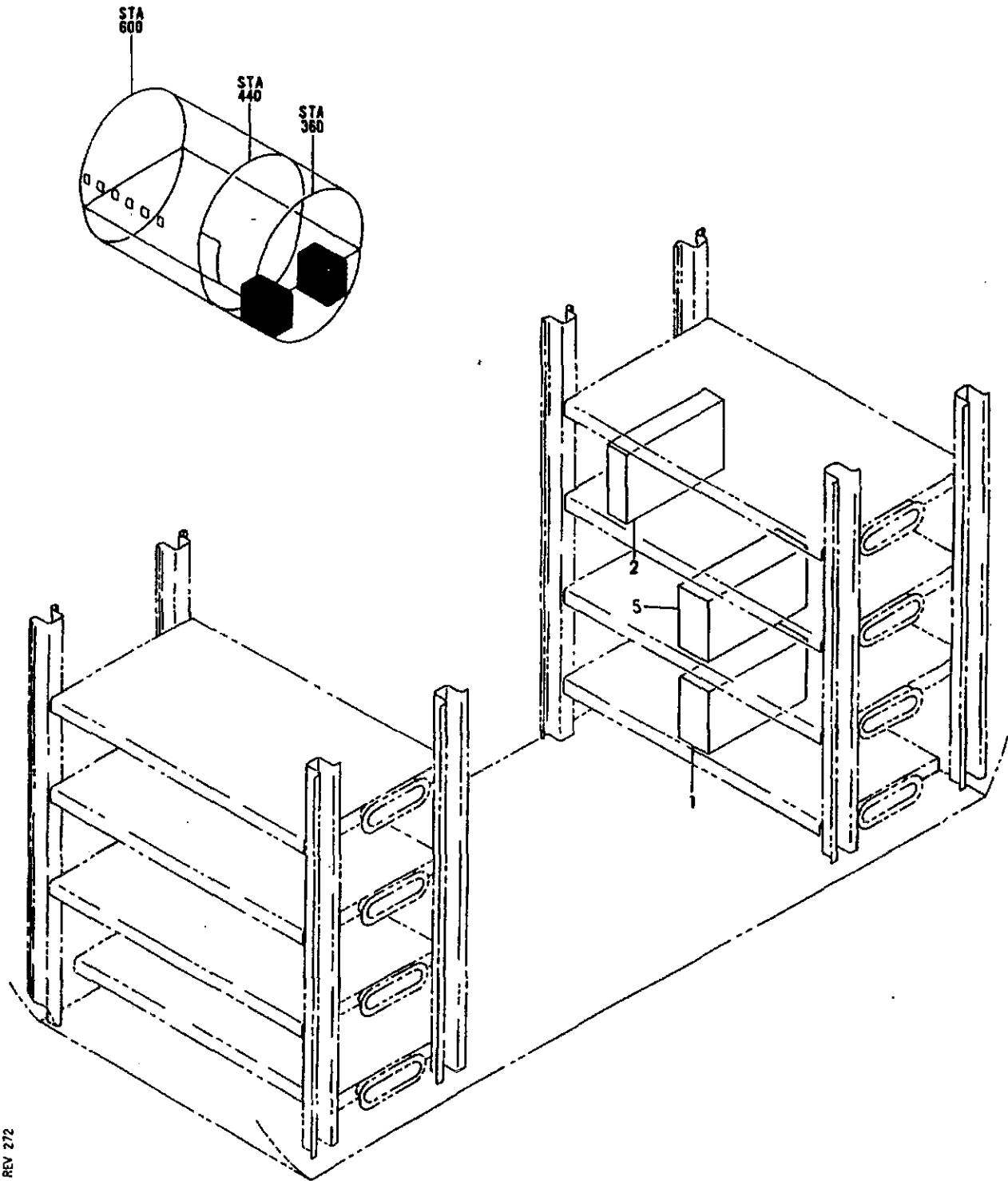

A 3604002 REV 272

FIGURE 2. EQUIPMENT INSTL. ELECTRONIC RACK (PNEUMATIC ONLY)

DETAILED PARTS LIST
36-04-2
PAGE 0

36-04-2

NOV 21/01

BOEING

707

PARTS CATALOG (MAINTENANCE)

FIGURE & ITEM NO.	MANUFACTURER'S PART NUMBER	NOMENCLATURE							EFF FROM TO	UNITS PER ASSY	
		1	2	3	4	5	6	7			
R R R R R R R R R	2	65-1343-87	EQUIPMENT INSTL, ELECTRONIC RACK (PNEUMATIC ONLY) . . .							0150	RF
			(DELETED BY RAF MOD 7211.019-4) (SEE 24-3, FIG. 6D, ITEM 11)								
		351-25-50-74125-001	EQUIPMENT INSTL, RACK LOWER SECTION 41 (PNEUMATIC . . .							0450	RF
			ONLY) (VZ0031) (ADDED BY RAF MOD 7211.019-4) (SEE 24-3, FIG. 6D, ITEM 11)								
		351-25-50-74125-003	EQUIPMENT INSTL, RACK LOWER SECTION 41 (PNEUMATIC . . .							0101	RF
			ONLY) (VZ0031) (ADDED BY RAF MOD 7211.019-4) (SEE 24-3, FIG. 6D, ITEM 11)								
		351-25-50-74125-005	EQUIPMENT INSTL, RACK LOWER SECTION 41 (PNEUMATIC . . .							0203	RF
			ONLY) (VZ0031) (ADDED BY RAF MOD 7211.019-4) (SEE 24-3, FIG. 6D, ITEM 11)								
	1	10-61412-9	. CONTROL, CABIN AIR PRESSURE (DELETED BY SB 3343) . . .							0150	1
	1	10-61412-17	. CONTROL, CABIN AIR PRESSURE (ADDED BY SB 3343) . . .							0150	1
R R	5	10-6412-9	. CONTROL, CABIN AIR PRESSURE (VS2500) (USED ON . . .							0150	1
			351-25-50-74125-001, 351-25-50-74125-003 AND 351-25-50-74125-005)								
			. FOR REFERNECE TO OTHER EQUIPMENT DETAILS, SEE NHA . .							0150	

MISSING ITEM NUMBERS ARE NOT APPLICABLE