

707

STUDENT TRAINING OVERHAUL MANUAL (UNCONTROLLED - USE ON LIVE AIRCRAFT PROHIBITED)

INTRODUCTION

TABLE OF CONTENTS

Subject	Page
Purpose	2
General	3
Instruction For Use of Catalog	7
Airplane Numbers	16
Airplane Sectional Breakdown	27
Airplane Station Diagrams	28
Major Drawing Number Index	39
Filter Kits	50

STUDENT TRAINING OVERHAUL MANUAL
(UNCONTROLLED - USE ON LIVE AIRCRAFT PROHIBITED)

I N T R O D U C T I O N

PURPOSE

This document has been prepared and issued by Boeing for the exclusive use of its customers and is intended for use in provisioning, requisitioning, storing and issuing replaceable aircraft parts and units and in identifying parts. The contents are proprietary to Boeing and its customers and are subject to change. The use of any part of this document by any other person or persons or for any other purpose without the prior written consent of Boeing is expressly prohibited. In addition, Boeing expressly disclaims any and all responsibility arising from or in any way related to any such use without Boeing's prior written consent thereto. This document is produced to reflect the configuration of the aircraft at the time of delivery to the original customer, and does not necessarily reflect the current configuration of any specific aircraft.

R The part number content, associated data elements, functional
R arrangement and breakdown sequence of items contained within this
R document is produced in accordance with the Air Transport
R Association (ATA) Specification No. 100.

R For additional information or to acquire a copy of the Air
R Transport Association (ATA) Specification No. 100, please contact
R the following for ordering information:

R Phone: Continental U.S. and Canada: 1-800-497-3326
R International: 301-490-7951

EXPLANATION OF CUSTOMIZING

This Illustrated Parts Catalog has been designed to include only those part numbers applicable to a specific customer. In order to accomplish this on an economical basis certain deviations have been made.

Illustrations may contain item numbers which are not applicable to the specific customer for which the catalog was made. However, the parts list will not show these nonapplicable items and, therefore, will not necessarily contain consecutive item numbers. The note at the bottom of each partslist page "Missing Item Numbers Are Not Applicable" is to avoid concern over item numbers not shown in the parts list.

STUDENT TRAINING OVERHAUL MANUAL
(UNCONTROLLED - USE ON LIVE AIRCRAFT PROHIBITED)

EXPLANATION OF CUSTOMIZING (CONT)

The Specification Cross Reference Index is common to all customers.

The Detailed Parts List will contain cross-reference figure numbers which do not always apply to a specific customer. For example, a figure reference may say "see fig. 1, 2, 3, and 4" with each figure applying to a different customer. However, if only figure 4 applies to the specific customer, only that figure will be found in the catalog.

All pages which apply to a specific customer will carry the Air Transport Association - approved airline designation above the date shown on each page.

A page numbering system is used which permits the assignment of page numbers by Electronic Data Processing Machines. In the Detailed Parts List each figure contains its own page numbering system beginning with Zero (0). The Chapter-Section identification also includes the figure number. Any parts list change to a figure will generally cause issuance of only those parts list pages affected by the change.

EFFECTIVITY

For an explanation of effectivity codes see Instructions for Use of Catalog, Notes 20, 21 and 22 page 11 and 12.

GENERAL SYSTEM OF ASSEMBLY ORDER

The indention system used in the illustrated parts breakdown of this catalog shows the relationship of one part to another. For a given item, the indention code shows a system, installation or general heading starting in the extreme left position continuing on down into succeeding columns until the end detail is reached, as follows:

1	2	3	4	5	6	7
Installation						
	Detail Parts for Installation					
	Assembly					
	Attaching Parts for Assembly					
		Detail Parts for Assembly				
		Sub-Assembly				
		Attaching Parts for Sub-Assembly				
			Detail Parts for Sub-Assembly			
			Sub-Sub Assembly			
			Attaching Parts for Sub-Sub Assembly			
				Detail Parts for Sub-Sub Assembly		

STUDENT TRAINING OVERHAUL MANUAL
(UNCONTROLLED - USE ON LIVE AIRCRAFT PROHIBITED)

CROSS INDEX SYSTEMS

The Specification Cross Reference index is for the purpose of finding the vendor part number applicable to any Boeing specification number applicable to any vendor part number. The first part of this index is titled "Specification Numbers Sequence" and list the Boeing specification numbers in numerical order with their corresponding vendor part numbers and vendor codes. The second part of this index is titled "Vendor Numbers Sequence" and lists the vendor part numbers in numerical order with their vendor codes and corresponding Boeing specification numbers.

R The Vendors' Code Names and Addresses Index is a listing of vendors
R referenced in the DPL. The list is arranged in vendor code number
R sequence. Entries followed by a "B" indicate a Boeing assigned code
R for those vendors not yet assigned a Federal or NATO Supply Code.
R Entries preceded by a "V" indicate that the code has been selected
R from the "Federal Manufacturer's Code catalog H4-1, H4-2 and H4-3".
R When Federal Supply Code and a NATO Supply Code Catalog are assigned
R to a manufacturer, only the NATO supply Code will be shown. These
R catalogs can be procured from: Superintendent of Documents, U.S.
R Government, Printing Office, Washington, D.C., 20402.

R The identification of suppliers and their respective code are provided
R with ATA Specification 100 and the World Airlines Suppliers Guide.

R THE IDENTIFICATION OF AND/OR REFERENCE TO SUPPLIERS IN THIS DOCUMENT
R IS NOT AN ENDORSEMENT OF THEIR PRODUCTS, AND IS NOT TO BE CONSIDERED
R AS BOEING'S PERMISSION FOR DIRECT SHIP AUTHORIZATION. THE SUPPLIERS
R LISTED MAY OR MAY NOT HAVE THE NECESSARY REGULATORY APPROVAL(S)
R INCLUDING, BUT NOT LIMITED TO, FEDERAL AVIATION ADMINISTRATION
R (FAA) PARTS MANUFACTURER APPROVAL (PMA) FOR THE SPECIFIC PART NUMBERS
R REFERENCED HEREIN. EVIDENCE OF APPROPRIATE REGULATORY COMPLIANCE
R SHOULD BE OBTAINED DIRECTLY FROM THE AFFECTED SUPPLIER.

The Numerical Index is subdivided into two sections. All alphabetical part numbers are found in the section labeled "Numerical Index-Alpha." All numerical part numbers are found in the section labeled "Numerical Index-Numeric." All parts within these sections are arranged alphabetically-numerically, referring to the chapter, section, figure and item number in the Detailed Parts List where each part number appears. The numerical index of each customized catalog reflects only the part numbers appearing in the DPL of that catalog.

707

STUDENT TRAINING OVERHAUL MANUAL (UNCONTROLLED - USE ON LIVE AIRCRAFT PROHIBITED)

CROSS INDEX SYSTEMS (CONT)

The Numerical Index also displays substitution information on interchangeable standard part numbers as follows:

MANUFACTURER'S PART NUMBER	AIRLINE STOCK NUMBER	CHAP NO.	FIGURE & ITEM NO.	REQ. PER A C
BACB10B246		27-20	12 - 47	1
REPLACED BY BACB10BP06P				
BACB10B248		52-60	5 - 19	2
REPLACED BY BACB10BP08P				
		52-60	5B- 19	2
BACB10B257R		32-80	2 - 21	1
REPLACED BY BACB10BN06P				
		32-70	2 - 39	1
		32-70	2A- 25	1

This information provides identification of additional items to support a specific usage and in no way implies a mandatory replacement. For example, this information may be used to assist and inventory stockage program. Additional details on standard part numbers are contained in BAC Standards Document D-590.

The Filter Maintenance Kit Listing identifies kits to support the maintenance of filter assemblies installed throughout the aircraft. This listing includes the kit part number, the part number and description of the unit supported by the kit and the component parts included in the kit. These kits may be ordered from Boeing.

In the Detailed Parts List cross-reference by figure and item number indicates where the installation or assembly is listed under its next higher assembly. Cross-reference by figure number only indicates the figure in which the installation or assembly is broken down into its component parts. Cross-references to figures in different sections or chapters carry the chapter-section numbers as well as the figure numbers.

707

STUDENT TRAINING OVERHAUL MANUAL (UNCONTROLLED - USE ON LIVE AIRCRAFT PROHIBITED)

MANUFACTURER'S PART NUMBERING SYSTEM

The digit or digits preceding the first dash number indicate the drawing size.

The numerals immediately following the dash are assigned from blocks of four, five, and six digits in chronological sequence, and have no special significance. The numbers immediately following the second dash denote construction or design variations, identify a particular installation, assembly, or detail part of the basic drawing.

This position is filled with a dash for engineering release. Replace the dash with a "U" for procurement of the part with pilot holes omitted at the attaching fastener locations.

STUDENT TRAINING OVERHAUL MANUAL (UNCONTROLLED - USE ON LIVE AIRCRAFT PROHIBITED)

INSTRUCTIONS FOR USE OF CATALOG

BB310 707
PARTS CATALOG

MANUFACTURER'S PART NUMBER	ALIN STOCK NUMBER	CHAP NO	FIGURE & ITEM NO	REQ PER A.C.	MANUFACTURER'S PART NUMBER	AIRLINE STOCK NUMBER	CHAP NO	FIGURE & ITEM NO	REQ PER A.C.
65-4741-3	52-04	12	1	2	65-4882-138A		25-17	14-4	1
65-4741-6	52-04	12	2	2	65-4882-138B		52-04	8-23	1
	52-04	12	3	2	65-4882-140		52-04	8-10	1
	52-04	12	4	2	65-4882-29		52-04	8-15	1
	52-04	12	5	2	65-4882-31		52-04	8-138	1
	52-04	12	6	2	65-4882-70		52-04	8-15	1
	52-04	12	7	2	65-4882-73		52-04	8-15A	1

BB310 707
PARTS CATALOG

FIGURE & ITEM NO	MANUFACTURER'S PART NUMBER	NOMENCLATURE	REQ PER TO	UNITS PROM TO ASSY
1	65-4741-27E	DOOR ASSY, TOILET A (DOORS ONLY) (SEE 25-17, FIG. 69, ITEM 1) AND 25-17, FIG. 91, ITEM 3)	2	AS
2	65-4741-5	TRIM, TOILET A DOOR EDGE	14	14
3	65-4741-9	ATTACHING PARTS		
4	65-4741-10			
5	65-4741-10			
6	65-4741-10			
7	65-4741-14			
8	65-4741-12			
9	65-4741-13			
10	65-4741-13			
10A	2010-7-1-10			
10B	5AM10-3A			
10C	69-10838-4			
10D	69-10838-4			
10E	69-10838-5			
10F	69-10838-6			
10G	69-10838-8			
10H	69-10838-10			
10I	69-10838-7			
11	L107A			
12	65-4741-14			
13	65-4741-12			
14	65-4741-13			
14A	65-4741-17E			
14B	65-4741-37			
14C	69-10838-1			
14D	69-10838-2			
14E	69-10838-2			

THE PART NUMBER IS KNOWN

Find part number in numerical index. Note chapter, figure and item number.

Turn to chapter and figure and locate part on illustration and in parts list by the item number.

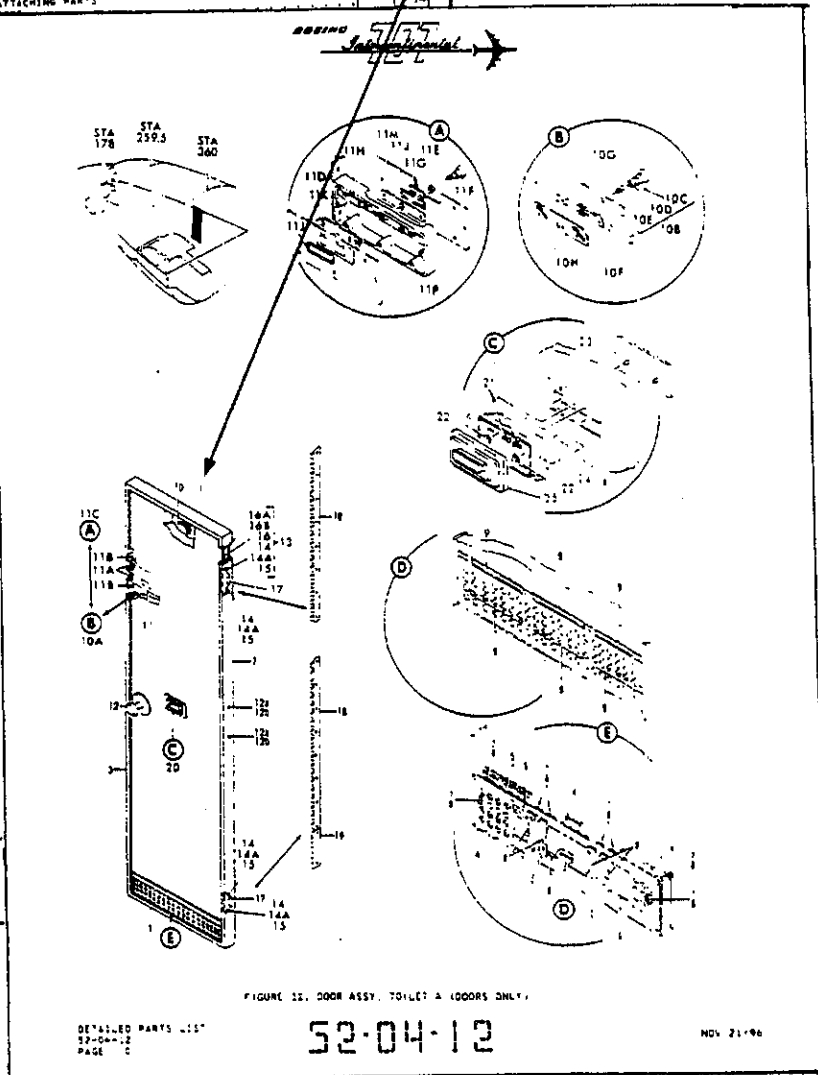

SAMPLE PAGES

STUDENT TRAINING OVERHAUL MANUAL (UNCONTROLLED - USE ON LIVE AIRCRAFT PROHIBITED)

INSTRUCTIONS FOR USE OF CATALOG

THE PART NUMBER IS NOT KNOWN

Turn to Table of Contents in the desire chapter.

Refer to main group in which part should be listed.

Figures are listed in alphabetical order by main noun. Find title of figure in which the part should be shown. Note section and figure number.

Refer to corresponding item number in the parts list.

Turn to the illustration and find the part.

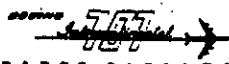

PARTS CATALOG

CHAPTER 32
DOORS

TABLE OF CONTENTS

SECTION	FIGURE
32-04 MISCELLANEOUS DOORS	
DOOR ASSY, TOILET A	12
DOOR ASSY, TOILET B	13
DOOR ASSY, TOILET C	14
DOOR ASSY, TOILET E	16
DOOR INSTL, ELECTRONIC ACCESS	1
DOOR INSTL, STATION 302 PARTITION	1
DOOR INSTL, TOILET C FOLDING	1
FRAM INSTL	1



PARTS CATALOG

FIGURE & ITEM NO	MANUFACTURER'S PART NUMBER	NOMENCLATURE	QTY FROM YD	AMTD PER ASBY
12	65-4741-272	DOOR ASSY, TOILET A (DOORS ONLY) (SEE 23-17, FIG. 89, ITEM 1) AND 23-17, FIG. 91, ITEM 3)	2	87
1	65-4741-5	ATTACHING PARTS	14	
	BACS12M0-10	SCREEN	1	
2	65-4741-6	TRIM, ATTACH	21	
	BACS12M0-10	SCREEN	1	
3	65-4741-22	TRIM, ATTACH	21	
	BACS12M0-10	SCREEN	1	
4	65-4930-7	GRILL	1	
5	65-4741-10	DOOR ASSY, TOILET A	1	
	BACS12M0-6	SCREEN	1	
6	65-4946	GRILL	1	
	BACS12M0-6	SCREEN	1	
7	65-4741-14	DOOR ASSY, TOILET A	1	
8	65-4741-12	DOOR ASSY, TOILET A	1	
9	65-4741-13	DOOR ASSY, TOILET A	1	
10	OP111-2	OP111-2	1	
	BACS12M0-8	SCREEN	1	
10A	2010-2-1-10	2010-2-1-10	1	
10A	SAM10-38	SAM10-38	1	
	BACS12M0-8	SCREEN	1	
10B	65-10830-4	65-10830-4	1	
10C	MIS361C2-5	MIS361C2-5	1	
10D	65-10830-5	65-10830-5	1	
10E	65-10830-6	65-10830-6	1	
10F	65-10830-8	65-10830-8	1	
10G	65-10830-10	65-10830-10	1	
10H	65-10830-7	65-10830-7	1	
12	L107A	L107A	1	
	BACS12M0-8	SCREEN	1	
13	65-4700-30W	65-4700-30W	1	
14	65-4700-18A	65-4700-18A	1	
10A	65-4700-170	65-4700-170	1	
	65-4700-37	65-4700-37	1	
16	65-10830-1	65-10830-1	1	
	BACS12M0-1	BACS12M0-1	1	
19	65-10830-1	65-10830-1	1	
	BACS12M0	BACS12M0	1	

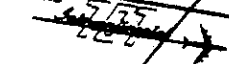

FIGURE 12. DOOR ASSY, TOILET A (DOORS ONLY)

52-04-12

NOV 21/98

SAMPLE PAGES

707

STUDENT TRAINING OVERHAUL MANUAL (UNCONTROLLED - USE ON LIVE AIRCRAFT PROHIBITED)

INSTRUCTIONS FOR USE OF CATALOG



BOEING 707 International

PARTS CATALOG

FUSELAGE-BODY ASSEMBLIES		NOMENCLATURE						EFF FROM TO	UNITS PER ASSY
FIGURE & ITEM NO.	MANUFACTURER'S PART NUMBER	1	2	3	4	5	6		
	50-2541	STRUCTURE ASSY, SECTION 41 (SEE 53-1, FIG. 1, ITEM 43)							RF
	65-8364	EXTINGUISHER INSTL, SECTION 41 LOWER FIRE							1
	EXTINGUISHER	EXTINGUISHER, TYPE A-20							1
	ATTACHING PARTS								
	AN515-5R6	SCREW							4
	BACW10P38AL	WASHER, (OPTIONAL AN960-6L)							AN
	50-3137-1	PEDAL INSTL, PILOTS RUDDER LH							1
	50-3137-2	PEDAL INSTL, COPILOTS RUDDER RH							1
	50-3138-1	PEDAL ASSY, PILOTS RUDDER (LH ONLY) (SEE 27-3, FIG. 8)							1
	50-3138-2	PEDAL ASSY, COPILOTS RUDDER (RH ONLY) (SEE 27-3, FIG. 8)							1
	60-5233	SWITCH INSTL, PILOT STATION MICROPHONE							1
	90-4832	SWITCH INSTL, FLIGHT ENGINEER STATION MICROPHONE							1
	10-1147	SWITCH, MICROPHONE							1
	ATTACHING PARTS								
	AN520-6R4	SCREW, (USED ON 60-5233)							2
	AN507-602R4	SCREW, (USED ON 90-4832)							2
	50-8529-1	RELAY INSTL, SECTION 41 BATTERY							1
	G54329A	RELAY, HERMETICALLY SEALED (V73949)						A	1
	G54950	RELAY, HERMETICALLY SEALED (V73949)						B	1
	8-3361-19	RHEOSTAT, AIRCRAFT POWER (ALTERED FROM AN3155-25-50)							1
	50-10351	DISCHARGE INSTL, SIGNAL PISTOL							1
	MOUNT	MOUNT, PYROTECHNIC TYPE M1						0114	1
	10-3547-2	COVER ASSY							1
	412-2A17-3	(SAME AS 412-2A17-3 (V87562))							RF
	COVER ASSY								
	(SAME AS BAC SPEC DWG 10-3547-2)								
	M 10 L497C5	LATCH-(V83421)							1
	M 11 412-96A6	SPRING-(V87562)							1
	65-8269	HATCH INSTL, FLOOR (FUSELAGE ONLY)							1
	LIGHTS, (SEE 33-1, FIG. 6)								
	REQUIRED PLACARDS, (SEE 11-1, FIG. 1)								
	12 6-58926	SEAL, FLOOR HATCH (EXTRUSION NO. BAC1921-27 X 64.0 IN. LG)							1
	13 65-8269-1	HATCH, FLOOR							1
	14 50-6824	VALVE ASSY, METERING							1
	14 50-6824-1	SPARES ASSY, METERING VALVE (CONSISTS OF PARTS DENOTED BY S)							RF
	15 S 3-95672	PIN, METERING VALVE PISTON (OPTIONAL 3-95672-1)							1
	15 S 3-95672-1	PIN, METERING VALVE PISTON (OPTIONAL TO 3-95672)							1
	16 S BAC811W3	WASHER							1
	17 S B2700-12	VALVE ASSY, METERING (V12345)							1
	M 18 B2701	RING, LOCK (V12345)							1
	M 19 NAB1611-330	PACKING							3
	M 20 B2703	PISTON, (V12345)							1
	21	PLUMBING INSTL, SECTION 41 HYDRAULIC (SEE REF SEC 29-2, FIG. 1)							RF
		A 2001-2499							
		S 2301-9999							

MISSING ITEM NUMBERS ARE NOT APPLICABLE

XXX
NOV 21/XX

53-02-1

DETAILED PARTS LIST
53-02-1
PAGE 1

SAMPLE PAGE

STUDENT TRAINING OVERHAUL MANUAL
(UNCONTROLLED - USE ON LIVE AIRCRAFT PROHIBITED)

INSTRUCTIONS FOR USE OF CATALOG

1. The figure number refers to the corresponding illustration.
2. The number in the Figure and Item Number column corresponds to the item number on the part in the corresponding illustration.
3. Boeing Standard Parts are identified by BAC standard part numbers in the Part Number column.
4. A descriptive noun in the Part Number column indicates the part has no applicable part number but is identified for procurement by the complete nomenclature in the Nomenclature column.
5. A vendor's part is identified by the vendor's part number in the Part Number column and the vendor code following the nomenclature in the Nomenclature column (see note 14).
6. This is a Boeing Specification Number. For applicable vendor part number see the Specification Cross Reference Index.
7. Cross-reference by chapter, figure and item number indicates where the installation or assembly is listed under its next higher assembly. Cross-reference by figure and item number only indicates the figure is in the same section.
8. Functionally related figures are illustrated in phantom and listed in column 1 of the breakdown. The related figure number is referred to by the note "(for ref see --)".
9. Cross-reference by chapter and figure number indicates the figure in which the installation or assembly is broken down to its component parts. Cross-reference by figure only indicates the figure is in the same section.
10. Optional part numbers are listed in the Part Number column and cross-reference in the Nomenclature column with the phrase OPT. or OPT. TO (optional to).
11. Parts used only on a lefthand installation or righthand installation or assembly are designated by "(LH only)" or "(RH only)" in the Nomenclature column.
12. A "(used on --)" note in the Nomenclature column indicates the proper next higher assembly of a part when the part is not common to all of the next higher assemblies listed preceding the part.

707

STUDENT TRAINING OVERHAUL MANUAL (UNCONTROLLED - USE ON LIVE AIRCRAFT PROHIBITED)

13. Attaching parts are listed immediately following the part(s) attached. A symbol ---*--- follows the last item of the attaching parts.
14. Vendors' codes are shown in the Nomenclature column following the nomenclature of the part. Vendors' codes consist of the Federal Supply code preceded by the letter "V". Where no Federal Supply code is available the vendor is indicated in one of the following
 - A. A Boeing Code is assigned pre ceded or followed by the letter "B".
 - B. When no code can be found, the vendor's name is used. A list of all vendor's codes, names and addresses is included in the Introduction.
15. Material Specifications are given on various seals using Boeing Standard materials.
16. Parts made by altering other parts are indicated as "(altered from--)" in the Nomenclature column.
17. A number in the Units per Assembly column indicates the quantity of the part used per next higher assembly or installation.
18. "RF" indicates the installation or assembly is listed again in the figure cross-reference in the Nomenclature column (see note 7). The Units per Assembly is given in the referenced figure.
19. Parts used in the quantity "as required" are indicated by "AR" in the Units per Assembly column.
20. A letter in the Effectivity column of the Master Catalog indicates usage of the part is restricted to the airplanes carrying the serial numbers indicated at the end of the breakdown.
21. The airplane serial numbers corresponding to the code letters in the Effectivity column of the Master Catalog are given at the end of each coded parts list. For complete list of customer serial numbers see the Airplane Customer, Manufacturing and Registry Numbers page of the Introduction.

STUDENT TRAINING OVERHAUL MANUAL
(UNCONTROLLED - USE ON LIVE AIRCRAFT PROHIBITED)

22. Numbers in the Effectivity column of customized catalogs indicate usage of the part in the part number column is restricted. For example: the numbers "0114" indicate the part is used on airplanes 1 thru 14. For a conversion list of these numbers to customer numbers see the Airplane Customer, Manufacturing and Registry Numbers page of the Introduction. When there is no entry in this column the part is effective on all aircraft covered in the IPC.
23. An "M" preceding the item number indicates the part is a maintenance detail of a vendor assembly which is normally not disassembled in the Parts Catalog. These vendor assemblies are disassembled only to the extent of the maintenance details. In these instances the vendor end item is included as an additional entry. The vendor Part Number and Boeing Specification entries are cross-referenced with "SAME AS _____" notes in the nomenclature.
24. An "S" preceding the part number indicates the part is also a detail of a Spares Assembly. Details of Spares Assemblies may also be shown by "used on" notes (see note 12).
25. Certain items contain components which are illustrated and listed in various chapters according to their ATA 100 function. The presence of this condition and the location of associated functional coverage is indicated in the NOMENCLATURE column. For example the portion of the Hatch Installation covering FUSELAGE (the Hatch Structure) is displayed in chapter 53 (the Sample Figure). The LIGHTS and PLACARDS functions included in the Hatch Installation are identified in chapters 33 and 11 respectively.
26. An R in the left hand or the right hand margin indicates the addition of or a revision to the data on the line entry opposite the R indicator.
27. In addition to the above explanation, supplemental information will be supplied when required. For instance, Airline Modifications and Service Bulletins may be shown when requested by the Airline. Any Modification submitted by a customer will be identified by a parenthetical reference to the customer airline modification. These modifications are incorporated in the form submitted by the airline to the publisher, and Boeing assumes responsibility for the validity or technical accuracy of no such modifications.

707

STUDENT TRAINING OVERHAUL MANUAL (UNCONTROLLED - USE ON LIVE AIRCRAFT PROHIBITED)

THE BOEING COMPANY EXPRESSLY DISCLAIMS ANY AND ALL WARRANTIES, EXPRESS OR IMPLIED, ORAL OR WRITTEN, ARISING BY LAW, COURSE OF DEALING, OR OTHERWISE AND WITHOUT LIMITATION ALL WARRANTIES AS TO QUALITY, OPERATION, MERCHANTABILITY, FITNESS COMPANY EXPRESSLY DISCLAIMS ANY FOR ANY INTENDED PURPOSE AND ALL OTHER CHARACTERISTICS WHATSOEVER, OF CUSTOMER ORIGINATED MODIFICATIONS INCORPORATED INTO THE CATALOG. THE FOREGOING DISCLAIMER WILL ALSO APPLY TO ANY OTHER PORTION OF THE CATALOG WHICH MAY BE AFFECTED OR COMPROMISED BY SUCH CUSTOMER ORIGINATED MODIFICATIONS.

STUDENT TRAINING OVERHAUL MANUAL (UNCONTROLLED - USE ON LIVE AIRCRAFT PROHIBITED)

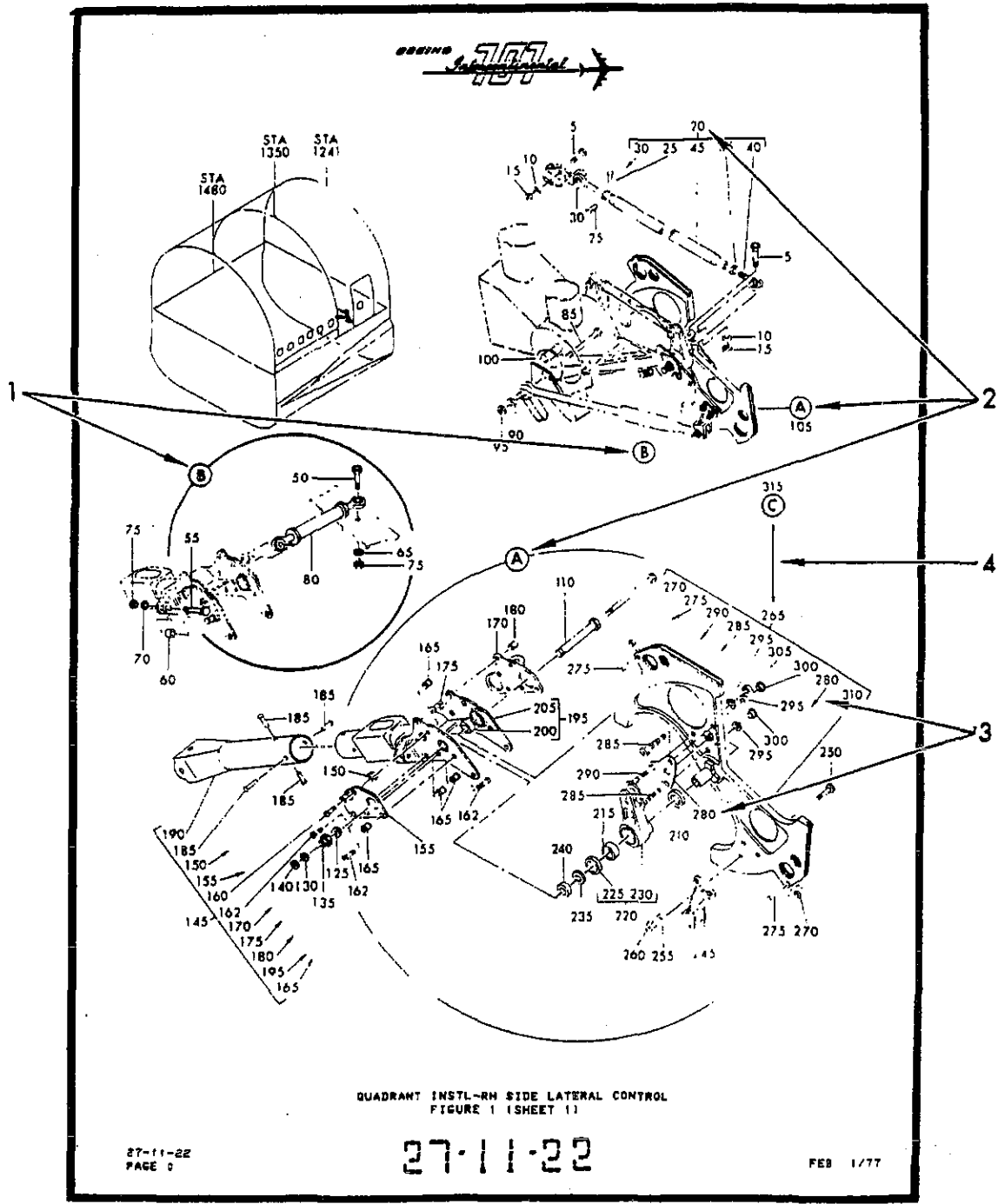

SAMPLE PAGE

707

STUDENT TRAINING OVERHAUL MANUAL (UNCONTROLLED - USE ON LIVE AIRCRAFT PROHIBITED)

EXPLANATION OF ILLUSTRATION TECHNIQUES

The illustration portion of a figure in the Illustrated Parts Catalog pictorially displays the relationship of the parts identified in the Parts List. The following is an explanation of certain techniques used in the illustration to present the relationship of these parts. The numbers correspond to those shown in the preceding sample.

1. Detailed coverage of any portion of the illustration is provided by isolating sections in specific exploded views with alphabetic designations.
2. Components of assemblies are shown either within a specific alphabetically identified exploded view of the assembly or the item numbers of the components are included within a bracket which is identified with the item number of the assembly.
3. When a component is physically illustrated such that a lead line from the item number within a bracket to the illustration of the part would be confusing or indeterminate, an arrow is used to point in the direction of the illustrated component.
4. Alternate configurations are indicated by a dual-headed arrow relating the illustration of the configurations involved.

707

STUDENT TRAINING OVERHAUL MANUAL (UNCONTROLLED - USE ON LIVE AIRCRAFT PROHIBITED)

ROYAL AUSTRALIAN AIR FORCE

AIRPLANE EFFECTIVITY CROSS REFERENCE

Model Type/	Cust. Effect. Code	Cust. Effect. Code Term.	Variable Number	Mfg. Serial Number	Registry Number
707-338C	001		07814	19623	A20-623
	002		07815	19624	A20-624
	003		07818	19627	A20-627
	004	050	07820	19629	A20-629
707-368C	051		09286	21103	HZ-ACG
	052	099	09288	21261	HZ-ACI

A block of aircraft Effectivity numbers is set aside for each customer to cover sold aircraft as well as possible future purchases.

The aircraft Effectivity Code is reflected on items in the Detailed Parts List only when the item is not effective on all your sold aircraft at time of issue of this document. The aircraft Effectivity Code will be blank when the item is effective on all sold aircraft.

The first two positions represent the beginning effective airplane and the last two positions represent the ending effective airplane. The last two positions will either reflect one of the Effectivity Codes shown above or the Effectivity (Block) Code Termination number. When the Effectivity Code Termination number is used it merely indicates that the part will normally be used on the remaining aircraft assigned within your Block.

707

STUDENT TRAINING OVERHAUL MANUAL (UNCONTROLLED - USE ON LIVE AIRCRAFT PROHIBITED)

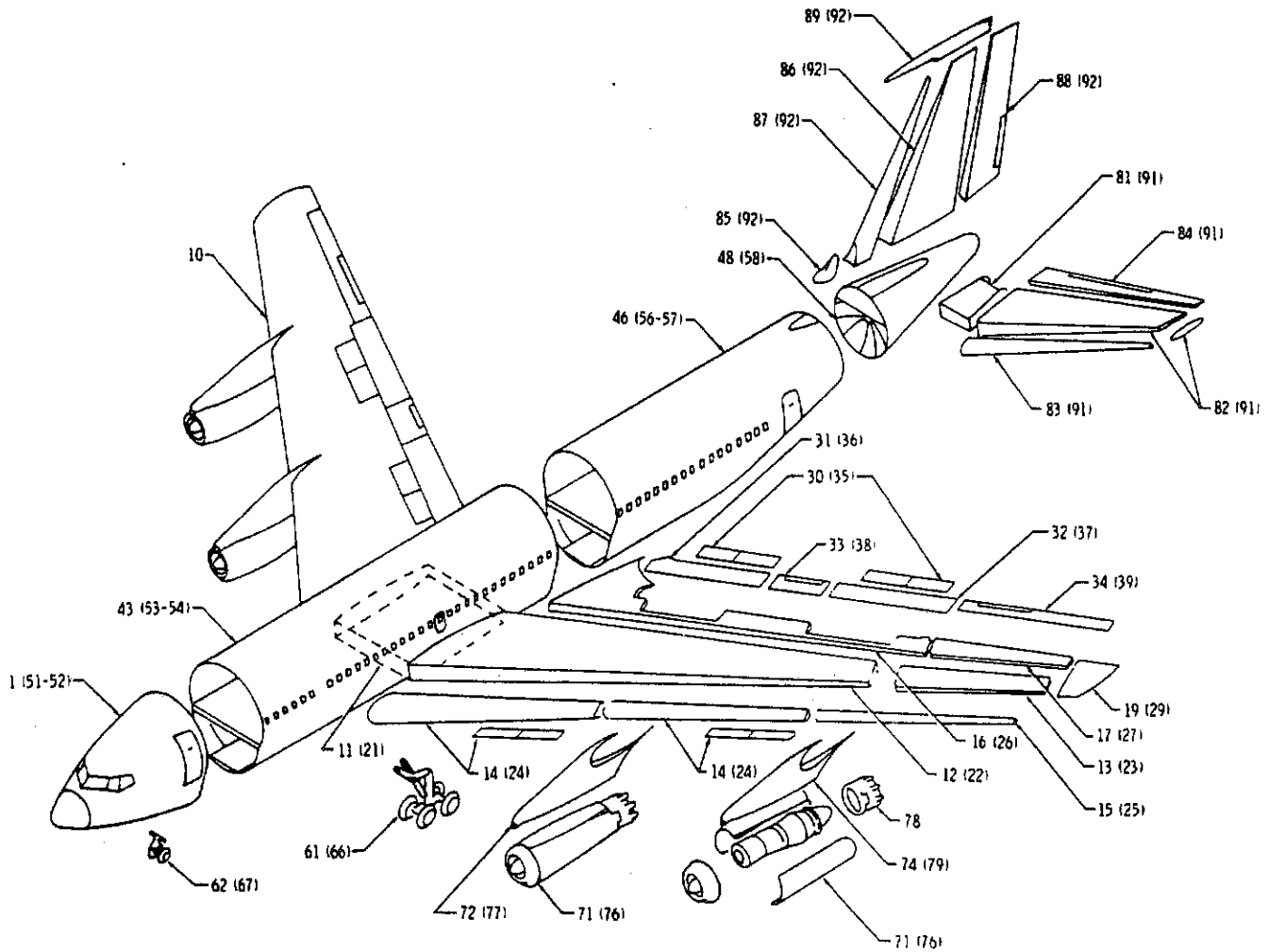

AIRPLANE SECTIONAL BREAKDOWN

STUDENT TRAINING OVERHAUL MANUAL (UNCONTROLLED - USE ON LIVE AIRCRAFT PROHIBITED)

AIRPLANE STATION DIAGRAMS

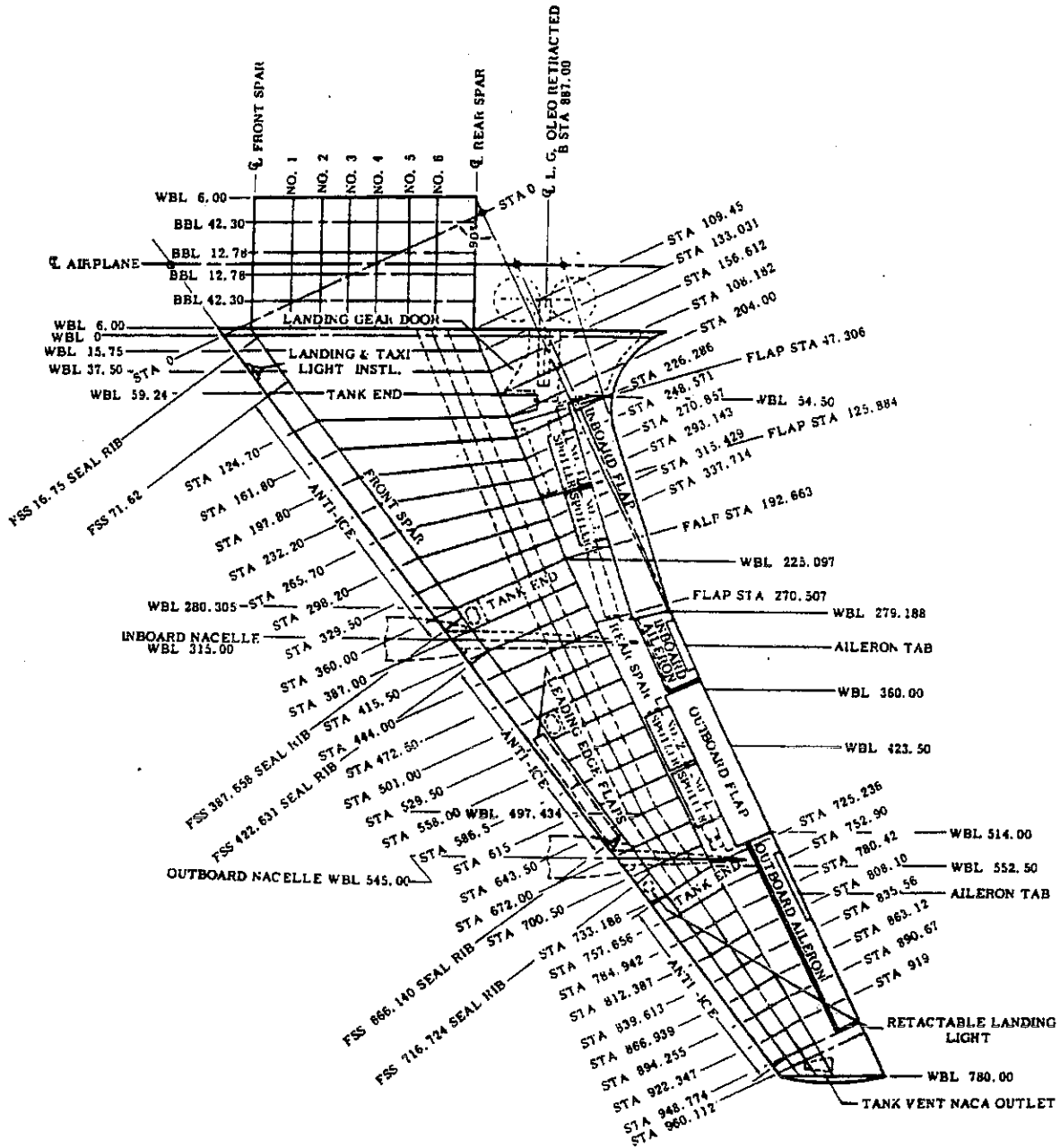

3100-11C

MODELS 320/420
WING STATION DIAGRAM

707

STUDENT TRAINING OVERHAUL MANUAL (UNCONTROLLED - USE ON LIVE AIRCRAFT PROHIBITED)

AIRPLANE STATION DIAGRAMS

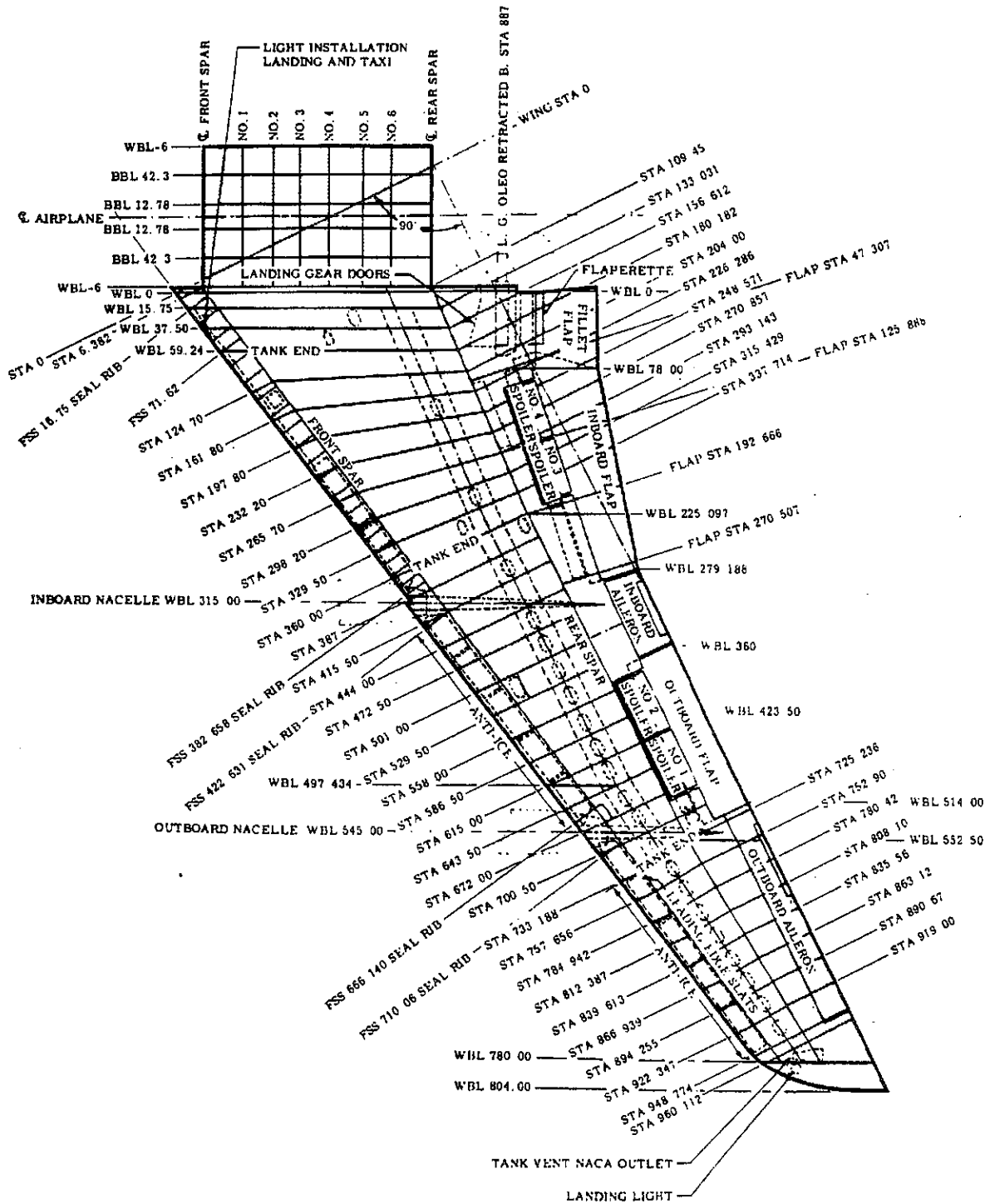

MODEL 320B/C
WING STATION DIAGRAM

3100-IXA

STUDENT TRAINING OVERHAUL MANUAL
(UNCONTROLLED - USE ON LIVE AIRCRAFT PROHIBITED)

AIRPLANE STATION DIAGRAMS

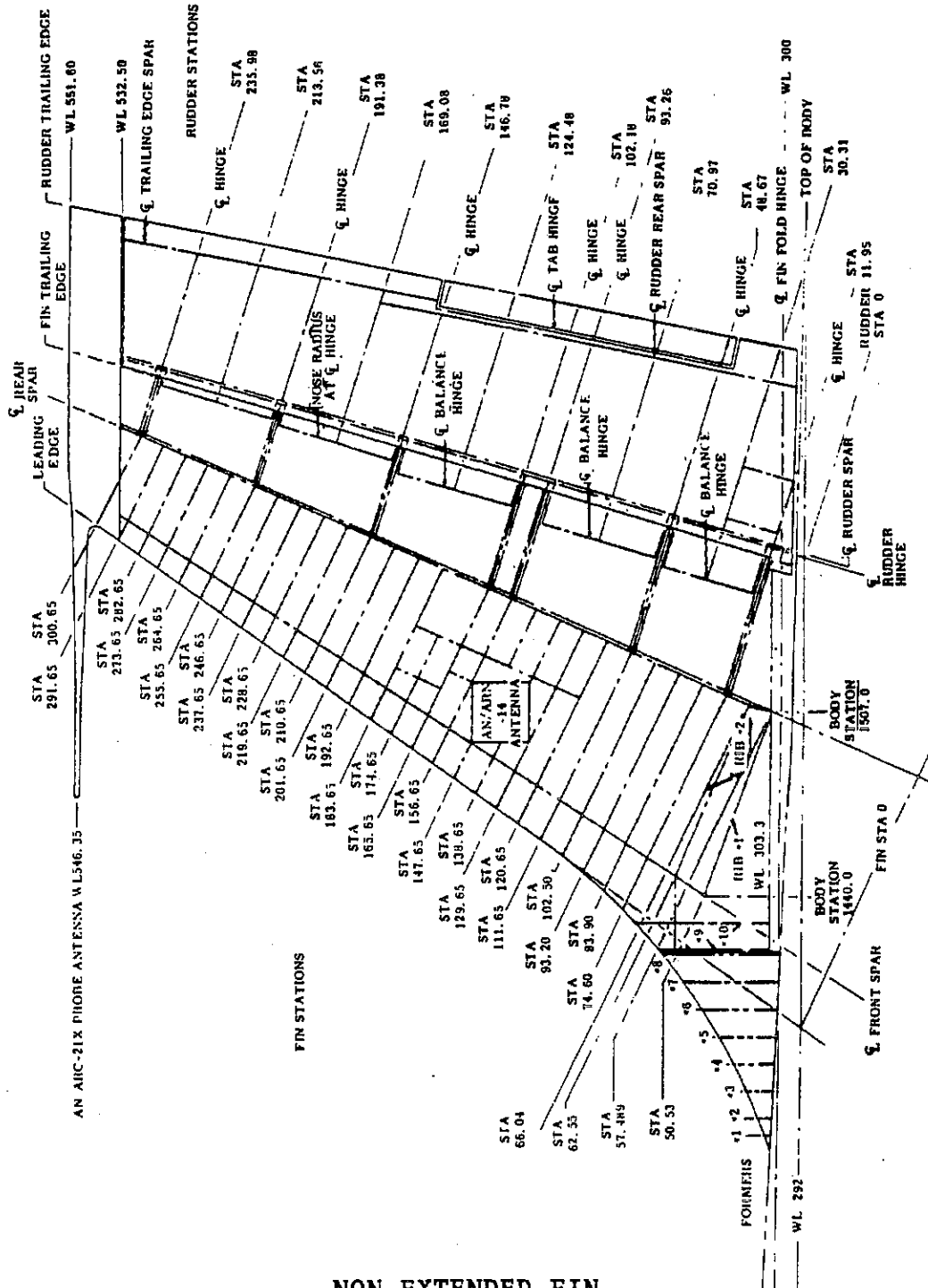

NON EXTENDED FIN
VERTICAL TAIL STATION DIAGRAM

3100-III D

STUDENT TRAINING OVERHAUL MANUAL
(UNCONTROLLED - USE ON LIVE AIRCRAFT PROHIBITED)

AIRPLANE STATION DIAGRAMS

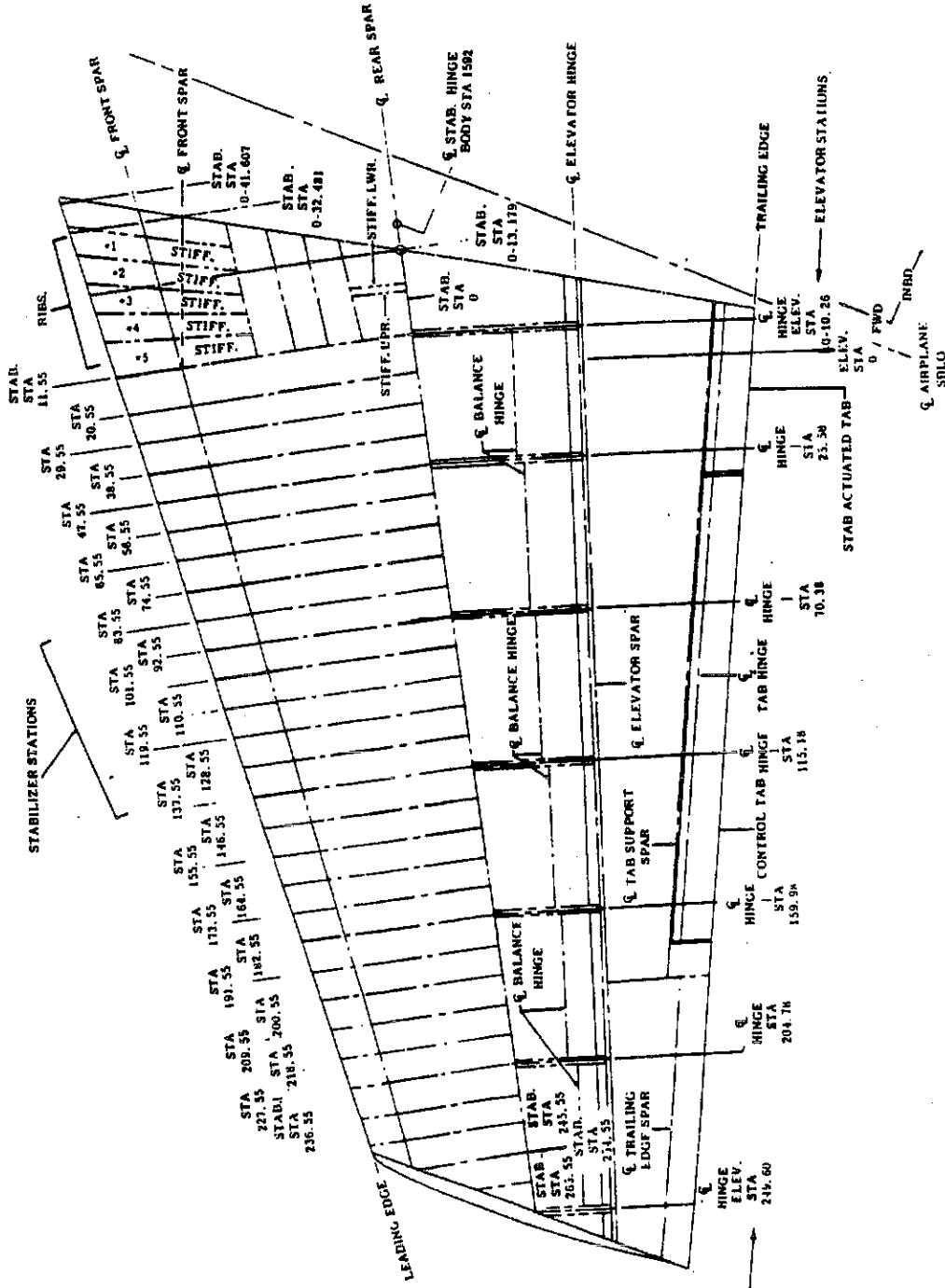

3100-IX A

STABILIZER AND ELEVATOR STATION DIAGRAM

707

STUDENT TRAINING OVERHAUL MANUAL (UNCONTROLLED - USE ON LIVE AIRCRAFT PROHIBITED)

AIRPLANE STATION DIAGRAMS

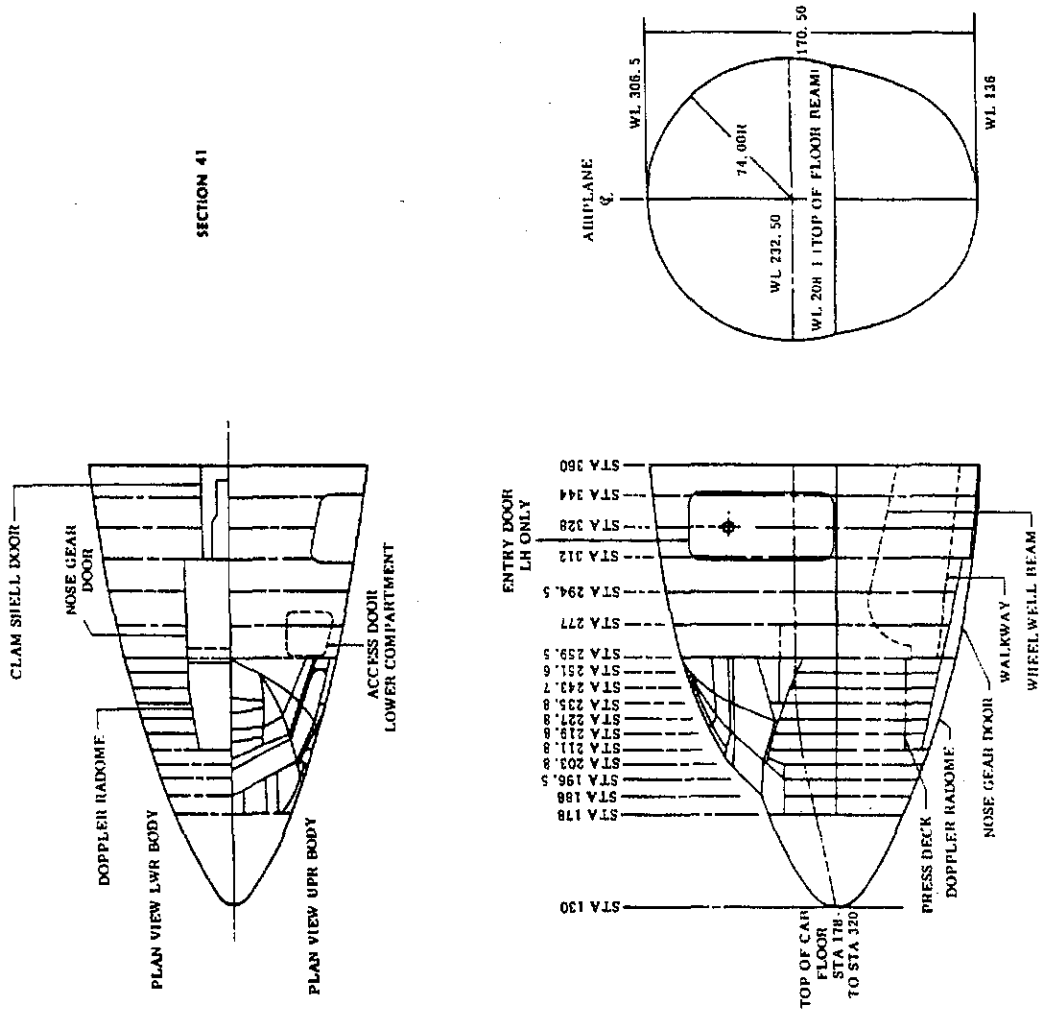

3100-YA

BODY SECTION 41 STATION DIAGRAM

707

STUDENT TRAINING OVERHAUL MANUAL (UNCONTROLLED - USE ON LIVE AIRCRAFT PROHIBITED)

AIRPLANE STATION DIAGRAMS

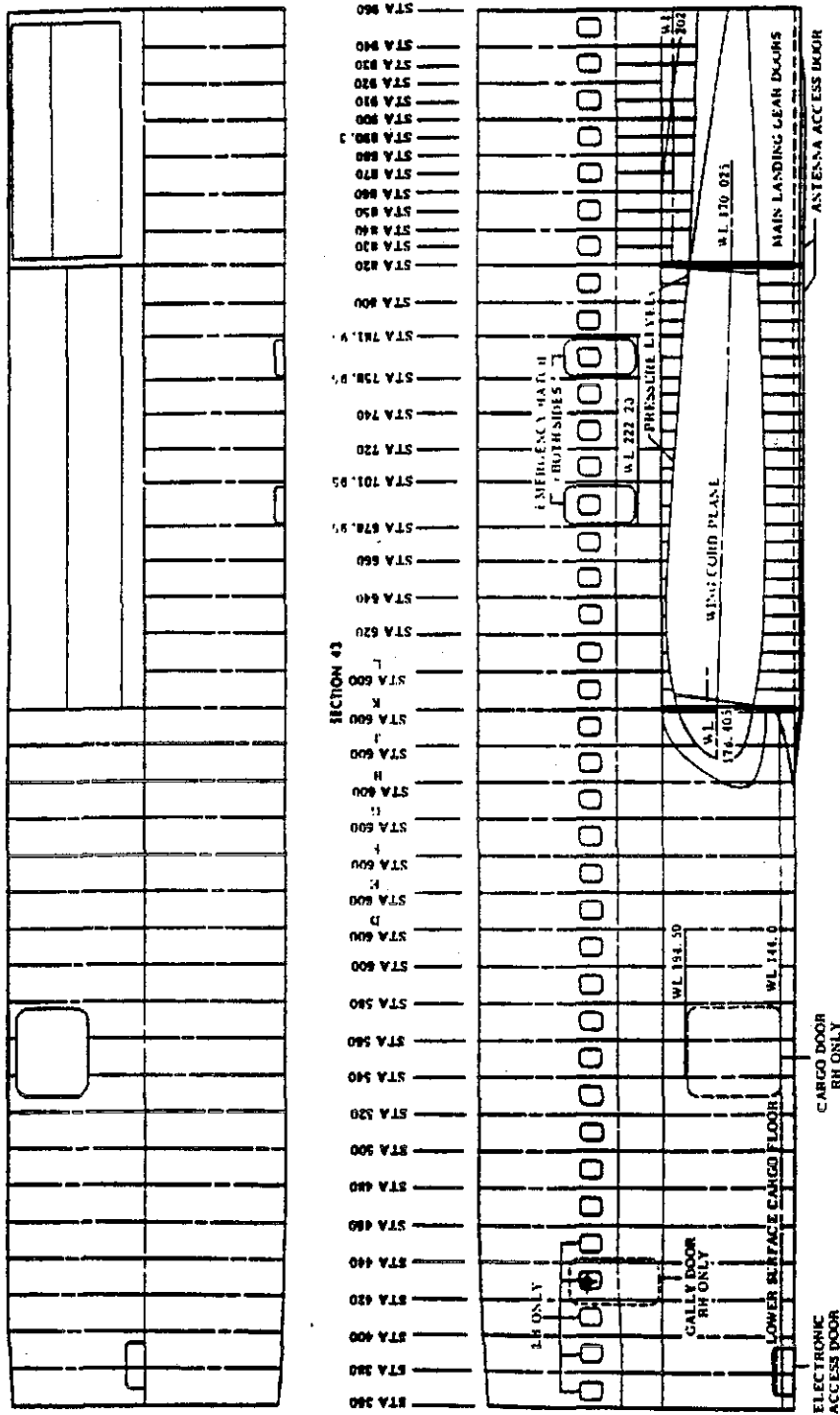

320/420 PASSENGER VERSION
BODY SECTION 43 STATION DIAGRAM

3100-22B

707

STUDENT TRAINING OVERHAUL MANUAL (UNCONTROLLED - USE ON LIVE AIRCRAFT PROHIBITED)

AIRPLANE STATION DIAGRAMS

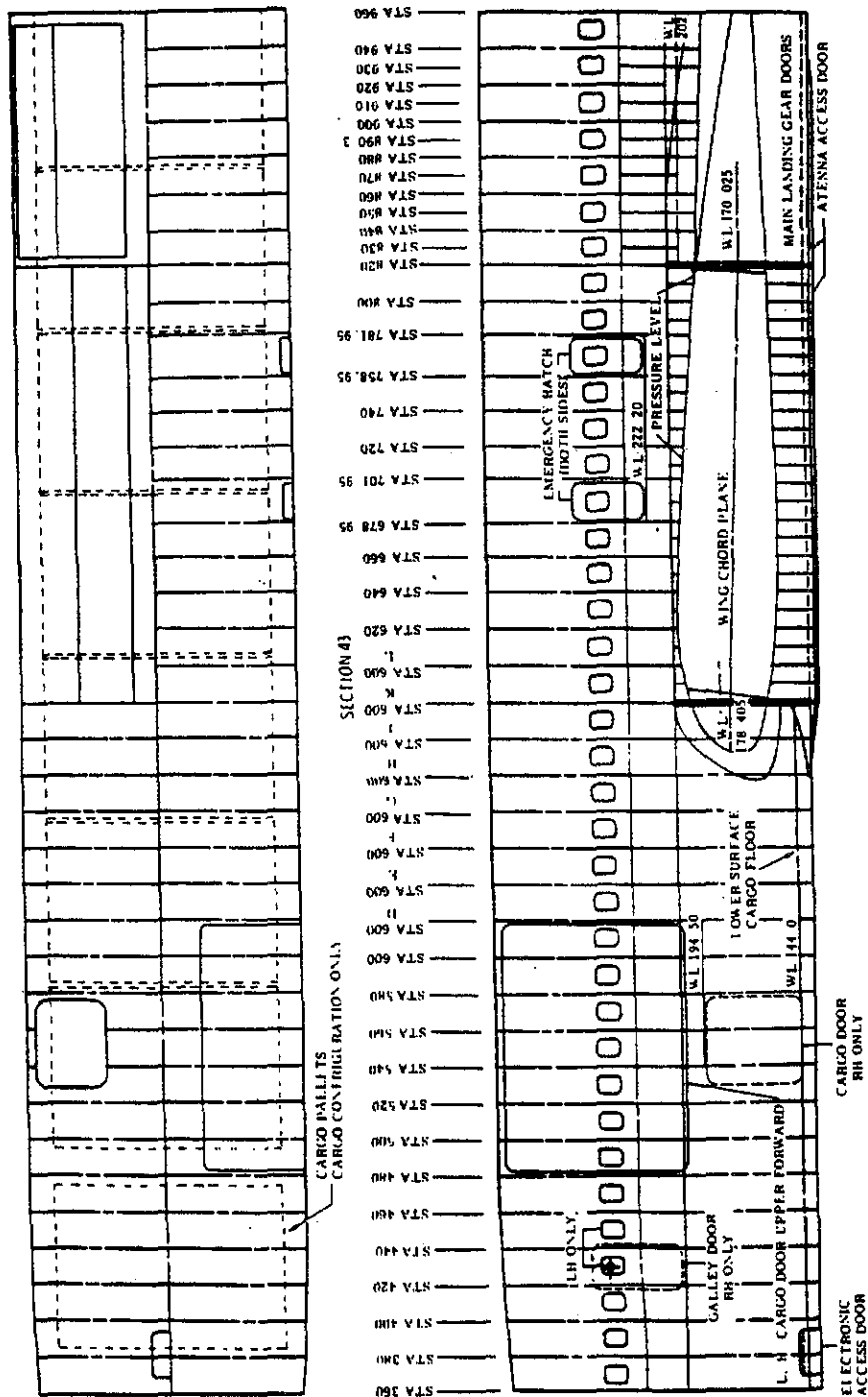

320 PASSENGER/CARGO VERSION
BODY SECTION 43 STATION DIAGRAM

3100-ZB

707

STUDENT TRAINING OVERHAUL MANUAL
(UNCONTROLLED - USE ON LIVE AIRCRAFT PROHIBITED)

AIRPLANE STATION DIAGRAMS

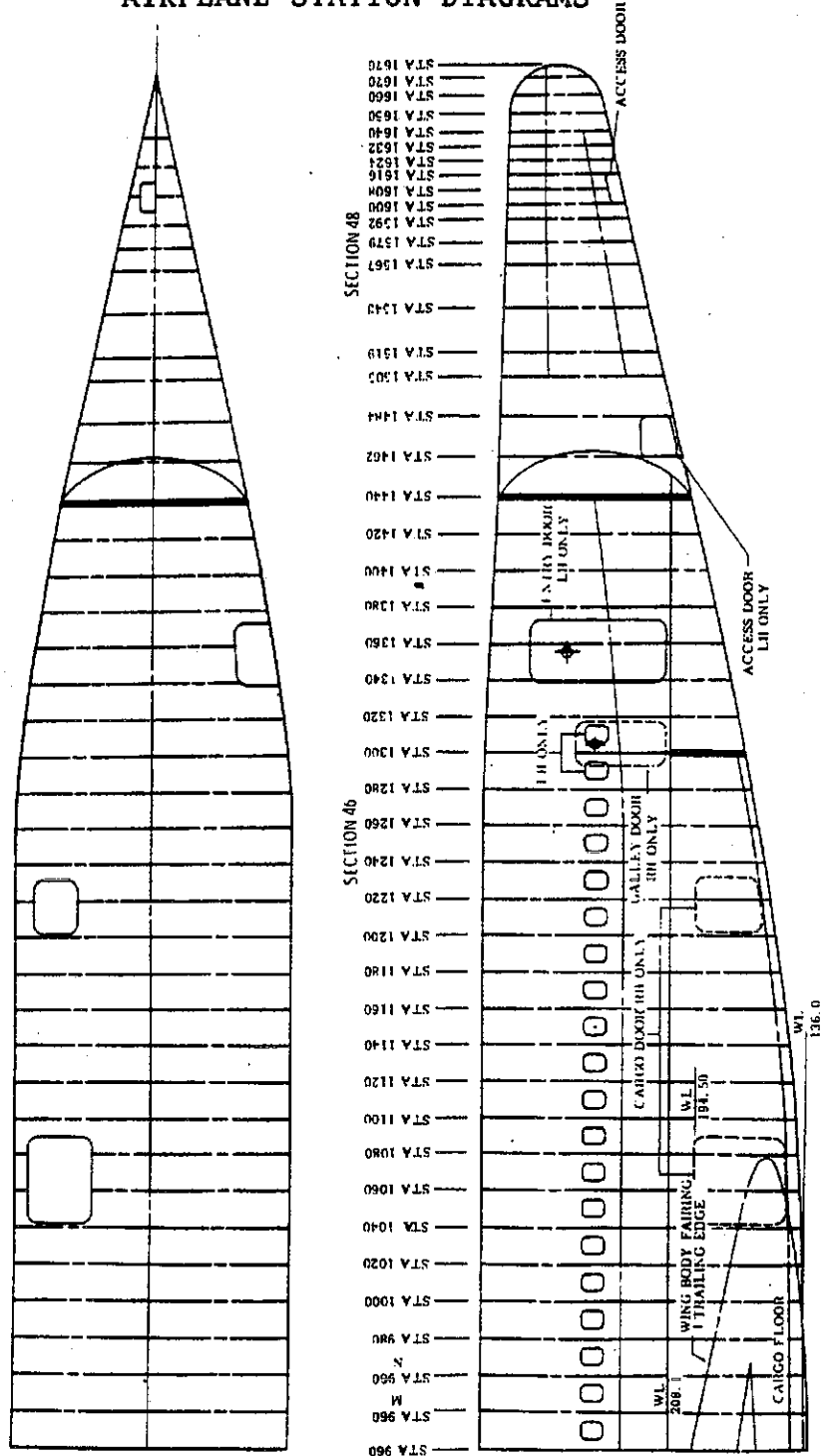

320/420 PASSENGER VERSION
BODY SECTION 46 AND 48 STATION DIAGRAM

3100-220

707

STUDENT TRAINING OVERHAUL MANUAL (UNCONTROLLED - USE ON LIVE AIRCRAFT PROHIBITED)

AIRPLANE STATION DIAGRAMS

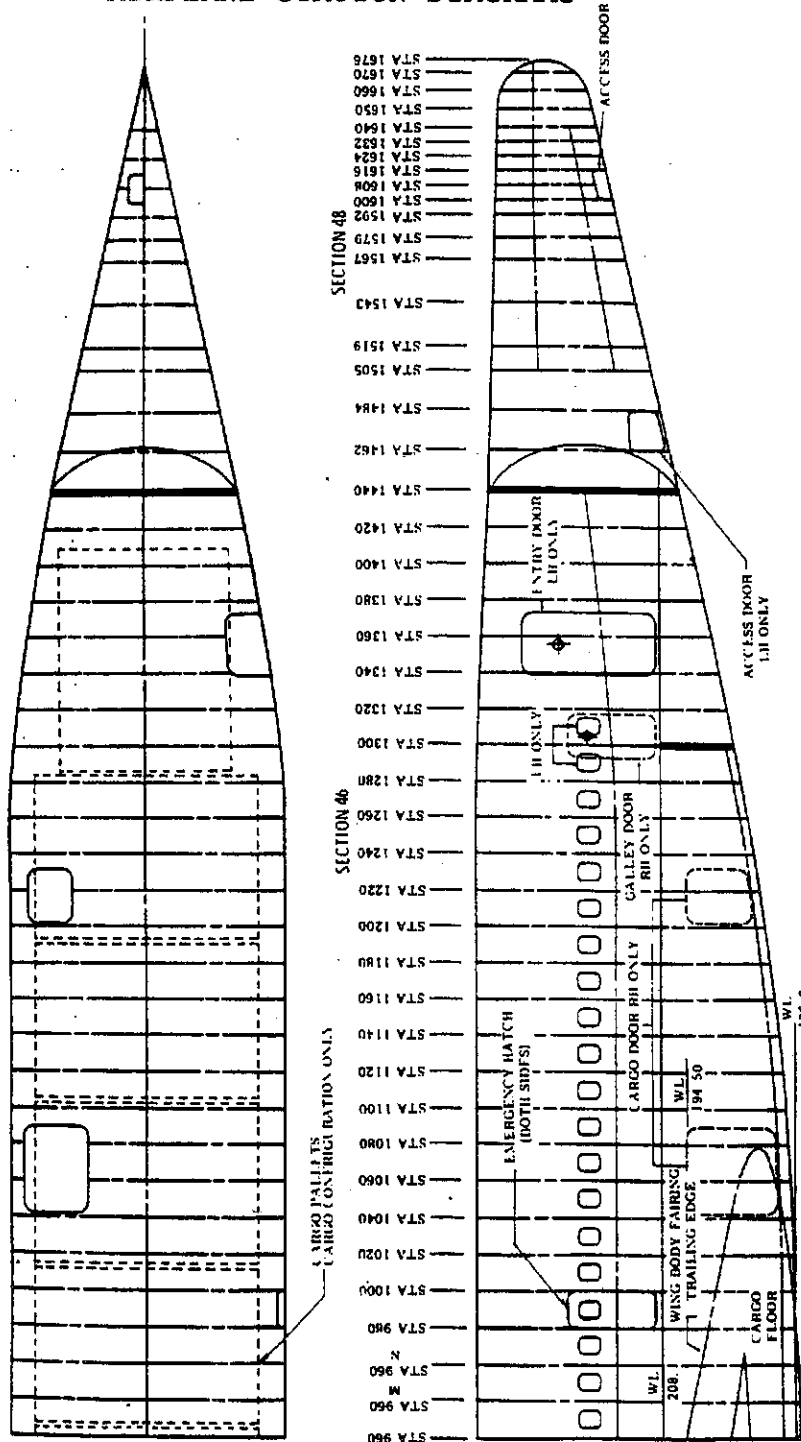

320 PASSENGER/CARGO VERSION
BODY SECTION 46 AND 48 STATION DIAGRAM

3109-21A

707

STUDENT TRAINING OVERHAUL MANUAL
(UNCONTROLLED - USE ON LIVE AIRCRAFT PROHIBITED)

This page intentionally left blank

707

STUDENT TRAINING OVERHAUL MANUAL (UNCONTROLLED - USE ON LIVE AIRCRAFT PROHIBITED)

MAJOR DRAWING NUMBER INDEX-MODEL

65-6493

65-1350 FINAL ASSY, Model 707-300, -300B C and -400

5-73134 . AILERON INSTL, Outboard
65-1096 . AILERON INSTL, Wing inboard

50-2541 . BODY INSTL, Section 41
50-9352 . . AIR CONDITIONING INSTL, Sect 52
 . . CONTROL INSTL, (See separate listing)

50-5551 . . ELECTRICAL INSTL, Section 51
50-6851 . . ELECTRONIC INSTL, Section 51
65-6824 . . EQUIPMENT INSTL, Control cabin
50-6846 . . HYDRAULIC INSTL, Section 51
65-68676 . . POTABLE WATER INSTL, Section 41 300 300B 400
65-31792 . . POTABLE WATER INSTL, Section 41 300C
65-1656 . . TUBING INSTL, Section 41 oxygen

50-2543 . BODY INSTL, Section 43
65-5264 . . AIR COMPRESSOR INSTL, Engine starter 300B C
50-9354 . . AIR CONDITIONING INSTL, Section 54
65-4182 . . CAVITY DRAIN INSTL, Wing center section
 . . CONTROL INSTL, (See separate listing)

65-29004 . . DRAIN MAST INSTL, Water injection 300B C
50-5553 . . ELECTRICAL INSTL, Section 53
50-6853 . . ELECTRONIC INSTL, Section 53
50-10300 . . EQUIPMENT INSTL, Cargo compartment forward section 54
50-6831 . . FILLER NECK INSTL, Water injection external listing
65-13183 . . HEATER INSTL, Water injection 300B C
50-6847 . . HYDRAULIC INSTL, Section 53
65-68676 . . POTABLE WATER INSTL, Section 43 300 300B 400
65-31792 . . POTABLE WATER INSTL, Section 43 300C
65-18985 . . REGULATOR AND SOLENOID VALVE INSTL, 300B C
65-6863 . . SUPPORT INSTL, Water injection tank 300B C
50-10655 . . TANK EQUIPMENT INSTL, Water injection
65-6864 . . TANK INSTL, Auxiliary water injection
65-4738 . . TUBING INSTL, Oxygen section 43
65-8679 . . TUBING INSTL, Pressure filling water injection tank
65-2933 . . TUBING INSTL, Starter compressor
65-18979 . . TUBING INSTL, Water injection section 54
65-21909 . . VALVE INSTL, Air starter relief
65-6163 . . VENT INSTL, Wing center section

65-2546 . BODY INSTL, Section 46
50-6869 . . AIR BOTTLE INSTL, Engine starter
50-9357 . . AIR CONDITIONING INSTL, Section 57
 . . CONTROL INSTL, (See separate listing)

707

STUDENT TRAINING OVERHAUL MANUAL (UNCONTROLLED - USE ON LIVE AIRCRAFT PROHIBITED)

- 50-5556 . . ELECTRICAL INSTL, Section 56
- 50-6856 . . ELECTRONIC INSTL, Section 56-58
- 50-10316 . . EQUIPMENT INSTL, Cargo compartment aft 300 300B 400
- 65-33568 . . EQUIPMENT INSTL, Cargo compartment aft section 57 300
- 5-72324 . . FAIRING INSTL, Fin and body
- 50-8288 . . FIN INSTL, Dorsal
- 65-55002 . . GROUND CONNECTION INSTL, Air starter 300B C
- 65-8642 . . HYDRAULIC INSTL, Section 56-58
- 65-68676 . . POTABLE WATER INSTL, Section 46 300 300B 400
- 65-31793 . . POTABLE WATER INSTL, Section 46 300C
- 65-3779 . . TUBING INSTL, Oxygen section 46

- 50-2548 . . BODY INSTL, Section 48
- 50-9781 . . CENTER SECTION INSTL, Horizontal stabilizer
- . . CONTROL INSTL, (See separate listing)
- 50-5558 . . ELECTRICAL INSTL, Section 58
- 50-6856 . . ELECTRONICS INSTL, Section 56-58
- 65-8642 . . HYDRAULICS INSTL, Section 56-58
- 65-6890 . . SEAL INSTL, Stabilizer rear spar

- . . CONTROL INSTALLATIONS, (See applicable sections)
- 50-8701 . . CONTROL INSTL, Aileron and spoiler
- 50-8705 . . CONTROL INSTL, Aileron trim
- 50-8702 . . CONTROL INSTL, Elevator
- 50-8712 . . CONTROL INSTL, Emergency landing gear extension
- 50-8714 . . CONTROL INSTL, Ground door release
- 50-8710 . . CONTROL INSTL, Landing gear
- 50-8713 . . CONTROL INSTL, Landing gear brakes
- 50-8711 . . CONTROL INSTL, Nose gear steering
- 50-8703 . . CONTROL INSTL, Rudder
- 50-8706 . . CONTROL INSTL, Rudder trim
- 50-8716 . . CONTROL INSTL, Speed brake
- 50-8704 . . CONTROL INSTL, Stabilizer trim
- 50-8709 . . CONTROL INSTL, Throttle
- 50-8707 . . CONTROL INSTL, Wing flap
- 50-8708 . . CONTROL INSTL, Wing flap drive

- 65-43625 . . CONVERSION KIT INDEX, AA 323C cargo
- 65-40196 . . CONVERSION KIT INDEX, AF 328C cargo
- 65-42641 . . CONVERSION KIT INDEX, AI 337C cargo
- 65-44138 . . CONVERSION KIT INDEX, AR 387C cargo
- 65-44138 . . CONVERSION KIT INDEX, BA 336C cargo
- 65-63910 . . CONVERSION KIT INDEX, BA 379C cargo
- 65-54176 . . CONVERSION KIT INDEX, BN 327C cargo
- 65-42641 . . CONVERSION KIT INDEX, BO 396C cargo
- 65-40198 . . CONVERSION KIT INDEX, CO 321C cargo
- 65-37242 . . CONVERSION KIT INDEX, CO 324C cargo
- 65-42641 . . CONVERSION KIT INDEX, CO 324C cargo
- 65-42641 . . CONVERSION KIT INDEX, EG 365C cargo
- 65-63910 . . CONVERSION KIT INDEX, EJ 355C cargo

707

STUDENT TRAINING OVERHAUL MANUAL (UNCONTROLLED - USE ON LIVE AIRCRAFT PROHIBITED)

65-65669	. CONVERSION KIT INDEX, ET 360C cargo
65-63910	. CONVERSION KIT INDEX, ET 379C cargo
65-42641	. CONVERSION KIT INDEX, FT 349C cargo
65-65672	. CONVERSION KIT INDEX, GR 307C cargo
65-37242	. CONVERSION KIT INDEX, IN 348C cargo
65-44137	. CONVERSION KIT INDEX, LH 330C cargo
65-42641	. CONVERSION KIT INDEX, LY 358C cargo
65-37243	. CONVERSION KIT INDEX, NW 351C cargo
65-42641	. CONVERSION KIT INDEX, NW 351C cargo
65-37240	. CONVERSION KIT INDEX, PA 321C cargo
65-59435	. CONVERSION KIT INDEX, PA 321C cargo
65-56402	. CONVERSION KIT INDEX, PK 340C cargo
65-31948	. CONVERSION KIT INDEX, QF 338C cargo
65-42641	. CONVERSION KIT INDEX, RD 365C cargo
65-63910	. CONVERSION KIT INDEX, RD 372C cargo
69-31946	. CONVERSION KIT INDEX, RG 341C cargo
65-63910	. CONVERSION KIT INDEX, RG 345C cargo
69-46573	. CONVERSION KIT INDEX, SA 344C cargo
65-63910	. CONVERSION KIT INDEX, SB 345C cargo
65-42641	. CONVERSION KIT INDEX, SN 329C cargo
65-63910	. CONVERSION KIT INDEX, ST 379C cargo
65-63910	. CONVERSION KIT INDEX, SV 368C cargo
69-46573	. CONVERSION KIT INDEX, TV 350C cargo
65-37241	. CONVERSION KIT INDEX, TW 331C cargo
65-37577	. CONVERSION KIT INDEX, TW 373C cargo
65-67820	. CONVERSION KIT INDEX, WA 347C cargo
65-63910	. CONVERSION KIT INDEX, WD 311C cargo
65-35478	. CONVERSION KIT INDEX, WY 373C cargo
65-35493	. CONVERSION KIT INDEX, WY 373C cargo
65-59999	. CONVERSION KIT INDEX, AA 323C passenger
65-58500	. CONVERSION KIT INDEX, AA 385C passenger
65-42155	. CONVERSION KIT INDEX, AF 328C passenger
65-57999	. CONVERSION KIT INDEX, AI 337C passenger
65-69496	. CONVERSION KIT INDEX, AR 387C passenger
65-44187	. CONVERSION KIT INDEX, BA 336C passenger
65-65900	. CONVERSION KIT INDEX, BA 379C passenger
65-63999	. CONVERSION KIT INDEX, BA 379C passenger
65-49199	. CONVERSION KIT INDEX, BN 327C passenger
65-63999	. CONVERSION KIT INDEX, BO 320C passenger
65-44440	. CONVERSION KIT INDEX, BO 385C passenger
65-70319	. CONVERSION KIT INDEX, BO 396C passenger
65-31466	. CONVERSION KIT INDEX, CO 321C passenger
65-42649	. CONVERSION KIT INDEX, CO 324C passenger
65-58555	. CONVERSION KIT INDEX, EG 365C passenger
65-65900	. CONVERSION KIT INDEX, EJ 355C passenger
65-63999	. CONVERSION KIT INDEX, EJ 355C passenger
65-65130	. CONVERSION KIT INDEX, ET 360C passenger
65-65900	. CONVERSION KIT INDEX, ET 360C passenger
65-63999	. CONVERSION KIT INDEX, ET 379C passenger

707

STUDENT TRAINING OVERHAUL MANUAL (UNCONTROLLED - USE ON LIVE AIRCRAFT PROHIBITED)

- 65-44301 . CONVERSION KIT INDEX, FT 349C passenger
- 65-69155 . CONVERSION KIT INDEX, GR 307C passenger
- 65-36895 . CONVERSION KIT INDEX, IN 348C passenger
- 65-70727 . CONVERSION KIT INDEX, KU 369C passenger
- 65-44186 . CONVERSION KIT INDEX, LH 330C passenger
- 65-73955 . CONVERSION KIT INDEX, LY 358C passenger
- 65-63990 . CONVERSION KIT INDEX, MS 366C passenger
- 65-36882 . CONVERSION KIT INDEX, NW 351C passenger
- 65-44188 . CONVERSION KIT INDEX, OA 384C passenger
- 65-31466 . CONVERSION KIT INDEX, PA 321C passenger
- 65-51888 . CONVERSION KIT INDEX, PK 340C passenger
- 65-57566 . CONVERSION KIT INDEX, QF 338C passenger
- 65-58555 . CONVERSION KIT INDEX, RD 365C passenger
- 65-63999 . CONVERSION KIT INDEX, RD 372C passenger
- 65-52300 . CONVERSION KIT INDEX, RG 341C passenger
- 65-65900 . CONVERSION KIT INDEX, RG 345C passenger
- 65-63999 . CONVERSION KIT INDEX, RG 345C passenger
- 65-64210 . CONVERSION KIT INDEX, SA 344C passenger
- 65-65900 . CONVERSION KIT INDEX, SB 345C passenger
- 65-63999 . CONVERSION KIT INDEX, SB 345C passenger
- 65-42149 . CONVERSION KIT INDEX, SN 329C passenger
- 65-65900 . CONVERSION KIT INDEX, ST 379C passenger
- 65-63999 . CONVERSION KIT INDEX, ST 379C passenger
- 65-65900 . CONVERSION KIT INDEX, SV 368C passenger
- 65-65999 . CONVERSION KIT INDEX, SV 368C passenger
- 65-64210 . CONVERSION KIT INDEX, TV 350C passenger
- 65-36885 . CONVERSION KIT INDEX, TW 331C passenger
- 65-33553 . CONVERSION KIT INDEX, TW 373C passenger
- 65-65935 . CONVERSION KIT INDEX, WA 347C passenger
- 65-65900 . CONVERSION KIT INDEX, WD 311C passenger
- 65-63999 . CONVERSION KIT INDEX, WD 311C passenger
- 65-33553 . CONVERSION KIT INDEX, WY 373C passenger
- 65-59998 . CONVERSION KIT INDEX, ZC 399C passenger

- 65-19171 . COVE LIP DOOR INSTL, Fillet flap -300B/C
- 65-19634 . COVE LIP DOOR INSTL, Inboard -300B/C
- 65-1069 . COVE LIP DOOR INSTL, Inboard -300/400
- 65-18726 . COVE LIP DOOR INSTL, Outboard -300B/C
- 5-89868 . COVE LIP DOOR INSTL, Outboard -300/400

- 65-1056 . DOOR INSTL, Landing gear section 16

- 50-5579 . ELECTRICAL INSTL, Outboard strut main gear
- 50-5525 . ELECTRICAL INSTL, Wing section 22

- 50-9301 . EQUIPMENT INSTL, Flyaway

- 65-22852 . FENCE INSTL, Fillet flap -300B/C

707

STUDENT TRAINING OVERHAUL MANUAL (UNCONTROLLED - USE ON LIVE AIRCRAFT PROHIBITED)

- 65-19169 . FLAP INSTL, Fillet -300B/C
- 65-1062 . FLAP INSTL, Fillet -300/400
- 65-19635 . FLAP INSTL, Inboard -300B/C
- 65-1061 . FLAP INSTL, Inboard -300/400
- 5-73132 . FLAP INSTL, Outboard

- 65-6088 . HORIZONTAL TAIL INSTL
 - . . CONTROL INSTL, (See separate listing)
 - . . ELECTRICAL INSTL, Empennage 331B 353B
 - . . ELEVATOR AND BALANCE ASSY AND INSTL, Section 84
 - . . REMOVABLE LEADING EDGE INSTL, Horizontal stabilizer
 - . . STRUCTURE ASSY, Stabilizer section 82

- 50-5592 . . ELECTRICAL INSTL, Empennage 331B 353B
- 50-9784 . . ELEVATOR AND BALANCE ASSY AND INSTL, Section 84
- 50-9783 . . REMOVABLE LEADING EDGE INSTL, Horizontal stabilizer
- 50-9782 . . STRUCTURE ASSY, Stabilizer section 82

- 50-6848 . HYDRAULIC INSTL, Wing
- 50-6849 . HYDRAULIC INSTL, Wing fillet

- 65-10615 . INDEX, Drawing numbers fan engine instl

- 69-54105 . INTERIOR INSTL, AA 323B passenger cabin
- 69-27371 . INTERIOR INSTL, AA 323C passenger cabin
- 69-39312 . INTERIOR INSTL, AA 385C passenger cabin
- 50-10235 . INTERIOR INSTL, AF 328-328B passenger cabin
- 69-33196 . INTERIOR INSTL, AF 328C passsenger cabin
- 50-10239 . INTERIOR INSTL, AI 337B, 437 passenger cabin
- 69-31340 . INTERIOR INSTL, AI 337C passenger cabin
- 69-34864 . INTERIOR INSTL, AR 387B passenger cabin
- 69-34864 . INTERIOR INSTL, AR 387C passenger cabin
- 69-51270 . INTERIOR INSTL, AV 359B passenger cabin
- 69-34776 . INTERIOR INSTL, BA 336C passenger cabin
- 69-53797 . INTERIOR INSTL, BA 379C passenger cabin
- 50-10240 . INTERIOR INSTL, BA 436 passenger cabin
- 69-34865 . INTERIOR INSTL, BN 327C passenger cabin
- 69-50277 . INTERIOR INSTL, BO 320C passenger cabin
- 69-34861 . INTERIOR INSTL, BO 385C passenger cabin
- 69-54104 . INTERIOR INSTL, BO 396C passenger cabin
- 69-23677 . INTERIOR INSTL, CO 321C passenger cabin
- 69-34141 . INTERIOR INSTL, CO 324C passenger cabin
- 69-39311 . INTERIOR INSTL, EG 365C passenger cabin
- 69-17783 . INTERIOR INSTL, EG(CEA) 465 passenger cabin
- 69-50849 . INTERIOR INSTL, EJ 355C passenger cabin
- 69-53797 . INTERIOR INSTL, EJ 355C passenger cabin
- 69-51969 . INTERIOR INSTL, ET 360C passenger cabin
- 69-53797 . INTERIOR INSTL, ET 379C passenger cabin
- 69-34862 . INTERIOR INSTL, FT 349C passenger cabin
- 69-54100 . INTERIOR INSTL, GR 307C passenger cabin
- 69-29541 . INTERIOR INSTL, IN 348C passenger cabin
- 69-54102 . INTERIOR INSTL, KU 369C passenger cabin
- 50-10238 . INTERIOR INSTL, LH 330B-430 passenger cabin
- 69-34858 . INTERIOR INSTL, LH 330C passenger cabin
- 69-34860 . INTERIOR INSTL, LY 358B passenger cabin

707

STUDENT TRAINING OVERHAUL MANUAL (UNCONTROLLED - USE ON LIVE AIRCRAFT PROHIBITED)

- 69-54106 . INTERIOR INSTL, LY 358C passenger cabin
- 65-14238 . INTERIOR INSTL, LY 458 passenger cabin
- 69-51968 . INTERIOR INSTL, ML 312B passenger cabin
- 69-51269 . INTERIOR INSTL, MS 366C passenger cabin
- 69-26188 . INTERIOR INSTL, NW 351B passenger cabin
- 69-29399 . INTERIOR INSTL, NW 351C passenger cabin
- 69-54103 . INTERIOR INSTL, OA 384B passenger cabin
- 69-34863 . INTERIOR INSTL, OA 384C passenger cabin
- 50-10230 . INTERIOR INSTL, PA 321-321B passenger cabin
- 69-23677 . INTERIOR INSTL, PA 321C passenger cabin
- 69-34867 . INTERIOR INSTL, PK 340C passenger cabin
- 69-31355 . INTERIOR INSTL, QF 338C passenger cabin
- 69-39311 . INTERIOR INSTL, RD 365C passenger cabin
- 69-53797 . INTERIOR INSTL, RD 372C passenger cabin
- 69-39310 . INTERIOR INSTL, RG 341C passenger cabin
- 50-10244 . INTERIOR INSTL, RG 345C-441 passenger cabin
- 65-1555 . INTERIOR INSTL, SA 344 passenger cabin
- 69-34703 . INTERIOR INSTL, SA 344B passenger cabin
- 69-51271 . INTERIOR INSTL, SA 344C passenger cabin
- 69-53797 . INTERIOR INSTL, SB 345C passenger cabin
- 50-10236 . INTERIOR INSTL, SN 329 passenger cabin
- 69-33195 . INTERIOR INSTL, SN 329C passenger cabin
- 69-53797 . INTERIOR INSTL, ST 379C passenger cabin
- 69-53797 . INTERIOR INSTL, SV 368C passenger cabin
- 69-34859 . INTERIOR INSTL, TP 382B passenger cabin
- 69-51271 . INTERIOR INSTL, TV 350C passenger cabin
- 50-10234 . INTERIOR INSTL, TW 331-331B passenger cabin
- 69-29161 . INTERIOR INSTL, TW 331C passenger cabin
- 69-25870 . INTERIOR INSTL, TW 373C passenger cabin
- 65-21276 . INTERIOR INSTL, US 353B passenger cabin
- 69-53738 . INTERIOR INSTL, WA 347C passenger cabin
- 69-53797 . INTERIOR INSTL, WD 311C passenger cabin
- 69-25870 . INTERIOR INSTL, WY 373C passenger cabin
- 69-39313 . INTERIOR INSTL, ZC 399C passenger cabin

- 65-10599 . KIT, Air conditioning and wing TAI duct instl inboard strut

- 65-27500 . MAIN GEAR INSTL, Section 61 -300C
- 50-5567 . . ELECTRICAL INSTL, Main gear
- 50-6852 . . HYDRAULIC INSTL, Main gear

- 65-1325 . MAIN LANDING GEAR INSTL, -300 300B 400
- 50-5567 . . ELECTRICAL INSTL, Main gear
- 50-6852 . . HYDRAULIC INST, Main gear

- 65-32028 . MAJOR DRAWING NUMBER INDEX, -400 power plant
- 65-3128 . MAJOR INDEX, Electrical cable instl

- 65-2000 . MARKING INSTL, Airplane maintenance exterior

STUDENT TRAINING OVERHAUL MANUAL
(UNCONTROLLED - USE ON LIVE AIRCRAFT PROHIBITED)

65-21886	. MARKING INSTL, AA 323B-323C decorative exterior
65-19046	. MARKING INSTL, AF 328-328B-328C decorative exterior
65-19045	. MARKING INSTL, AI 337B-437-337C decorative exterior
65-56840	. MARKING INSTL, AR 387B-387C decorative exterior
65-15514	. MARKING INSTL, AV 359B decorative exterior
65-50484	. MARKING INSTL, BA 336C-379C decorative exterior
65-19050	. MARKING INSTL, BA 436 decorative exterior
65-52380	. MARKING INSTL, BN 327C decorative exterior
65-45922	. MARKING INSTL, BO 320C-385C decorative exterior
65-2006	. MARKING INSTL, CO 321C-324C decorative exterior
65-69394	. MARKING INSTL, CO 324C decorative exterior
65-59889	. MARKING INSTL, EG 365C decorative exterior
65-21883	. MARKING INSTL, EG(CEA) 465 decorative exterior
65-63575	. MARKING INSTL, EJ 355C decorative exterior
65-15515	. MARKING INSTL, ET 360C-379C decorative exterior
65-45914	. MARKING INSTL, FT 349C decorative exterior
65-70702	. MARKING INSTL, GR 307C decorative exterior
65-21888	. MARKING INSTL, IN 348C decorative exterior
65-71133	. MARKING INSTL, KU 369C decorative exterior
65-19048	. MARKING INSTL, LH 330B-430-330C decorative exterior
65-15511	. MARKING INSTL, LY 358B-358C-458 decorative exterior
65-66251	. MARKING INSTL, ML 312B decorative exterior
65-69183	. MARKING INSTL, MS 366C decorative exterior
65-15512	. MARKING INSTL, NW 351B-351C decorative exterior
65-51386	. MARKING INSTL, OA 384B-384C decorative exterior
65-2001	. MARKING INSTL, PA 321-321B-321C decorative exterior
65-21881	. MARKING INSTL, PK 340C decorative exterior
65-39837	. MARKING INSTL, QF 338C decorative exterior
65-65238	. MARKING INSTL, RD 365C decorative exterior
65-71198	. MARKING INSTL, RD 372C decorative exterior
65-19051	. MARKING INSTL, RG 341C-345C-441 decorative exterior
65-19053	. MARKING INSTL, SA 344-344B-344C decorative exterior
65-68866	. MARKING INSTL, SB 345C decorative exterior
65-19047	. MARKING INSTL, SN 329-329C decorative exterior
65-69811	. MARKING INSTL, ST 379C decorative exterior
65-21884	. MARKING INSTL, SV 368C decorative exterior
65-47162	. MARKING INSTL, TP 382B decorative exterior
65-19053	. MARKING INSTL, TV 350C decorative exterior
65-2003	. MARKING INSTL, TW 331-331B 373C decorative exterior
65-21887	. MARKING INSTL, TW 331C decorative exterior
65-21880	. MARKING INSTL, US 353B decorative exterior
65-13329	. MARKING INSTL, WA 347C decorative exterior
65-68865	. MARKING INSTL, WD 311C decorative exterior
65-21885	. MARKING INSTL, WY 373C decorative exterior
65-60705	. MARKING INSTL, ZC 399C decorative exterior
65-13700	. MODIFICATION ENGINEERING DRAWING, 707-353B
D6-7001 Ser	. MODIFICATION REVISION DOCUMENT

707

STUDENT TRAINING OVERHAUL MANUAL (UNCONTROLLED - USE ON LIVE AIRCRAFT PROHIBITED)

- 65-1326 . NOSE GEAR INSTL, Section 62 -300-300B-400
- . . CONTROL INSTL, (See separate listing)
- 50-5566 . . ELECTRICAL INSTL, Nose gear
- 5-87168 . . HYDRAULIC INSTL, Nose gear steering

- 65-27501 . NOSE GEAR INSTL, Section 62 -300C
- . . CONTROL INSTL, (See separate listing)
- 50-5566 . . ELECTRICAL INSTL, Nose gear
- 65-29305 . . HYDRAULIC INSTL, Nose gear steering

- 65-3277-15PI . PI MAJOR INDEX, Lining and insulation instl
- 65-3128 . PI MAJOR INDEX, Tubing instl

- 65-2447 . POWER PLANT INSTL, -300
- 65-2479 . . CONTROL INSTL, Engine start system nacelle
- 65-2471 . . CONTROL INSTL, Engine throttle
- 65-2453 . . COWL INSTL, Engine nacelle
- 65-2476 . . ENGINE MOUNT INSTL
- 65-2468 . . EQUIPMENT INSTL, Engine electrical
- 65-2467 . . NOSE COWL ASSY, Engine nacelle
- 65-2481 . . NOSE DOME INSTL, Engine
- 65-2477 . . PLUMBING INSTL, Engine
- 65-2446 . . POWER PACK ASSY

- 65-10600 . POWER PLANT INSTL, -300B C (see INDEX)
- 65-19045 . POWER PLANT INSTL, -400 (see MAJOR)

- D6-7000 Ser . RAPID REVISION DOCUMENT

- 65-1066 . SPOILER INSTL, Wing

- D6-15743 Ser . STANDARD AIRPLANE SPECIAL FEATURES DRAWING INDEX

- 65-2504 . STRUT INSTL, Inboard nacelle -300
- 65-2512 . . AIR CONDITIONING AND TAI DUCT INSTL, Inboard strut
- 69-2005 . . DIAGONAL BRACE, -300
- 65-2511 . . ELECTRICAL INSTL, Inboard strut
- 65-2517 . . ENGINE CONTROL INSTL, Inboard nacelle strut
- 65-2514 . . FIRE DETECTOR INSTL, Inboard strut
- 65-2516 . . INBOARD STRUT ASSY, Nacelle
- 65-2485 . . MID FAIRING INSTL, Engine nacelle strut -300
- 5-87839 . . PANEL INSTL, Inboard nacelle strut wing access -300
- 65-2513 . . PLUMBING INSTL, Inboard nacelle strut
- 65-2505 . . REAR ENGINE MOUNTING, -300
- 65-2510 . . STRUT ASSY, Equipment inboard nacelle
- 5-85626 . . TRAILING EDGE FAIRING, -300
- 65-2598 . . VALVE AND TUBING INSTL, Fire extinguisher

- 65-10616 . STRUT INSTL, Inboard nacelle -300B/C (see INDEX)

707

STUDENT TRAINING OVERHAUL MANUAL (UNCONTROLLED - USE ON LIVE AIRCRAFT PROHIBITED)

- 50-8229 . STRUT INSTL, Inboard nacelle -400
- 50-8251 . . DUCT INSTL, TAI and CAC system inboard strut
- 50-5577 . . ELECTRICAL INSTL, Inboard strut
- 65-2113 . . FIRE DETECTOR INSTL
- 5-85617 . . INBOARD STRUT ASSY, Nacelle
- 50-5547 . . PLUMBING INSTL, Inboard nacelle strut
- 50-8227 . . STRUT ASSY, Inboard nacelle equipment

- 65-2482 . STRUT INSTL, Outboard nacelle -300
- 65-2489 . . AIR CONDITIONING AND WING TAI DUCT INSTL, Outboard nacelle
- 65-2578 . . CONTROL INSTL, Thrust reverser outboard strut
- 69-2006 . . DIAGONAL BRACE, -300
- 65-2491 . . ELECTRICAL INSTL, Outboard strut
- 65-2493 . . ENGINE CONTROL INSTL
- 65-2492 . . FIRE DETECTOR INSTL
- 65-2485 . . MID FAIRING INSTL, Engine nacelle strut -300
- 65-2494 . . OUTBOARD STRUT STRUCTURE ASSY, Nacelle
- 5-88792 . . PANEL INSTL, Strut to wing access outboard nacelle
- 65-2490 . . PLUMBING INSTL
- 65-2505 . . REAR ENGINE MOUNTING, -300
- 65-2488 . . STRUT ASSY, Equipment
- 5-85636 . . TRAILING EDGE FAIRING, -300

- 65-10617 . STRUT INSTL, Outboard nacelle-300B C (see INDEX)

- 50-8230 . STRUT INSTL, Outboard nacelle -400
- 65-74081 . . AIR CONDITIONING AND WING TAI DUCT INSTL, Outboard strut (LY)
- 50-8251 . . DUCT INSTL, TAI and CAC system inboard strut
- 50-5579 . . ELECTRICAL INSTL, Outboard strut
- 65-1765 . . FIRE DETECTOR INSTL
- 5-85627 . . OUTBOARD STRUT ASSY
- 50-5548 . . PLUMBING INSTL, Outboard nacelle strut
- 50-8228 . . STRUT ASSY, Outboard nacelle equipment

- 65-12700 . TOP MODIFICATION DRAWING

- 65-12752 . VENTRAL FIN INSTL, Section 49 (2001-5599)

- 65-8624 . VERTICAL TAIL INSTL
- . . CONTROL INSTL, (See separate listing)
- 50-5592 . . ELECTRICAL INSTL, Empennage
- 50-6892 . . ELECTRONIC INSTL, Section 92
- 65-13327 . . EXTENSION ASSY, Vertical tail
- 5-72324 . . FAIRING ASSY, Fin-body
- 50-8285 . . FIN ASSY
- 65-8643 . . HYDRAULIC INSTL, Empennage
- 65-8367 . . INTERSPAR AND TRAILING EDGE ASSY, Vertical tail

STUDENT TRAINING OVERHAUL MANUAL
(UNCONTROLLED - USE ON LIVE AIRCRAFT PROHIBITED)

5-71787 . . LEADING EDGE INSTL, Vertical tail
50-9788 . . RUDDER AND BALANCE ASSY, Vertical tail
65-3495 . . RUDDER ASSY, Vertical tail
65-3775 . . SNUBBER INSTL, Rudder station 4, 15
50-11379 . . TIP INSTL, Vertical tail
65-13328 . . VERTICAL TAIL ASSY

65-1000-3 . . WING ASSY, Inboard
65-14060 . . BOTTLE INSTL, Fire extinguisher inboard section 77-40
65-14059 . . BOTTLE INSTL, Fire extinguisher outboard section 79-4
50-11337 . . BOTTLE INSTL, Fire extinguisher section 77
50-6878 . . CONTROL INSTL, Pressure fueling section 22
65-3117 . . CONTROL SYSTEM INSTL, Cabin pressurization
65-19543 . . DUCT INSTL, Cabin air conditioning wing leading edge
section 22 -300B/C
65-20860 . . DUCT INSTL, Cabin air conditioning wing leading edge
section 22 -300B/C
65-7045 . . DUCT INSTL, Cabin air conditioning wing leading edge
section 22 -300/400
65-32550 . . DUCT INSTL, Cabin air wing leading edge section 22
-300B/C
65-18185 . . DUCT INSTL, TAI -300B/C
65-18771 . . DUCT INSTL, TAI wing leading edge -300B/C
65-19397 . . DUCT INSTL, TAI wing leading edge -300B/C
65-32546 . . DUCT INSTL, TAI wing leading edge -300B/C
65-12289 . . DUCT INSTL, TAI wing leading edge -300/300B/400
50-9324 . . DUCT INSTL, TAI wing leading edge -300/400
65-1199 . . DUCT INSTL, TAI wing leading edge -300/400
65-10054 . . DUCT INSTL, TAI wing leading edge -300/400
65-6842 . . DUCT INSTL, Wing TAI -300/400
65-15541 . . DUMP CHUTE INSTL, Retract fuel jettison
65-4095 . . EQUIPMENT INSTL, Fuel tank section 22
65-20717 . . FRONT SPAR INSTL, Section 12 -300B/C
64-1001 . . FRONT SPAR INSTL, Wing center section
65-18184 . . LEADING EDGE INSTL, -300B/C
65-18445 . . LEADING EDGE INSTL, Inboard wing -300B/C
65-1071 . . LEADING EDGE INSTL, Section 14 -300/300B/400
50-5563 . . LEADING EDGE INSTL, Section 14 -300/400
65-1005 . . LEADING EDGE INSTL, Section 14 -300/400
65-31993 . . LEADING EDGE INSTL, Wing inboard section 14 -300B/C
65-1024 . . LOWER PANEL INSTL, Section 11
65-1041 . . PANEL INSTL, Upper wing section 12
65-1047 . . PANEL INSTL, Wing lower section 12
65-56068 . . PROBE INSTL, Fuel tank center wing
65-6169 . . PROBE INSTL, Fuel tank center wing -300/400
65-6171 . . PROBE INSTL, Fuel tank #2 and #3
65-6170 . . PROBE INSTL, Fuel tank main #1 and #4
64-1026 . . REAR SPAR INSTL, Section 16
64-1002 . . REAR SPAR INSTL, Wing center section

707

STUDENT TRAINING OVERHAUL MANUAL (UNCONTROLLED - USE ON LIVE AIRCRAFT PROHIBITED)

- 64-1025 . . SPAR INSTL, Front inboard wing
- 65-1004 . . STRUCTURE ASSY, Wing inboard section 12, 14 and 16
- 65-1100 . . STRUCTURE INSTL, Inboard wing section 16
- 65-4088 . . SYSTEM INSTL, Fuel Jettison -300/400
- 65-2027 . . TANK INSTL, Fuel center wing tank
- 65-1138 . . TORQUE BOX INSTL, Landing gear support
- 65-19168 . . TRAILING EDGE INSTL, Wing fillet -300B/C
- 64-1182 . . TRAILING EDGE INSTL, Wing fillet 300/400
- 65-3673 . . TRAILING EDGE INSTL, Wing fillet rear spar
- 65-4092 . . TUBING INSTL, Engine fuel feed section 22
- 65-1636 . . TUBING INSTL, Fire extinguisher section 24
- 65-8913 . . TUBING INSTL, Fuel air starter section 24
- 65-6126 . . TUBING INSTL, Fuel crossfeed section 21
- 65-25531 . . TUBING INSTL, Fuel jettison section 22 -300B/C
- 65-4087 . . TUBING INSTL, Fuel jettison section 22 -300/400
- 50-6848 . . TUBING INSTL, Hydraulics wing
- 65-16092 . . TUBING INSTL, Pressure fueling -300/400
- 65-4089 . . TUBING INSTL, Pressure fueling section 22 and 23
- 65-19469 . . TUBING INSTL, Water injection section 22 -300B/C
- 65-1022 . . UPPER PANEL INSTL, Section 11
- 65-4091 . . VENT INSTL, Fuel tank section 12
- 65-1003 . . WING ASSY, Inboard section 12, 14 and 16
- 65-1001 . . WING CENTER SECTION ASSY, Section 11
- 65-1002 . . WING CENTER SECTION STRUCTURAL ASSY, Section 11

- 50-5305 . . WING ASSY, Outboard section 13, 15 and 17
- . . CONTROL INSTL, (See separate listing)
- 69-5341 . . DRIP FENCE INSTL, Section 19
- 65-19397 . . DUCT INSTL, TAI wing leading edge section 25 -300B/C
- 50-9324 . . DUCT INSTL, TAI wing leading edge
- 5-86591 . . EQUIPMENT INSTL, Wing fuel tank
- 5-86592 . . GAGE INSTL, Reserve tank
- 65-18460 . . LEADING EDGE INSTL, Section 15 -300B/C
- 50-8260 . . LEADING EDGE INSTL, Section 15 -300/400
- 65-28778 . . PANEL INSTL, Lightning shield outboard wing
- 50-8211 . . PANEL INSTL, Wing lower outboard
- 5-85602 . . PANEL INSTL, Wing upper outboard
- 5-88479 . . SPAR INSTL, Front outboard section 13 -300/400
- 65-18474 . . SPAR INSTL, Front outboard wing -300B/C
- 5-88480 . . SPAR INSTL, Rear section 17
- 50-5306 . . STRUCTURE ASSY, Outboard wing section 13, 15 and 17
- 5-73117 . . STRUCTURE INSTL, Wing outboard section 17
- 65-7111 . . TUBING INSTL, Pressure fueling -300/400
- 50-5357 . . TUBING INSTL, Pressure fueling section 22 and 23
- 50-5358 . . VENT INSTL, Wing fuel tank section 23
- 50-5305 . . WING ASSY, Section 13, 15 and 17 outboard -300/400
- 65-18282 . . WING TIP INSTL AND ASSY, Section 19 -300B/C
- 5-73119 . . WING TIP INSTL, Section 19 -300/400

- 65-17000 . . WIRE BUNDLE INDEX
- 50-6850 . . WIRING DIAGRAM AND LOAD ANALYSIS

707

STUDENT TRAINING OVERHAUL MANUAL (UNCONTROLLED - USE ON LIVE AIRCRAFT PROHIBITED)

FILTER MAINTENANCE KIT LISTING

KIT NUMBER FOR:		KIT CONTENT	QTY
63B10463-20	RESERVOIR PRESSURIZATION MODULE	NAS1611-012	1
		NAS1611-115	1
	732-11240-01 (BAC SPEC 60B00226-3)	NAS1611-216	1
	732-11240-02 (BAC SPEC 60B00226-5)		
65-90305-10	AIR PRESSURE FILTER	NAS1611-011	1
		(OPTIONAL P/Ns: 57694-6, 7502541)	
57693	(BAC SPEC 10-3202-1)	NAS1612-8	1
		(OPTIONAL P/Ns: 57696-8, 7502528)	
65-90305-11	HYDRAULIC RESERVOIR, AIRVENT	BACE18A1	1
		(OPTIONAL P/Ns: 574096, 57738)	
574315	(BAC SPEC BACF18B1)	NAS1611-222	1
57727	(BAC SPEC BACF18B1)	(OPTIONAL P/N: 7502562)	
		NAS1612-20	1
		(OPTIONAL P/N: 051051)	
65-90305-12	SYSTEM A, B & STANDBY HYD PUMP	MS28774-220	2
	CASE DRAIN FILTER MODULE	MS28782-25	2
		NAS1611-114	1
053034	(BAC SPEC 10-60555-3)	NAS1611-220	1
7551868	(BAC SPEC 10-60555-3)	NAS1612-2	1
7585147	(BAC SPEC 10-60555-11)	NAS1612-5	1
		10-60555-5	1

707

STUDENT TRAINING OVERHAUL MANUAL (UNCONTROLLED - USE ON LIVE AIRCRAFT PROHIBITED)

FILTER MAINTENANCE KIT LISTING

KIT NUMBER FOR:	KIT CONTENT	QTY
65-90305-14A		
SYSTEM B RETURN FILTER	NAS1611-136	1
	NAS1611-214	1
7505639 (BAC SPEC 10-60565-4)	10-60569-1	1
65-90305-15		
SYSTEM A & B HYD PRESSURE MODULE	MS28782-19	2
	NAS1611-214	2
65-17821-3,-4,-5,-6,-7,-8,-9, -10,-11,-12,-13,-14,-15,-17, -18,-20	NAS1611-228	2
	S12766-228	4
	(OPTIONAL P/Ns: BACR12BM228, MS28783-6)	
	10-60592-5	2
	(OPTIONAL P/Ns: 10-60592-1,-6)	
65-90305-16		
HYD SYS B PRESSURE MODULE AY	BACR12BM226	4
	(OPTIONAL P/N: S12766-226)	
65-17822-6	MS28782-17	2
	NAS1611-212	2
	NAS1611-226	2
	10-60592-2	2
65-90305-17		
STANDBY SYSTEM PRESSURE MODULE	MS28782-17	1
	NAS1611-212	1
65-44681-3,-4,-5,-6,-9, -10,-11,-15,-16	NAS1611-226	1
	S12766-226	2
	10-60592-2	1

707

STUDENT TRAINING OVERHAUL MANUAL (UNCONTROLLED - USE ON LIVE AIRCRAFT PROHIBITED)

FILTER MAINTENANCE KIT LISTING

KIT NUMBER FOR:	KIT CONTENT	QTY
65-90305-18 JT8D FUEL PUMP FILTER	C1308PL	1
371900	(OPTIONAL P/N: 6667621)	
378200	MS24665-157	1
384300	(OPTIONAL P/N: AN381-2-20)	
	MS29513-013	1
	MS29513-241	1
65-90305-19 JT8D FUEL CONTROL INLET FILTER	575776	2
712334-1	69490D127	1
	69490D128	1
	69890-1	1
	69890-27	1
65-90305-20 CSD LINE FILTER	MS28782-19	1
7500203	MS29561-214	1
	MS29561-228	1
65-90305-20A CSD LINE FILTER	M83248-1-228	1
7581418	7579077	1
65-90305-20B CSD LINE FILTER	M83248-1-228	1
7586890	7583141	1
	(OPTIONAL P/Ns: AC9780F15, AC9780F215, 57880, 57921, 7583142)	

707

STUDENT TRAINING OVERHAUL MANUAL (UNCONTROLLED - USE ON LIVE AIRCRAFT PROHIBITED)

FILTER MAINTENANCE KIT LISTING

KIT NUMBER FOR:		KIT CONTENT	QTY
65-90305-21A			
	CSD INTEGRAL OIL FILTER	MS17413-014	1
		(OPTIONAL P/N: M83248-1-014)	
699647	(BAC SPEC 10-61223-2)	MS17413-018	1
735511A	(BAS SPEC 10-61066-11)	(OPTIONAL P/N: M83248-1-018)	
		MS17413-128	1
		(OPTIONAL P/N: M83248-1-128)	
		7578137-101	1
		(OPTIONAL P/Ns: AC9649F1, 055916-04, 55956)	
65-90305-23			
	JT8D MAIN OIL FILTER 175 MICRON	MS9387-08	1
		MS9388-236	1
	494378		
	541556		
	699146		
65-90305-24			
	APU OIL PUMP FILTER	S9413-227	1
		76149	1
	379580-()	(OPTIONAL P/Ns: 3001436-1, 7500291)	
65-90305-25			
	APU LOW PRESSURE FUEL FILTER	MS28774-222	1
		(OPTIONAL P/N: 910786)	
	1732945-01 (BAC SPEC 10-61801-1)	MS29513-114	1
		(OPTIONAL P/N: 7516)	
		MS29513-222	1
		(OPTIONAL P/N: 7514)	
		038062	1

707

STUDENT TRAINING OVERHAUL MANUAL (UNCONTROLLED - USE ON LIVE AIRCRAFT PROHIBITED)

FILTER MAINTENANCE KIT LISTING

KIT NUMBER FOR:	KIT CONTENT	QTY
65-90305-26A APU FUEL CONTROL FILTER	S9413-012	1
	S9413-120	1
124536-17-1,-23-1,-34-1,-38-1, -39-1	7507227	1
3602310-5-1,-17-1,-20-1 THRU -30-1	(OPTIONAL P/Ns: 038054,	
3609150-1	337-501-9002, 8110-4)	
65-90305-27 JT8D MAIN OIL STRAINER 40 MICRON	MS9387-08	1
	MS9388-026	1
642394	MS9388-131	1
663577	MS9388-236	1
699151		
65-90305-28 SAFETY RELIEF VALVE	69490B236	1
	79030	1
720737-2 (BAC SPEC 10-61209-11)	(OPTIONAL P/Ns: 15-79030,	
720737-4 (BAC SPEC 10-61209-21)	715942-1)	
720737-5 (BAC SPEC 10-61209-23)		
65-90305-29 AC WATER SEPARATOR COALESCER	S9027E267	2
183010-2,-3,-4		
65-90305-31 HYD GRND SERVICE MODULE FILTER	MS28782-19	1
	NAS1611-214	1
65-44981-5	NAS1611-228	1
	S12766-228	2
	10-60592-5	1
	(OPTIONAL P/Ns: 10-60592-1,-6)	

707

STUDENT TRAINING OVERHAUL MANUAL (UNCONTROLLED - USE ON LIVE AIRCRAFT PROHIBITED)

FILTER MAINTENANCE KIT LISTING

KIT NUMBER FOR:		KIT CONTENT	QTY
65-90305-32	POTABLE WATER PRESSURIZATION AIR FILTER	MS28775-216 (OPTIONAL P/N: 571611)	1
1732510		038057-00-51 (OPTIONAL P/N: 038057-00-81)	1
65-90305-33	HYD RSVR PRESSURE FILLING FILTER	MS28774-114	1
		MS28774-128	2
AC7680-6	(BAC SPEC 10-60595-1)	MS28774-223	2
7551901	(BAC SPEC 10-60595-1)	MS28782-12	1
		NAS1611-114	1
		NAS1611-128	1
		NAS1611-223	1
		10-60595-2	1
65-90305-35	JT8D MAIN OIL FILTER 15 MICRON	MS9387-08	1
		MS9388-030	1
		MS9388-236	1
		717126	1
		(OPTIONAL P/Ns: 710171, 727694, 731085, 741259, 761417, 761418)	
65-90305-38	APU DIFFERENTIAL AIR PRESSURE REGULATOR FILTER	S8990-018	1
		S8990-115	1
108032-3,-6		050554-2	1
65-90305-38A	APU BLEED AIR PRESSURE REGULATOR FILTER	S8990-115	1
		050554-2	1
108032-8,-9			

707

STUDENT TRAINING OVERHAUL MANUAL (UNCONTROLLED - USE ON LIVE AIRCRAFT PROHIBITED)

FILTER MAINTENANCE KIT LISTING

KIT NUMBER FOR:		KIT CONTENT	QTY
65-90305-40A			
	PTU PRESSURE FILTER MODULE	BACR12BP228	1
		MS28774-214	1
7552355	(BAC SPEC 10-3337-7)	NAS1611-214	1
		NAS1611-228	1
		10-60592-5	1
		(OPTIONAL P/Ns: 10-60592-1,-6)	
65-90305-58			
	HYD SYS A, B & STBY CASE DRAIN FILTER MODULE	MS28782-25	2
		NAS1611-114	1
		NAS1611-220	1
7579078	(BAC SPEC 10-60555-7)	10-60555-8	1
65-90305-59			
	CFM56-3 MAIN OIL SUPPLY FILTER	649-393-033-0	2
		(OPTIONAL P/N: J221P033)	
		649-393-148-0	1
		(OPTIONAL P/N: J221P148)	
		649-393-904-0	1
		(OPTIONAL P/N: J221P904)	
65-90305-60			
	CFM56-3 SCAVENGE OIL FILTER	M83248-1-026	1
		M83248-1-239	1
		(OPTIONAL P/N: MS9388-239)	
		QA03545	1

707

STUDENT TRAINING OVERHAUL MANUAL (UNCONTROLLED - USE ON LIVE AIRCRAFT PROHIBITED)

FILTER MAINTENANCE KIT LISTING

KIT NUMBER FOR:	KIT CONTENT	QTY
65-90305-61 CFM56-3 FUEL PUMP FILTER	ACB006F2474Y3 (OPTIONAL P/Ns: C8205, 215174, 217415)	1
708300-1,-2	AN960-416L	6
708600-1	M25988-1-123	2
	M25988-1-156	1
	M25988-1-906	1
65-90305-9 SYSTEM A RETURN 2 STAGE FILTER	NAS1611-143	2
	NAS1611-214	1
AE7693-127N2 (BAC SPEC 10-60593-1)	NAS1611-242	1
	RR381S	1
	10-60593-2	1
	10-60593-3	1
65-90305-9A SYSTEM A & B RETURN FILTER	NAS1611-242	1
	10-60593-11	1
AE7693-127N2 (BAC SPEC 10-60593-1)	(OPTIONAL P/Ns:	
AE7693-128 (BAC SPEC 10-60593-10)	10-60593-4,	
7579560 (BAC SPEC 10-60593-8)	10-60593-12)	
7583695 (BAC SPEC 10-60593-9)		