

**BOEING**  
 707  
**PARTS CATALOG (MAINTENANCE)**

CHAPTER 79

OIL

TABLE OF CONTENTS

SECTION	FIGURE
<b>79-01 ENGINE OIL SYSTEM</b>	
BREATHER INSTL, FAN ENGINE . . . . .	12
BULB INSTL, JT3D1 ENGINE OIL INLET TEMPERATURE . . . . .	12
DOOR INSTL, ENGINE OIL TANK FILLER. . . . .	13
DRAIN INSTL, FAN ENGINE . . . . .	6
PLUMBING INSTL, FAN ENGINE EDISON OIL PRESSURE TRANSMITTER. . . . .	4
PLUMBING INSTL, FAN ENGINE U.S. GAGE OIL PRESSURE TRANSMITTER . . . . .	2
<b>79-02 OIL INDICATING</b>	
MODULE INSTL, CAPTAINS AND FIRST OFFICERS . . . . .	37F
PANEL INSTL, FLIGHT ENGINEERS LOWER . . . . .	16K
PANEL INSTL, FLIGHT ENGINEERS LOWER . . . . .	16M
SPARES ASSY, OIL PRESSURE TRANSMITTER AND SWITCH. . . . .	4
SWITCH INSTL, FAN ENGINE OIL PRESSURE . . . . .	5
TANK UNIT INSTL, FAN ENGINE OIL QUANTITY. . . . .	2
TRANSMITTER AND SWITCH INSTL, FAN ENGINE OIL PRESSURE . . . . .	5
TRANSMITTER AND SWITCH INSTL, OIL PRESSURE. . . . .	4

**BOEING** *707*  
*Intercontinental*   
**PARTS CATALOG**

**SECTION 01**  
**ENGINE OIL SYSTEM**

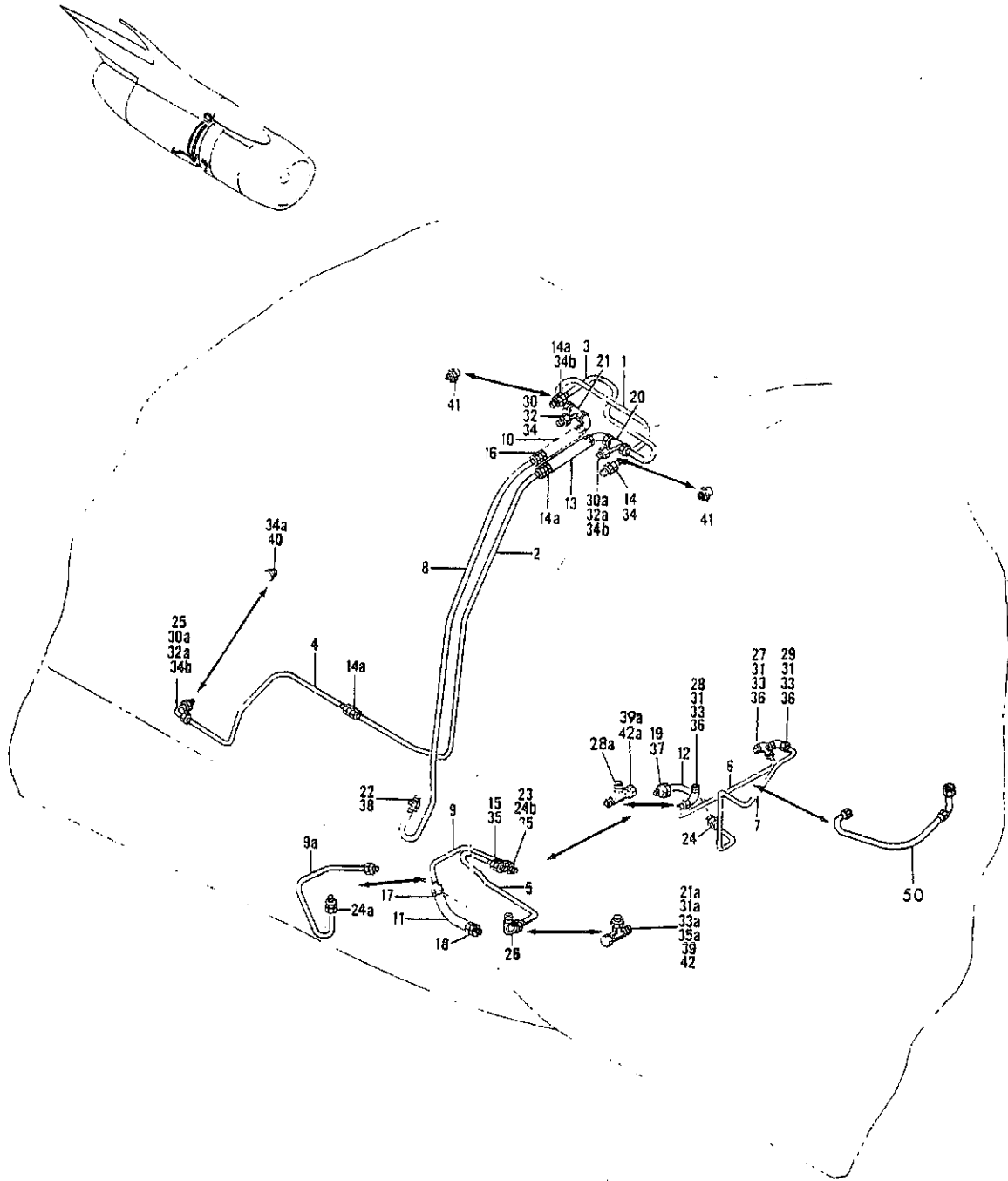

FIGURE 2 PLUMBING INSTL, FAN ENGINE U. S. GAGE OIL PRESSURE TRANSMITTER (OIL ONLY)



PARTS CATALOG

FIGURE & ITEM NO.	MANUFACTURER'S PART NUMBER	NOMENCLATURE	EFF	UNITS
			FROM TO	PER ASSY
2	65-11687-246	PLUMBING INSTL, FAN ENGINE U.S. GAGE OIL PRESSURE . . . TRANSMITTER (SEE 71-1, FIG. 5E, ITEM 47, 71-1, FIG. 5G, ITEM 42 AND 71-1, FIG. 5H, ITEM 37)	0150	RF
1	65-11687-130	. TUBE ASSY, OIL PRESSURE 1/4 .028 AISI304 (OPTIONALS . AISI321, AISI347)	0150	1
6	65-11687-209	. TUBE ASSY, OIL PRESSURE 1/4 .035 AISI304 (OPTIONALS . AISI321, AISI347)	0150	1
7	65-11687-210	. TUBE ASSY, OIL PRESSURE 1/4 .035 AISI304 (OPTIONALS . AISI321, AISI347)	0150	1
	MS21921-4	. . . NUT . . . . .	0150	2
	MS21922-4	. . . SLEEVE . . . . . (OPTIONAL BAC513AP4)	0150	2
8	65-11687-888	. TUBE ASSY, OIL PRESSURE 3/8 .035 AISI304 (OPTIONALS . AISI321, AISI347)	0150	1
	MS21921-6	. . . NUT . . . . .	0150	2
	MS21922-6	. . . SLEEVE . . . . . (OPTIONAL BAC513AP6)	0150	2
10	10-60543-7	. HOSE ASSY . . . . .	0150	1
12	10-60543-7	. HOSE ASSY, OIL PRESSURE TRANSMITTER . . . . .	0150	1
14	MS21902-4	. UNION . . . . .	0150	1
16	MS21902-6	. UNION . . . . .	0150	1
19	462W1003	. UNION, (V92003) . . . . .	0150	1
21	ER834-060404	. TEE, REDUCER (V88334) . . . . .	0150	1
22	MS21916-12-6	. REDUCER . . . . .	0150	1
24	MS21916-6-4	. REDUCER . . . . .	0150	1
27	MS21908-4	. ELBOW . . . . .	0150	1
28	2660070	. ELBOW, (V92003) . . . . . (OPTIONAL 2-01533-4 (V70195))	0150	1
28	2-01533-4	. ELBOW, (V70195) . . . . . (OPTIONAL TO 2660070 (V92003))	0150	1
29	MS21926-4	. ELBOW . . . . .	0150	1
30	AN6289-4	. NUT . . . . .	0150	1
31	AN6289-4	. NUT . . . . .	0150	3
32	MS28777-4	. RING . . . . .	0150	1
33	MS28777-4	. RING . . . . .	0150	3
34	BACG10U4	. GASKET . . . . .	0150	2
36	BACG10U4	. GASKET . . . . .	0150	3
38	BACG10U12	. GASKET . . . . .	0150	1
40	MS21913-8	. PLUG . . . . .	0150	1
41	66-13955-875	. PORT, HYDRAULIC PUMP DRAIN (ALTERED FROM MS21902-4C . OR MS21902-4S) (OPTIONAL 66-13955-1 (ALTERED FROM MS21902-4C OR MS21902-4S))	0150	2
41	66-13955-1	. PORT, HYDRAULIC PUMP DRAIN (ALTERED FROM;MS21902-4C . OR;MS21902-4S) (OPTIONAL TO 66-13955-875 (ALTERED FROM;MS21902-4C OR;MS21902-4S))	0150	2

MISSING ITEM NUMBERS ARE NOT APPLICABLE

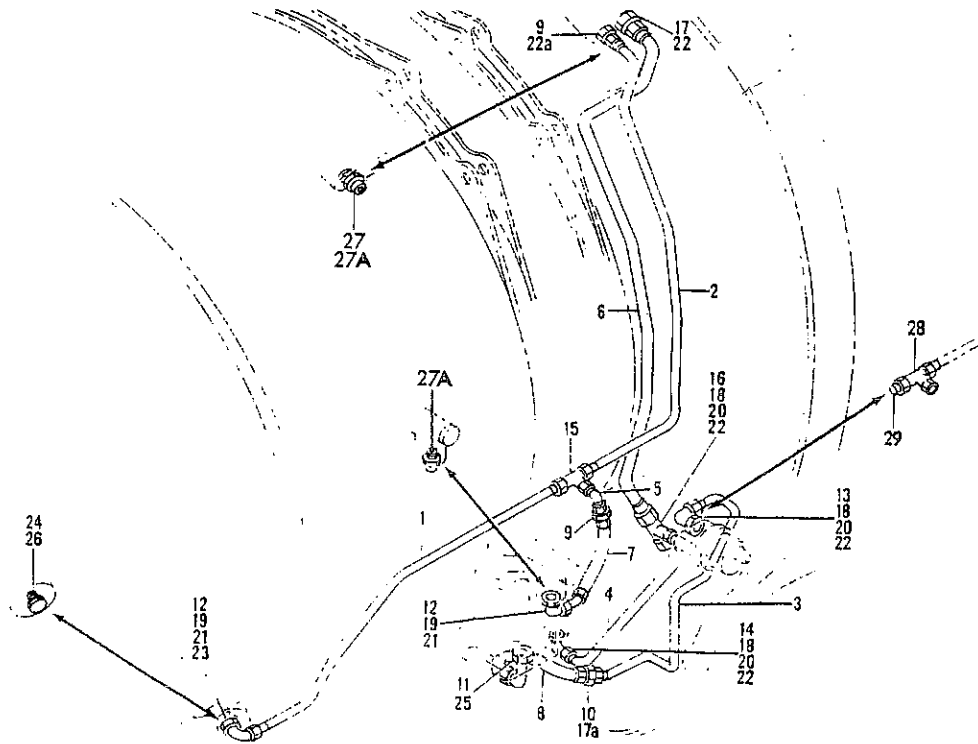
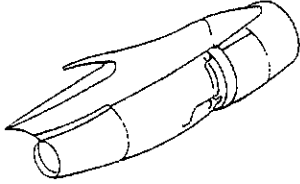

FIGURE 4. PLUMBING INSTL, FAN ENGINE (OIL ONLY)



PARTS CATALOG

FIGURE & ITEM NO.	MANUFACTURER'S PART NUMBER	NOMENCLATURE							EFF FROM TO	UNITS PER ASSY
		1	2	3	4	5	6	7		
4	65-11687-245	PLUMBING INSTL, FAN ENGINE EDISON OIL PRESSURE. . . . .							5199	RF
		TRANSMITTER (SEE 71-1, FIG. 5E, ITEM 47, 71-1, FIG. 5G, ITEM 42 AND 71-1, FIG. 5H, ITEM 37)								
3	65-11687-210	. TUBE ASSY, OIL PRESSURE 1/4 .035 AISI304 (OPTIONALS . . . . .							5199	1
		. AISI321, AISI347)								
4	65-11687-209	. TUBE ASSY, OIL PRESSURE 1/4 .035 AISI304 (OPTIONALS . . . . .							5199	1
		. AISI321, AISI347)								
	BACS13AP4	. . . SLEEVE. . . . .							5199	2
		. (OPTIONAL MS21922-4)								
	MS21922-4	. . . SLEEVE. . . . .							5199	2
		. (OPTIONAL TO BACS13AP4)								
	MS21921-4	. . . NUT . . . . .							5199	2
6	65-11687-208	. TUBE ASSY, OIL PRESSURE 3/8 .035 AISI304 (OPTIONALS . . . . .							5199	1
		. AISI321, AISI347)								
	BACS13AP6	. . . SLEEVE, (OPTIONAL MS21922-6). . . . .							5199	2
	MS21921-6	. . . NUT . . . . .							5199	2
8	10-60543-7	. HOSE ASSY, OIL PRESSURE TRANSMITTER . . . . .							5199	1
11	462W1003	. UNION, (V92003) . . . . .							5199	1
13	MS21926-4	. ELBOW . . . . .							5199	1
14	2660070	. ELBOW, (V92003) . . . . .							5199	1
		. (OPTIONAL 2-01533-4 (V70195))								
14	2-01533-4	. ELBOW, (V70195) . . . . .							5199	1
		. (OPTIONAL TO 2660070 (V92003))								
16	ER834-060404	. TEE, (V88334) . . . . .							5199	1
17	MS21916-6-4	. REDUCER . . . . .							5199	1
17A	MS21916-6-4	. REDUCER . . . . .							5199	1
18	AN6289-4	. NUT . . . . .							5199	3
20	MS28777-4	. RING. . . . .							5199	3
22	BACG10U4	. GASKET. . . . .							5199	4
22A	BACG10U4	. GASKET. . . . .							5199	1
25	BACG10U5	. GASKET. . . . .							5199	1
27	66-13955-875	. PORT, HYDRAULIC PUMP DRAIN (ALTERED FROM MS21902-4C . . . . .							5199	1
		. OR MS21902-4S)								
		. (OPTIONAL 66-13955-1)								
27	66-13955-1	. PORT, HYDRAULIC PUMP DRAIN (ALTERED FROM MS21902-4C . . . . .							5199	1
		. OR MS21902-4S)								
		. (OPTIONAL TO 66-13955-875)								

MISSING ITEM NUMBERS ARE NOT APPLICABLE

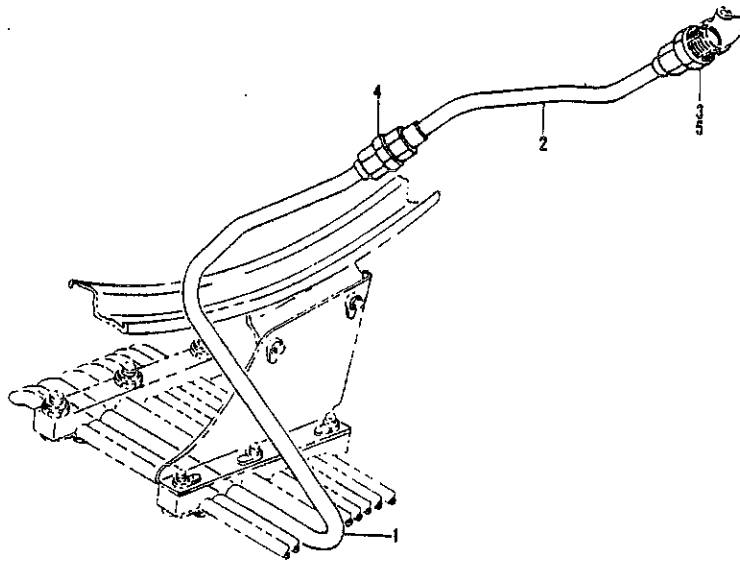
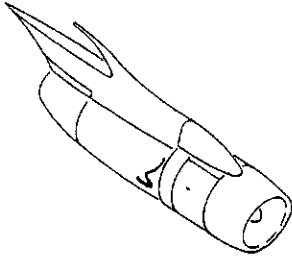

FIGURE 6. DRAIN INSTL, FAN ENGINE (OIL ONLY)



**PARTS CATALOG**

FIGURE & ITEM NO.	MANUFACTURER'S PART NUMBER	NOMENCLATURE							EFF FROM TO	UNITS PER ASSY	
		1	2	3	4	5	6	7			
R R R R R	65-11660-89	DRAIN INSTL, FAN ENGINE (OIL ONLY) (SEE 71-1, FIG. 5E, ITEM 53, 71-1, FIG. 5G, ITEM 48 AND 71-1, FIG. 5H, ITEM 41)							0150	RF	
	65-11660-99	DRAIN INSTL, FAN ENGINE (OIL ONLY) (SEE 71-1, FIG. 5G, ITEM 48 AND 71-1, FIG. 5H, ITEM 41)							5199	RF	
	1	65-11660-86	. TUBE ASSY, DRAIN 3/8 IN. .035 6061-T6 . . . . .								1
		MS21921-6	. . . NUT . . . . .								1
		BACS13AP6	. . . SLEEVE, (OPTIONAL MS21922-6). . . . .								1
	2	65-11660-887	. TUBE ASSY, DRAIN 3/8 .035 6061-T6 . . . . .								1
		MS21921-6	. . . NUT . . . . .								2
		BACS13AP6	. . . SLEEVE, (OPTIONAL MS21922-6). . . . .								2
	3	BACG10U5	. GASKET. . . . .								1
	4	MS21902D6	. UNION . . . . .								1
5	MS21916D6-5	. REDUCER . . . . .								1	
		. FOR REFERENCE TO OTHER DRAIN DETAILS, SEE NHA . . . . .									

MISSING ITEM NUMBERS ARE NOT APPLICABLE

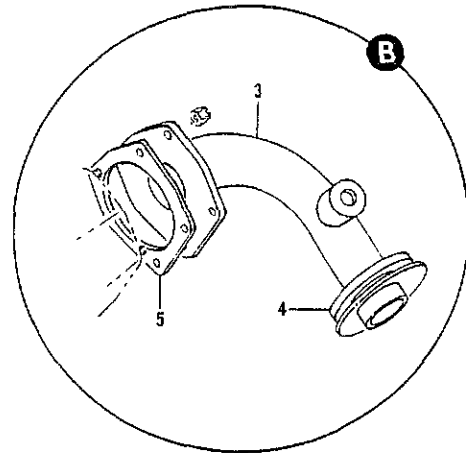
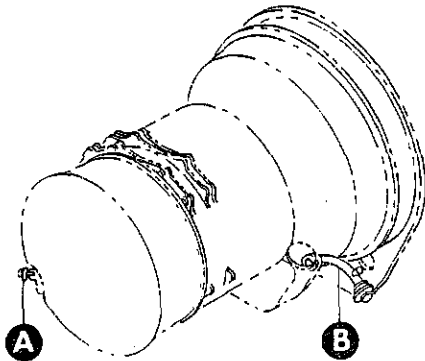
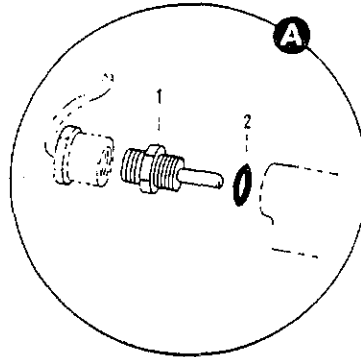
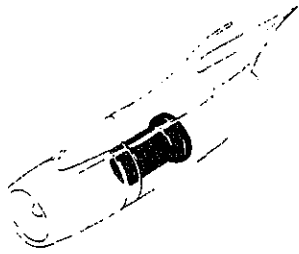

FIGURE 12. BULB INSTL, JT3D1 ENGINE OIL INLET TEMPERATURE  
BREATHER INSTL, FAN ENGINE



**PARTS CATALOG**

FIGURE & ITEM NO.	MANUFACTURER'S PART NUMBER	NOMENCLATURE							EFF FROM TO	UNITS PER ASSY
		1	2	3	4	5	6	7		
12										
	69-11176									RF
1	5683G									1
2	BACG10U8 69-11100-1									1 RF
3	69-10999-3 NAS679A4W AN960P0416									1 4 4
4	66-10756									1
5	66-10705-800									1

MISSING ITEM NUMBERS ARE NOT APPLICABLE

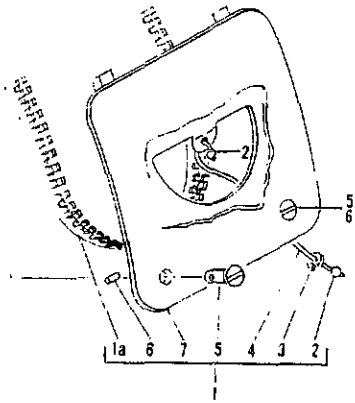
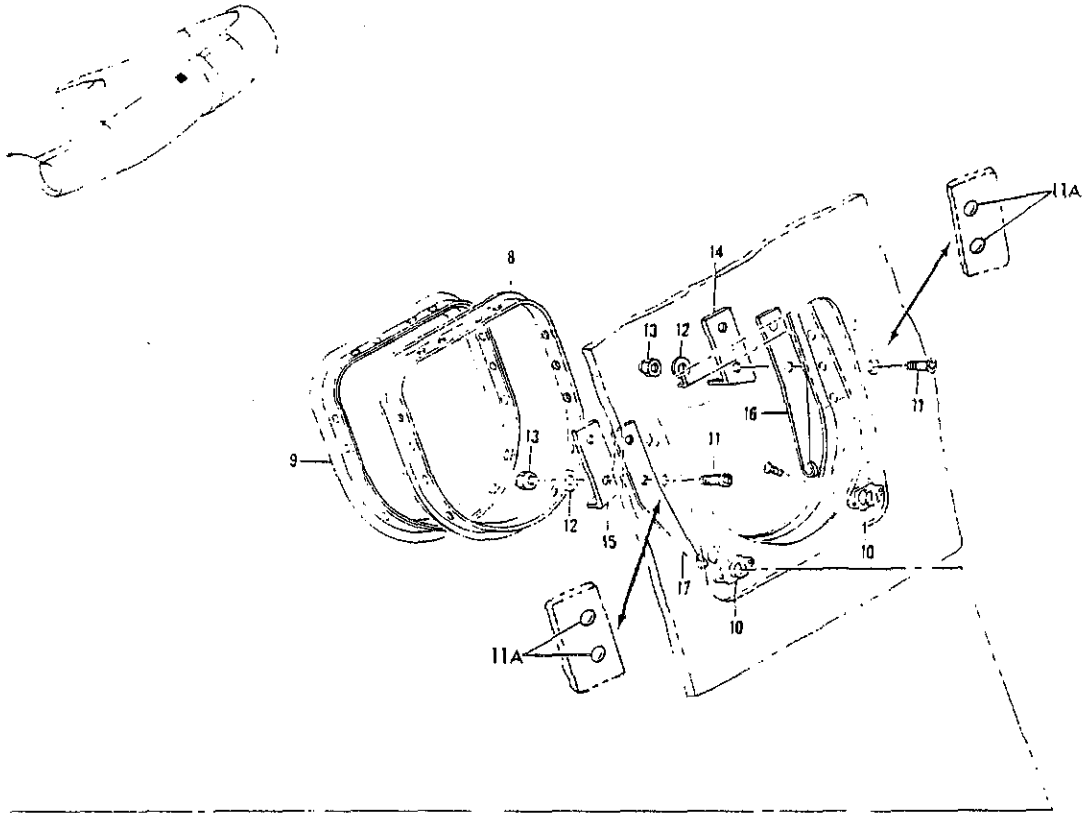

FIGURE 13. DOOR INSTL, ENGINE OIL TANK FILLER (RH)

BOEING *707* Intercontinental   
PARTS CATALOG

FIGURE & ITEM NO.	MANUFACTURER'S PART NUMBER	NOMENCLATURE							EFF FROM TO	UNITS PER ASSY
		1	2	3	4	5	6	7		
13	65-11887-18	DOOR INSTL, ENGINE OIL TANK FILLER (RH) (SEE 71-2, FIG. 12, ITEM 40)								RF
1	65-11887-17	. DOOR ASSY, (USED ON 65-11887-18).								1
1A	BACG20ZA1275	. GROMMET								1
2	BACT1483	. TERMINAL								2
3	BACW1081	. WASHER								1
4	BACC13G333-50A	. CABLE ASSY.								1
5	BACS21B5FH18	. STUD								2
6	BACP18A2	. PIN								2
7	65-11887-16	. SPOTWELD ASSY, (USED ON 65-11887-17)								1
8	65-11887-5	. RETAINER, ENGINE OIL TANK FILLER DOOR SEAL.								1
		ATTACHING PARTS								
	NAS601-6	. SCREW								15
	AN960PD6L	. WASHER								15
	NAS679A06W	. NUT								15
		-----*								
9	69-10844	. SEAL, ENGINE OIL TANK SCUPPER								1
10	BACS20B5P130	. SPRING								2
11	NAS517-3-4	. SCREW								4
12	AN960PD10	. WASHER								4
13	NAS679A3W	. NUT								4
14	65-11887-11	. CLIP, ENGINE OIL TANK FILLER DOOR								1
15	65-11887-14	. CLIP								1
16	65-11887-9	. SPRING, ENGINE OIL TANK FILLER DOOR FLAT.								1
17	65-11887-10	. SPRING, ENGINE OIL TANK FILLER DOOR FLAT.								1

MISSING ITEM NUMBERS ARE NOT APPLICABLE

**BOEING** *707* *Intercontinental*   
**PARTS CATALOG**

**SECTION 02**  
**OIL INDICATING**

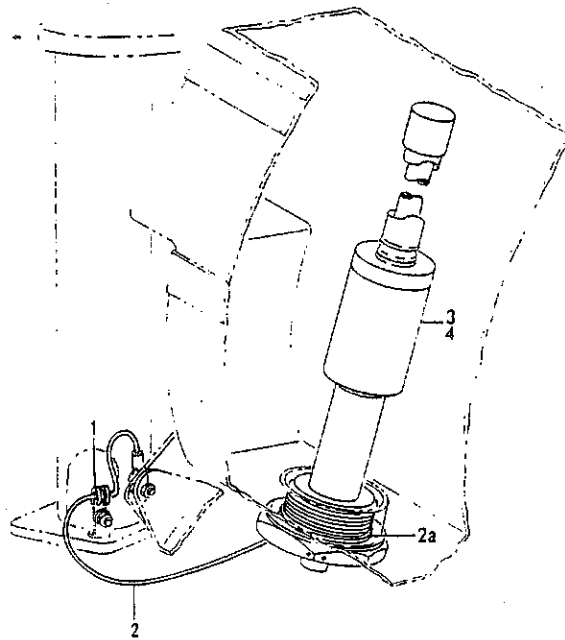

FIGURE 2. TANK UNIT INSTL. FAN ENGINE OIL QUANTITY



**PARTS CATALOG**

FIGURE & ITEM NO.	MANUFACTURER'S PART NUMBER	NOMENCLATURE							EFF FROM TO	UNITS PER ASSY
		1	2	3	4	5	8	7		
2	69-11151	TANK UNIT INSTL, FAN ENGINE OIL QUANTITY (SEE 71-1, . . . FIG. 5, ITEM 13, 71-1, FIG. 5B, ITEM 62, 71-1, FIG. 5E, ITEM 75, 71-1, FIG. 5G, ITEM 70 AND 71-1, FIG. 5H, ITEM 61)								RF
1	BACC10BH3RW	. CLAMP . . . . .								1
	NAS603-6	. ATTACHING PARTS . . . . .								1
	NAS679A3W	. SCREW . . . . .								1
		. NUT . . . . .								1
2	69-11151-875	. JUMPER ASSY, FAN ENGINE OIL QUANTITY TANK UNIT. . . . .								1
		. BONDING (ALTERED FROM MS25083-2AB12)								
		. ATTACHING PARTS . . . . .								
	NAS603-6	. SCREW . . . . .								1
	NAS601-5	. SCREW, (OPTIONAL) . . . . .								1
	MS35335-72	. WASHER, (OPTIONAL) . . . . .								1
	NAS679A3W	. NUT . . . . .								1
3	10-3230-4	. TANK UNIT, ENGINE OIL QUANTITY. . . . .								1

MISSING ITEM NUMBERS ARE NOT APPLICABLE

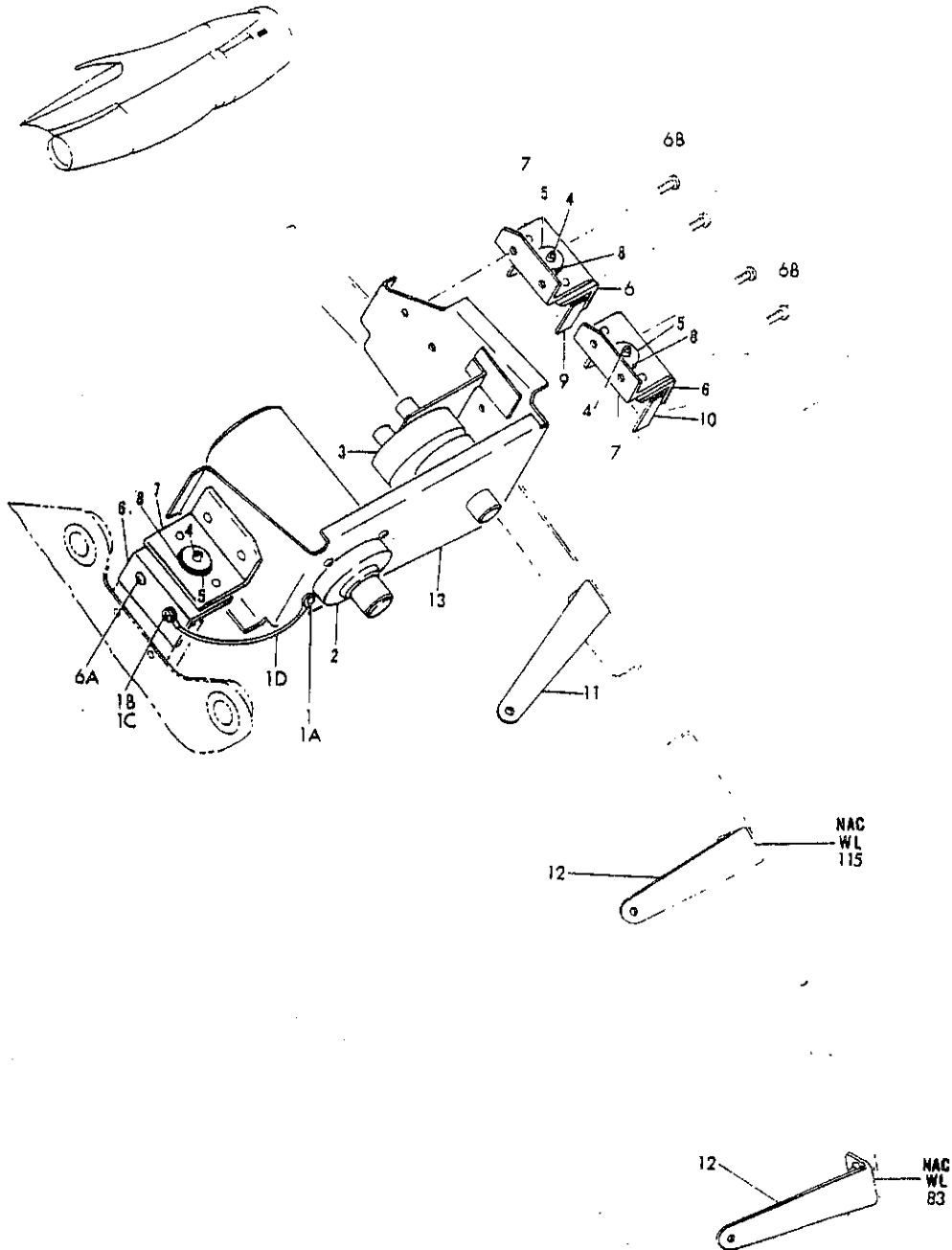

FIGURE 4. TRANSMITTER AND SWITCH INSTL, OIL PRESSURE



**PARTS CATALOG**

FIGURE & ITEM NO.	MANUFACTURER'S PART NUMBER	1 2 3 4 5 6 7	NOMENCLATURE	EFF	UNITS	
				FROM TO	PER ASSY	
R R R R R R R R R R R R	4	65-11653	TRANSMITTER AND SWITCH INSTL, OIL PRESSURE (SEE 71-1, FIG. 5, ITEM 24, 71-1, FIG. 5B, ITEM 63, 71-1, FIG. 5E, ITEM 76, 71-1, FIG. 5G, ITEM 71 AND 71-1, FIG. 5H, ITEM 62)	0150	RF	
		65-11653-2	SPARES ASSY, OIL PRESSURE TRANSMITTER AND SWITCH. . . . (CONSISTS OF PARTS DENOTED BY (S))	0150	RF	
	1	S NAS601-7	. SCREW . . . . .	0150	1	
	1A	S AN960D6	. WASHER . . . . .	0150	1	
	1B	S NAS603-9	. SCREW . . . . .	0150	1	
	1C	S AN960D10	. WASHER . . . . .	0150	1	
	1D	S MS25083-2A84	. JUMPER ASSY . . . . .	0150	1	
	2	ST4N	. TRANSMITTER, (V61349) . . . . .	0150	1	
		NAS601-7	ATTACHING PARTS			
		S AN960D6	. SCREW . . . . .	0150	3	
			. WASHER . . . . .	0150	3	
	R	3	10-3269-9	. SWITCH ASSY, ENGINE PRESSURE ACTUATED . . . . .	0150	1
	R		NAS603-6	ATTACHING PARTS		
			. SCREW . . . . .	0150	2	
R	4	S NAS602-12	. SCREW . . . . .	0150	3	
R	5	S J2049-1	. WASHER, SNUBBING (V76005) . . . . .	0150	3	
R	6	S 69-11183-2	. ANGLE ASSY, PRESSURE TRANSMITTER AND SWITCH . . . . .	0150	3	
			ATTACHING PARTS			
R	6A	NAS603-9	. SCREW . . . . .	0150	1	
R	6B	NAS603-6	. SCREW . . . . .	0150	4	
R	7	S 69-11183	. ANGLE ASSY, PRESSURE TRANSMITTER AND SWITCH . . . . .	0150	3	
R	8	S 100PDL3	. MOUNT, PLATE (V76005) . . . . .	0150	1	
			ATTACHING PARTS			
R		S NAS601-6	. SCREW, (OPTIONAL MS20470D4) . . . . .	0150	2	
R		S NAS679A06W	. NUT . . . . .	0150	2	
R	9	66-10812-2	. CLIP ASSY, PRESSURE TRANSMITTER AND SWITCH. . . . .	0150	1	
			ATTACHING PARTS			
R		AN5C5A	. BOLT. . . . .	0150	2	
R		AN960C516	. WASHER. . . . .	0150	2	
R		NAS679A5	. NUT . . . . .	0150	2	
R	10	66-10812-6	. CLIP ASSY, PRESSURE TRANSMITTER AND SWITCH. . . . .	0150	1	
			ATTACHING PARTS			
R		AN5C5A	. BOLT. . . . .	0150	2	
R		AN960C516	. WASHER. . . . .	0150	2	
R		NAS679A5	. NUT . . . . .	0150	2	
R	11	69-12700-812	. BRACKET ASSY, ENGINE AIRFRAME . . . . .	0150	1	
R	12	69-12700-824	. BRACKET ASSY, ENGINE AIRFRAME . . . . .	0150	2	
			ATTACHING PARTS			
R		AN5C5A	. BOLT. . . . .	0150	3	
R		AN960C516	. WASHER. . . . .	0150	3	
R	13	69-11174-5	. BRACKET ASSY. . . . .	0150	1	
R	13	S 69-11174-5	. BRACKET ASSY, (FOR SPARES ONLY) . . . . .	0150	1	

MISSING ITEM NUMBERS ARE NOT APPLICABLE

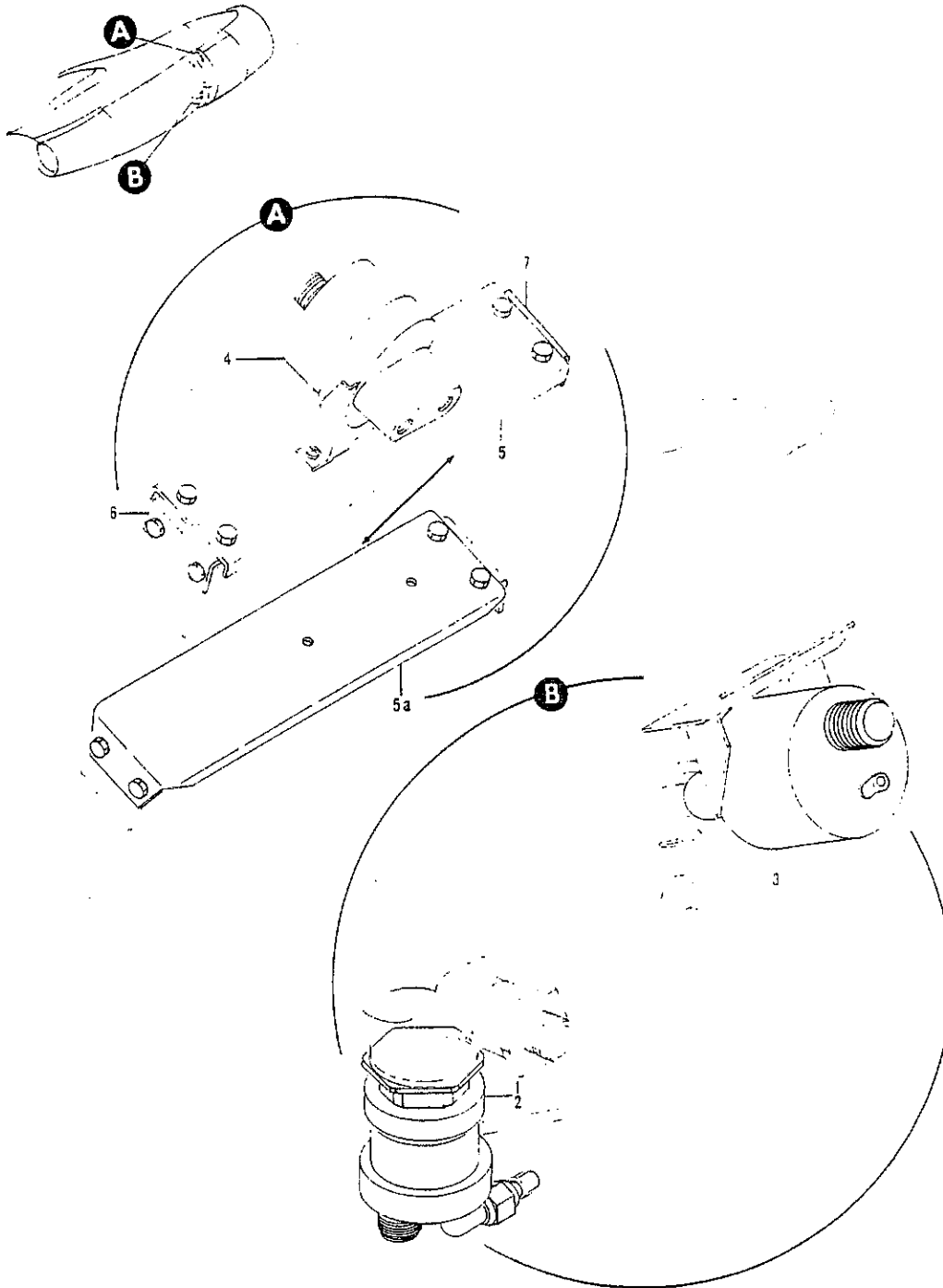

FIGURE 5. TRANSMITTER AND SWITCH INSTL, FAN ENGINE OIL PRESSURE



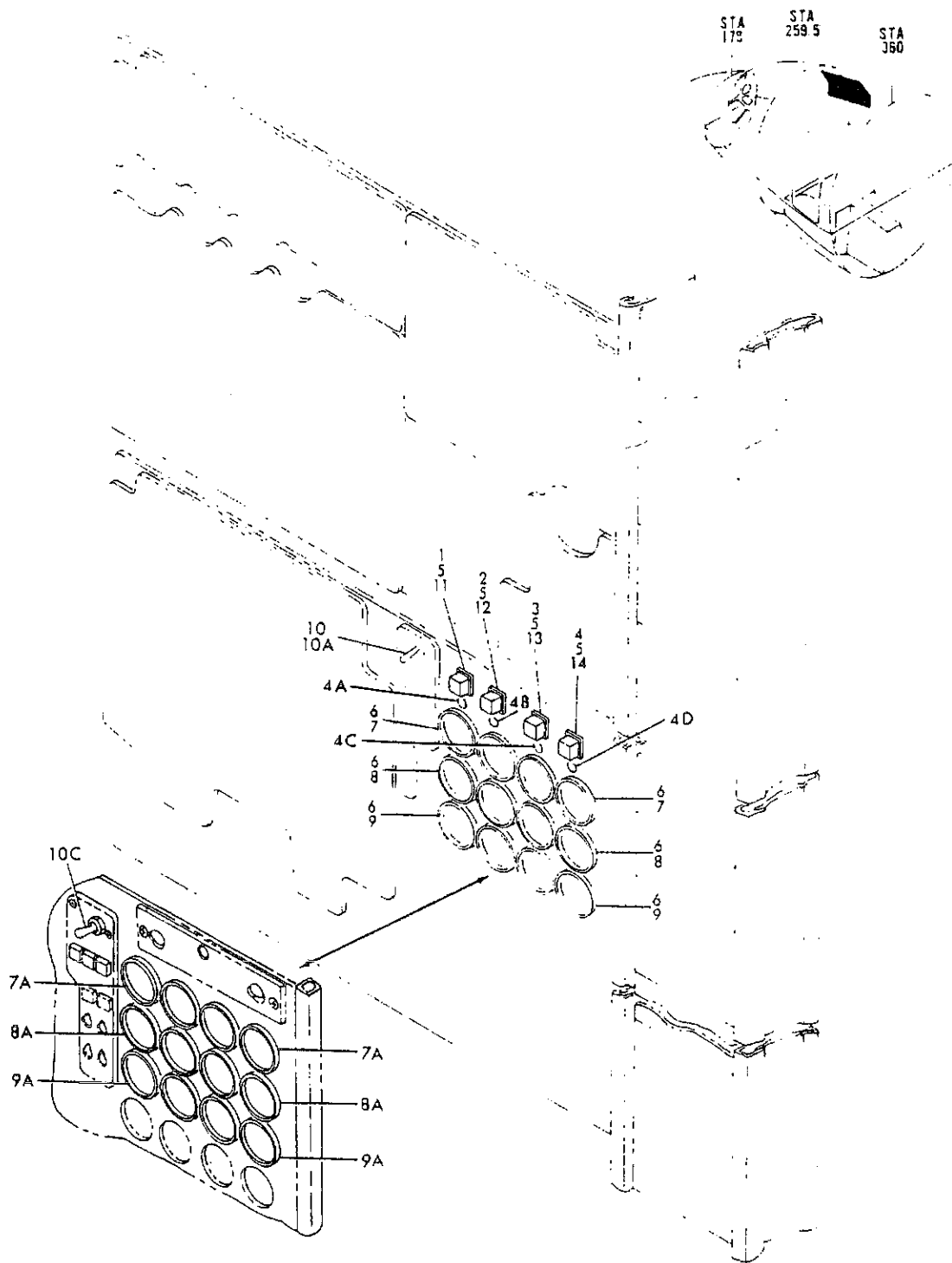

FIGURE 16K. PANEL INSTL, FLIGHT ENGINEERS LOWER (OIL ONLY)



**PARTS CATALOG**

FIGURE & ITEM NO.	MANUFACTURER'S PART NUMBER	NOMENCLATURE							EFF FROM TO	UNITS PER ASSY
		1	2	3	4	5	6	7		
16K	65-58956-1	PANEL INSTL, FLIGHT ENGINEERS LOWER (OIL ONLY) (SEE . . . 25-1, FIG. 1B, ITEM 8, 25-1, FIG. 1E, ITEM 8, 25-1, FIG. 1F, ITEM 6, 25-1, FIG. 2D, ITEM 6 AND 25-1, FIG. 2E, ITEM 83)							5199	RF
	65-58956-88	. UNIT ASSY, (OIL ONLY) . . . . .							5199	RF
6	BACC10EL3	. . CLAMP . . . . .							5199	12
7	10-3230-6	. . INDICATOR, ENGINE OIL QUANTITY. . . . .							5199	4
8	162BL704A	. . INDICATOR, OIL TEMPERATURE (V35918) . . . . .							5199	4
9	496-02740	. . INDICATOR, OIL PRESSURE (VI4140) (DELETED BY SVA. . . E.O. 80789)							5199	4
9	496-04740	. . INDICATOR, OIL PRESSURE (VI4140) (ADDED BY SVA. . . E.O. 80789)							5199	4
10	4PB11H58	. . SWITCH, (V91929). . . . .							5199	1
		. FOR REFERENCE TO OTHER PANEL DETAILS, SEE NHA . . . . .							5199	

MISSING ITEM NUMBERS ARE NOT APPLICABLE

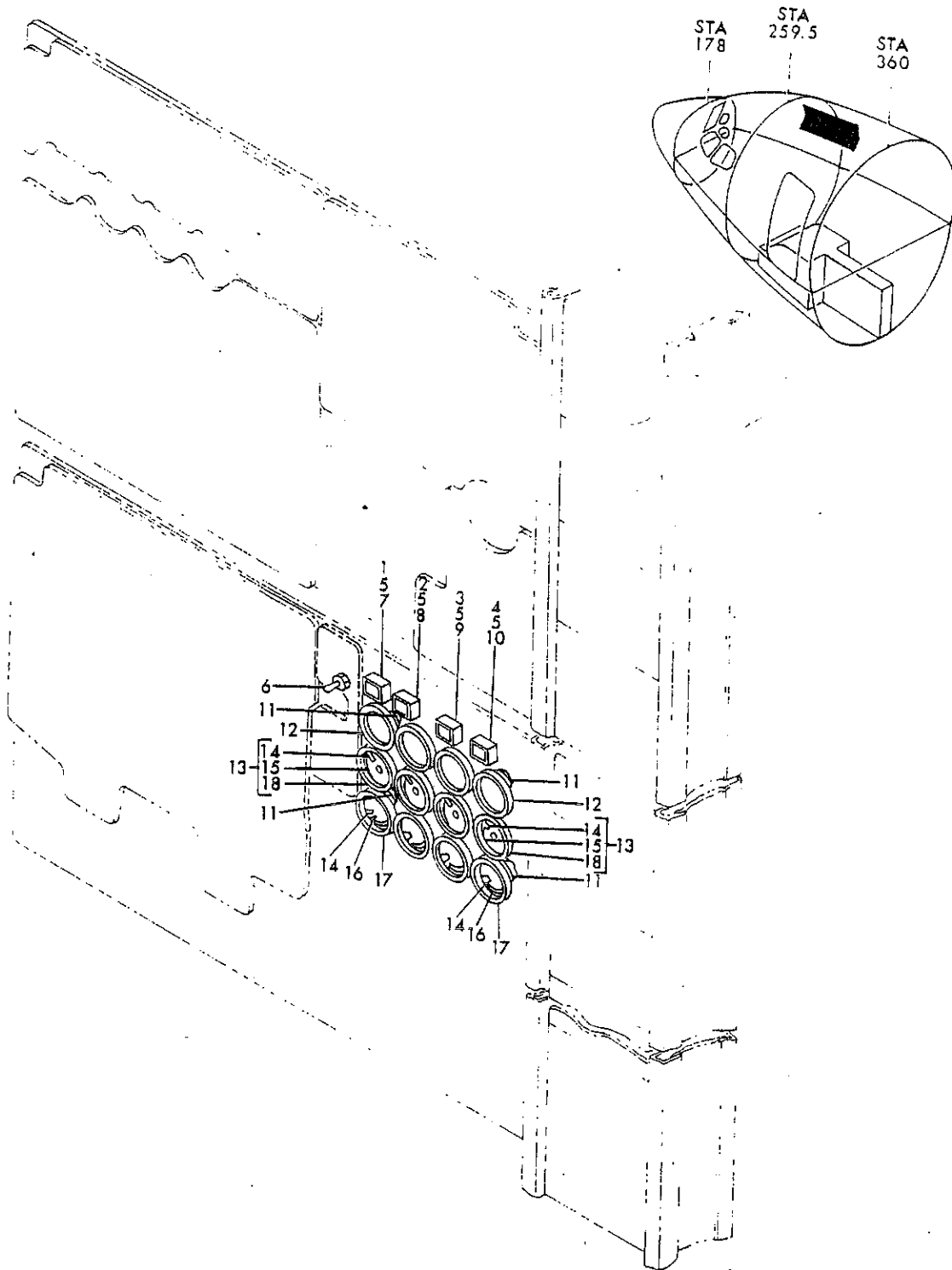

FIGURE 16M. PANEL INSTL, FLIGHT ENGINEERS LOWER (OIL ONLY)



**PARTS CATALOG**

FIGURE & ITEM NO.	MANUFACTURER'S PART NUMBER	NOMENCLATURE							EFF FROM TO	UNITS PER ASSY	
		1	2	3	4	5	6	7			
R R R R R	16M	65-58398-1	PANEL INSTL, FLIGHT ENGINEERS LOWER (OIL ONLY) (DELETED BY RAF 7211.019-225) (SEE 25-1, FIG. 1K, ITEM 5)							0150	RF
		361-39-11-74192-001	PANEL INSTL, FLIGHT ENGINEERS LOWER (OIL ONLY) (VS2500) (ADDED BY RAF 7211.019-225) (SEE 25-1, FIG. 1K, ITEM 5)							0150	RF
	1	515-1011-026	. CAP, LIGHT (V81590) . . . . .							0150	1
	2	515-1011-027	. CAP, LIGHT (V81590) . . . . .							0150	1
	3	515-1011-028	. CAP, LIGHT (V81590) . . . . .							0150	1
	4	515-1011-029	. CAP, LIGHT (V81590) . . . . .							0150	1
	5	1864	. LAMP, INCANDESCENT (V08806) . . . . .							0150	4
	6	65-58398-13	. UNIT ASSY, (OIL ONLY) . . . . .							0150	RF
	7	MS25068-28	. . SWITCH. . . . .							0150	1
	8	054-1011-026	. . BASE, LIGHT (V81590). . . . .							0150	1
	9	054-1011-027	. . BASE, LIGHT (V81590). . . . .							0150	1
	10	054-1011-028	. . BASE, LIGHT (V81590). . . . .							0150	1
	11	054-1011-029	. . BASE, LIGHT (V81590). . . . .							0150	1
	12	BACC10EL3	. . CLAMP . . . . .							0150	12
	13	10-3230-2	. . INDICATOR, ENGINE OIL QUANTITY. . . . .							0150	4
	13A	65-14247-1	. . INSTRUMENT INSTL, ENGINE. . . . .							0150	1
	14	65-14247-24	. . INSTRUMENT AND MARKING ASSY, TEMPERATURE. . . . .							0150	4
	15	65-14247-37	. . INSTRUMENT AND MARKING ASSY, PRESSURE . . . . .							0150	4
16	6202	. . . . TAPE, RED PLASTIC (V93994). . . . .							0150	AR	
17	63-10520	. . . . SCOTCH-CAL, ENGINE INSTRUMENT RANGE MARKING GREEN . . . . .							0150	AR	
18	63-10520-1	. . . . SCOTCH-CAL, ENGINE INSTRUMENT RANGE MARKING YELLOW (USED ON 65-14247-37) . . . . .							0150	AR	
19	SR04E	. . . . INDICATOR, PRESSURE (V61349) (USED ON 65-14247-37) . . . . .							0150	1	
20	162C7A	. . . . INDICATOR, TEMPERATURE (V35918) (USED ON 65-14247-24) . . . . .							0150	1	
		. FOR REFERENCE TO OTHER PANEL DETAILS, SEE NHA . . . . .							0150		

MISSING ITEM NUMBERS ARE NOT APPLICABLE

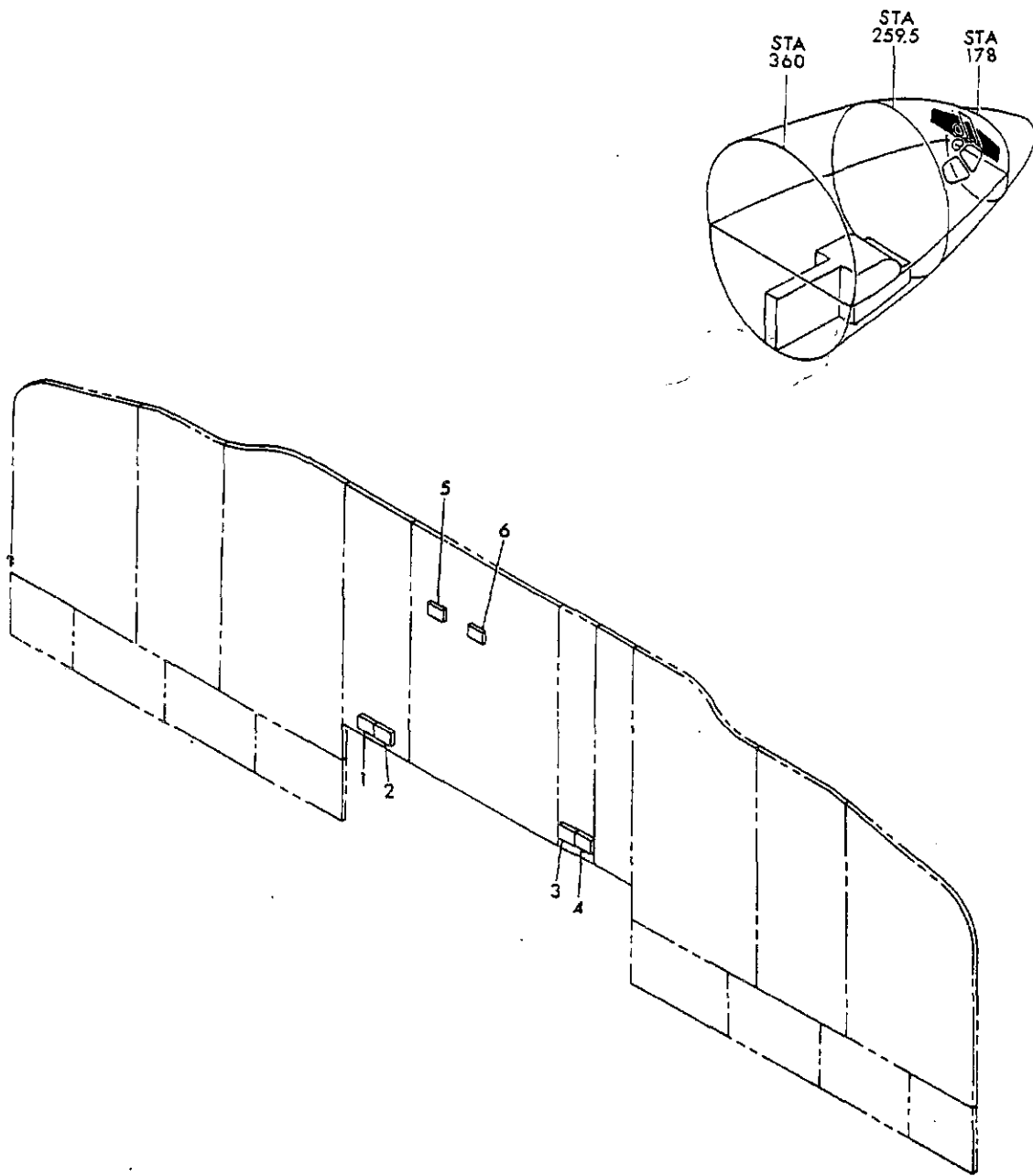

FIGURE 37F. MODULE INSTL, CAPTAINS AND FIRST OFFICERS (INSTRUMENT PANELS) (OIL ONLY)



**PARTS CATALOG**

FIGURE & ITEM NO.	MANUFACTURER'S PART NUMBER	NOMENCLATURE							EFF FROM TO	UNITS PER ASSY
		1	2	3	4	5	6	7		
37F	65C10900-1	MODULE INSTL, CAPTAINS AND FIRST OFFICERS (INSTRUMENT PANELS) (VARIABLE DWG; 65C10900-5003) (OIL ONLY) (SEE 25-1, FIG. 2E, ITEM 107A)							5199	RF
	65C10904-1	. MODULE ASSY, P9-1 (OIL ONLY) . . . . .							5199	RF
1	318-630-1003-018	. . LIGHT ASSY, ENGINE NO. 1 LOW PRESSURE INDICATOR . . . . . (V81590)							5199	1
2	318-630-1003-019	. . LIGHT ASSY, ENGINE NO. 2 LOW PRESSURE INDICATOR . . . . . (V81590)							5199	1
	65C10906-1	. MODULE ASSY, P9-3 (OIL ONLY) . . . . .							5199	RF
	65C10906-3	. MODULE ASSY, P9-3 (OIL ONLY) . . . . .							5199	RF
3	318-630-1003-130	. . LIGHT ASSY, ENGINE NO. 3 LOW PRESSURE INDICATOR . . . . . (V81590)							5199	1
4	318-630-1003-131	. . LIGHT ASSY, ENGINE NO. 4 LOW PRESSURE INDICATOR . . . . . (V81590)							5199	1
		. FOR REFERENCE TO OTHER MODULE DETAILS, SEE NHA. . . . .							5199	

MISSING ITEM NUMBERS ARE NOT APPLICABLE