



sabena B707	Module: COCKPIT + WINDOW	A/C Reg :	Check :	
	Oper. : RT-MP LC			
	Type : SERVICING	Issuer : A43710	Cert.St.: 24828	81H1000501
Spec. : MECHANIC	Release Date: 11.10.2001		Page 1 of 2	

UARRSI DRAIN CLEAN & INSP

Execution / Start Date:	
End Date:	

MAINT RII/INSP

Pos	Mat. Type	P/N	IDN	Description	Qty	Unit
1	CONSUM	MS29513-111		PACKING	1.00	EA

sabena B707	Module: COCKPIT + WINDOW	A/C Reg :	Check :	 81H1000501
	Oper. : RT-MP LC			
	Type : SERVICING	Issuer : A43710	Cert.St.: 24828	
Spec. : MECHANIC	Release Date: 11.10.2001		Page 2 of 2	

UARRSI DRAIN CLEAN & INSP

					MAINT	RII/INSP
Nr.	Hardtime	Task	Spec.	Related Documents		
1.		E3 S	MEC	MMS-328 280103 00100 rev 02/02/01		
Check: C						
Zones: 224						
Access:						

UARRSI DRAIN CIRCUIT INSPECTION.

UARRSI drain circuit: Remove, clean and inspect.

1. Remove shroud fwd toilet.
2. UARRSI drain circuit: Jet sump pump P/N: 68E125. Remove, clean and inspect nozzle.
(Location: FWD TOILET BEHIND SHROUD).
 - A) Remove nozzle (item 10 on fig.) and clean with M.E.K. and dry with compressed air.
 - B) Inspect nozzle.
 - C) Reinstall nozzle with new packing (item 20 on fig.).
 - D) Reinstall shroud of fwd toilet.

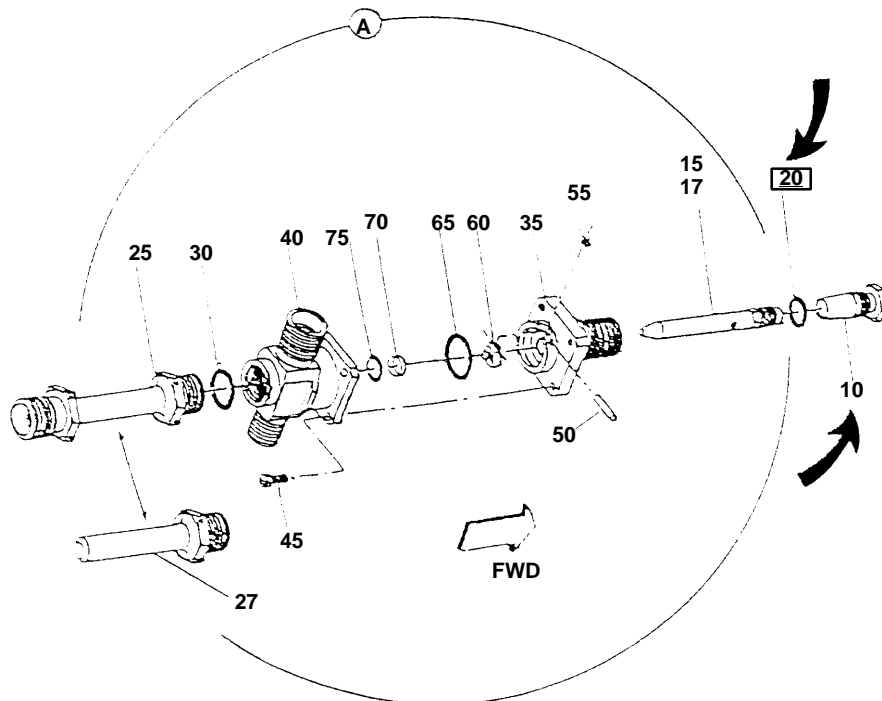

UARRSI DRAIN CLEAN & INSP