

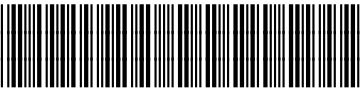

sabena [®] B707	Module: PYLON 1	A/C Reg :	Check :	
	Oper. : RT-MP LC			
	Type : STRUCT-INSP	Issuer : A62165	Cert.St.: 45379	S1F3000501
Spec. : MECH. INSP	Release Date: 23.07.2008		Page 1 of 4	

AD 85-12-01 rev . PYLON 1 MID SPAR FTGS INSP

		MAINT	RII/INSP
Execution / Start Date:			
End Date:			

AD 85-12-01 rev . PYLON 1 MID SPAR FTGS INSP

sabena B707	Module: PYLON 1	A/C Reg :	Check :	 S1F3000501
	Oper. : RT-MP LC	Issuer : A62165	Cert.St.: 45379	
	Type : STRUCT-INSP	Release Date: 23.07.2008	Page 2 of 4	
Spec. : MECH. INSP				

AD 85-12-01 rev . PYLON 1 MID SPAR FTGS INSP

					MAINT	RII/INSP
Nr.	Hardtime	Task	Spec.	Related Documents		
1.	19980 CYC	E3	INS	AD 85-12-05 R1 rev 5439 MMS-328 544170 02001 rev 15.07.05 SSID 54-A40-02/A rev M		
Check: B						
Zones: 455						
Access: 1745, 1746, 1753, 1754						
NRC YES <input type="radio"/> NO <input type="radio"/>		IF YES, NUMBER(S):				

PYLON ENG #1 MID SPAR FITTINGS INSPECTION.

Close visual, internal inspection of both mid spar fittings for cracks in the upper horizontal tang root area and in the fittings lugs.

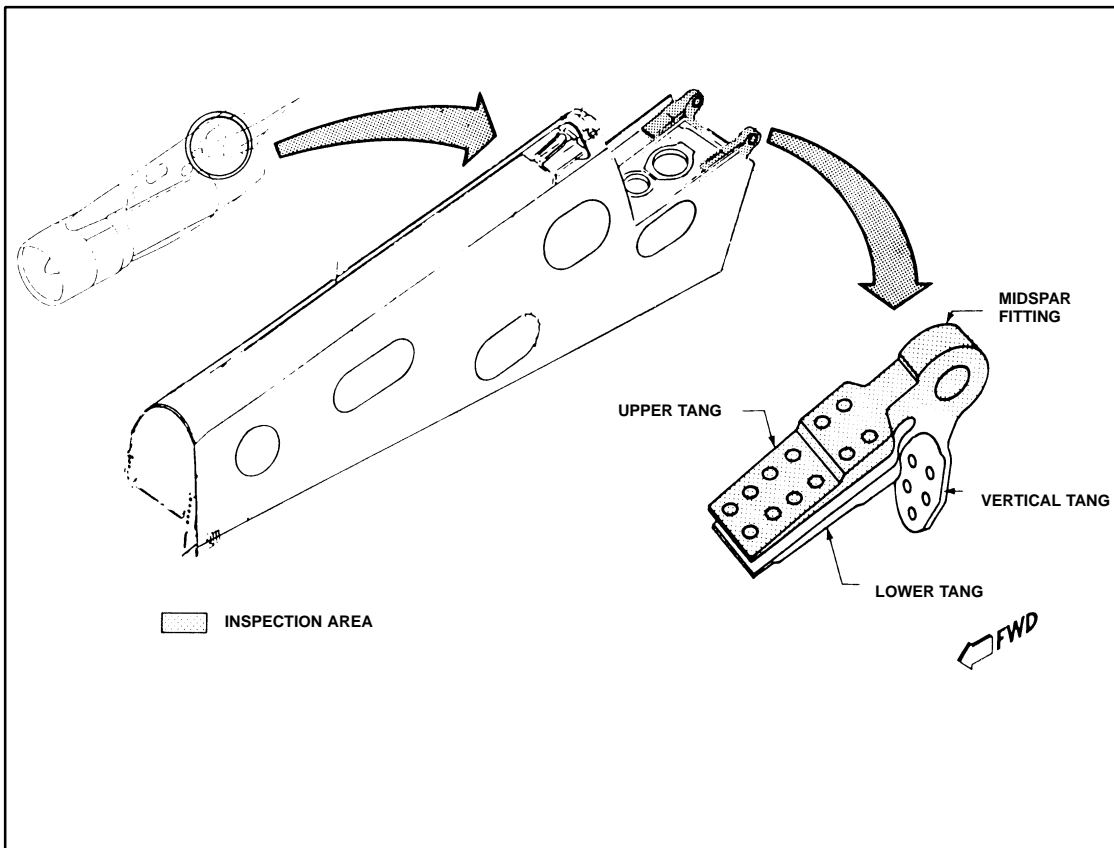

sabena B707	Module: PYLON 1	A/C Reg :	Check :	 S1F3000501 Page 3 of 4
	Oper. : RT-MP LC	Issuer : A62165	Cert.St.: 45379	
	Type : STRUCT-INSP	Release Date: 23.07.2008		
Spec. : MECH. INSP				

AD 85-12-01 rev . PYLON 1 MID SPAR FTGS INSP

					MAINT	RII/INSP	
Nr.	Hardtime	Task	Spec.	Related Documents			
2.	20014 CYC	E3	INS	AD 85-12-05 R1 rev 5439 MMS-328 544170 02001 rev 15.07.05 SSID 54-A40-02/A rev M			
Check: B							
Zones: 455							
Access: 1745, 1746, 1753, 1754							
NRC YES <input type="radio"/> NO <input type="radio"/>		IF YES, NUMBER(S):					

PYLON ENG #1 MID SPAR FITTINGS INSPECTION.

Close visual, internal inspection of both mid spar fittings for cracks in the upper horizontal tang root area and in the fittings lugs.

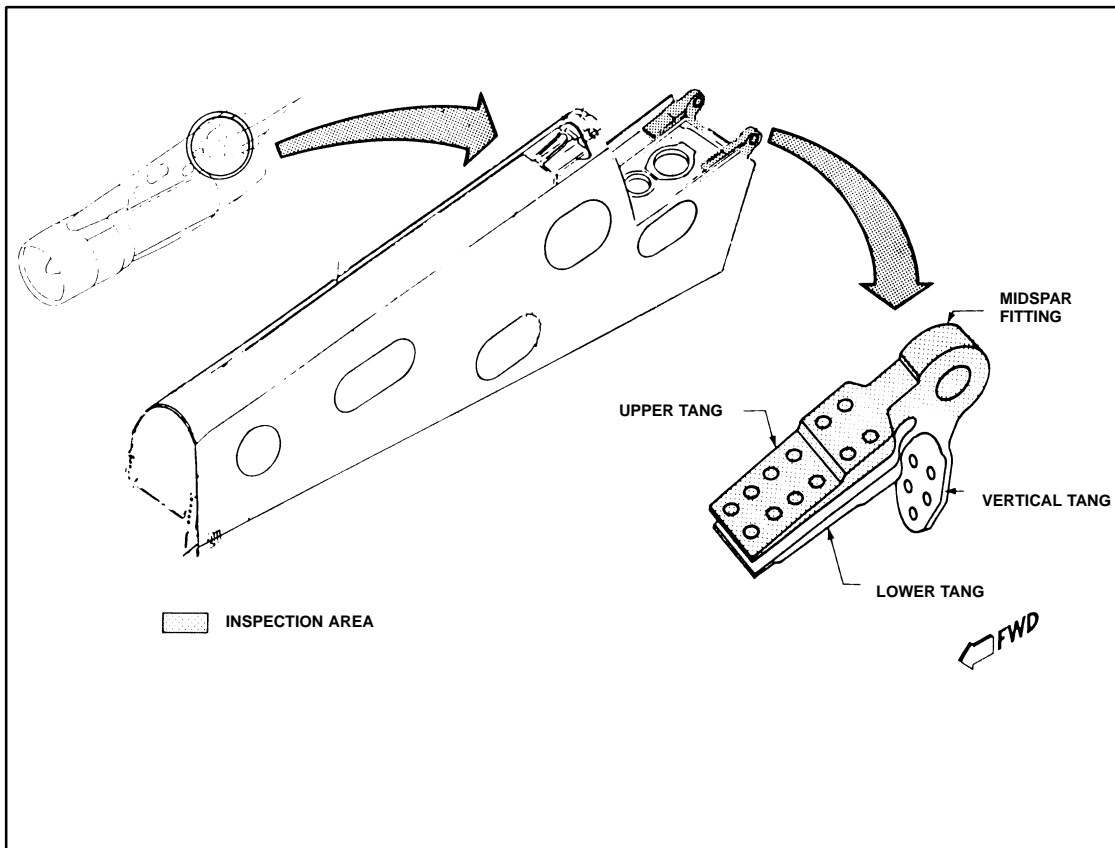

sabena B707	Module: PYLON 1	A/C Reg :	Check :	 S1F3000501 Page 4 of 4
	Oper. : RT-MP LC			
	Type : STRUCT-INSP	Issuer : A62165	Cert.St.: 45379	
	Spec. : MECH. INSP	Release Date: 23.07.2008		

AD 85-12-01 rev . PYLON 1 MID SPAR FTGS INSP

					MAINT	RII/INSP
Nr.	Hardtime	Task	Spec.	Related Documents		
3.		E3	INS	AD 85-12-05 R1 rev 5439 MMS-328 544170 02001 rev 15.07.05 SSID 54-A40-02/A rev M		
Check: B						
Zones: 455						
Access: 1745, 1746, 1753, 1754						
NRC YES <input type="radio"/> NO <input type="radio"/>		IF YES, NUMBER(S):				

PYLON ENG #1 MID SPAR FITTINGS INSPECTION.

Close visual, internal inspection of both mid spar fittings for cracks in the upper horizontal tang root area and in the fittings lugs.

