

Fuselage Equipment

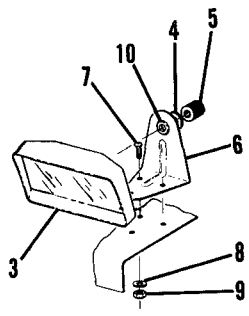

**CODE D**  
**MIRROR INSTALLATION**

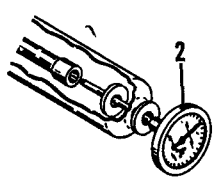

**Detail A**

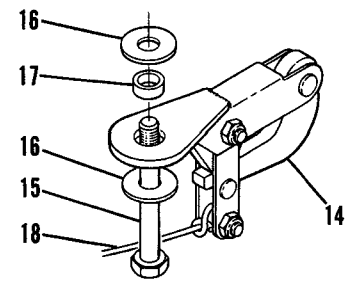

**TOW HOOK INSTALLATION**

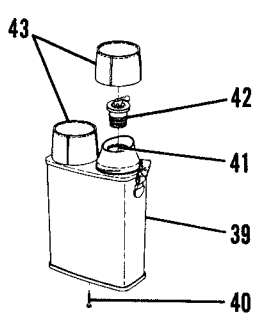

**TWIN PACK ASSEMBLY**

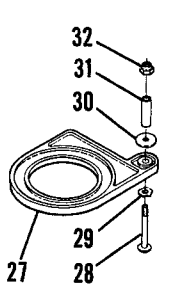
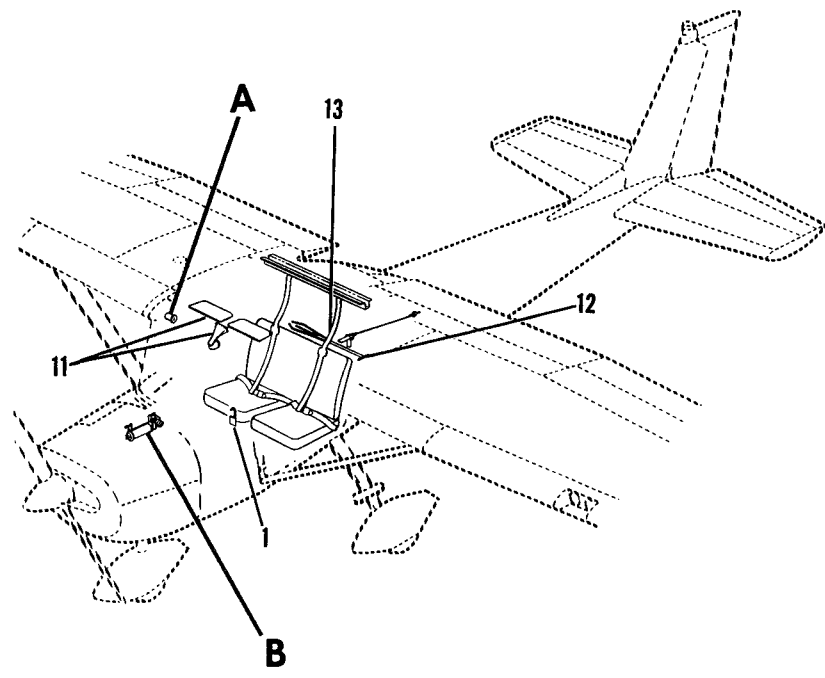

**CODE N**

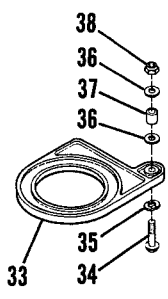

**CODE P**

**CUP HOLDER**

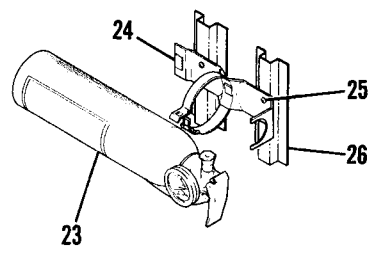

**CODE J**

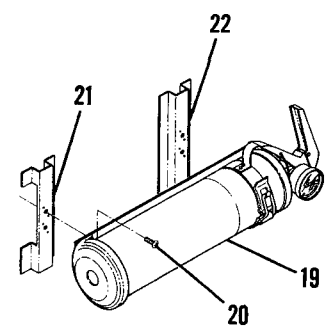

**CODE H**

**Detail B**

Figure 50. Fuselage Equipment Installation

FIGURE AND INDEX NO.	PART NUMBER	DESCRIPTION	UNITS PER ASSY	USABLE ON CODE
		<b>1 2 3 4 5 6 7</b>		
50 -		FUSELAGE EQUIPMENT INSTALLATION -----	NP	
- 1	0460134-1	LOCK ASSY-CONTROL -----	1	A
	0460134-3	LOCK ASSY-CONTROL -----	1	B
	0460137-1	LOCK ASSY-CONTROL -----	1	C
- 2	C668507-0101	GAGE-OUTSIDE AIR TEMP -----	1	
	C668507-0102	GAGE-OUTSIDE AIR TEMP ALTERNATE -----	1	
	SEE FIG 47A	MIRROR INSTL-REAR VIEW -----	NP	D
- 3	0500312-2	MIRROR ASSY -----	NP	E
		ATTACHING PARTS -----	1	D
- 4	S1450-4A11-063	WASHER -----	1	D
- 5	0500313-1	NUT -----	1	D
		-----*		
- 6	0500310-1	BRACKET ASSY -----	1	D
		ATTACHING PARTS -----		
- 7	AN507B832R8	SCREW -----	3	D
- 8	S1450-3A14-050	WASHER -----	4	D
- 9	MS20365B832C	NUT -----	3	D
		-----*		
-10	MS35489-6	GROMMET -----	1	D
-11	SEE FIG 51	COMPASS & SUN VISOR INSTL -----	1	D
	SEE FIG 51A	COMPASS & SUN VISOR INSTL -----	1	E
-12	0700315-2	TOW BAR-NOSE WHEEL WEU 0501019-1 -----	1	F
	0700315-4	TOW BAR-NOSE WHEEL ALTERNATE WEU 0501019-1 -----	1	F
	0501019-1	TOW BAR-NOSE WHEEL -----	1	G
-13	SEE FIG 50A&50B	SHOULDER HARNESS & SEAT BELT INSTL -----	1	
		TOW HOOK INSTL -----	NP	
-14	0500228-2	TOW HOOK -----	1	
-15	AN5-23A	BOLT -----	1	
-16	S1450-5-14-063	WASHER -----	2	
-17	0500228-5	BUSHING -----	1	
-18	0500228-3	CORD-TOW HOOK -----	1	
-19	0800111-2	FIRE EXTINGUISHER & BRACKET -----	1	H
	CP23/4	FIRE EXTINGUISHER & BRACKET GFET ALTERNATE -----	1	H
		ATTACHING PARTS -----		
-20	AN515-8R8	SCREW -----	4	H
		-----*		
-21	0400028-7	BRACKET ASSY-FIRE EXTINGUISHER FWD -----	1	H
-22	0400028-4	BRACKET ASSY-FIRE EXTINGUISHER AFT -----	1	H
	NAS680A08	NUTPLATE -----	2	H
-23	C421001-0101	FIRE EXTINGUISHER -----	1	J
-24	C421001-0102	BRACKET-FIRE EXTINGUISHER -----	1	J
		ATTACHING PARTS -----		
-25	AN520-10R7	SCREW -----	1	J
		-----*		
-26	0413510-1	BRACKET ASSY-FIRE EXTINGUISHER -----	2	J
	NAS680A3	NUTPLATE -----	2	J
-27	0501022-1	CUP HOLDER -----	2	N
		ATTACHING PARTS -----		
-28	AN525-10R22	SCREW -----	1	N
-29	S1357-3	WASHER -----	1	N
-30	AN960PD10L	WASHER USED ON LH INSTL -----	2	N
	AN960-10L	WASHER USED ON RH INSTL -----	2	N
-31	NAS430D3-30	SPACER USED ON LH INSTL -----	1	N
	NAS430D3-32	SPACER USED ON RH INSTL -----	1	N
-32	MS21044N3	NUT -----	1	N
		-----*		
-33	0501022-1	CUP HOLDER -----	2	P
		ATTACHING PARTS -----		
-34	AN525-10R16	SCREW -----	1	P
-35	S1357-3	WASHER -----	1	P
-36	AN960PD10L	WASHER -----	2	P
-37	NAS430D3-24	SPACER -----	1	P
-38	MS21044N3	NUT -----	1	P
		-----*		

CONTINUED ON NEXT PAGE

FIGURE AND INDEX NO.	PART NUMBER	DESCRIPTION	UNITS PER ASSY	USABLE ON CODE
			1 2 3 4 5 6 7	
50 -39	C733001-0101	TWIN PACK ASSY-BEVERAGE -----	1	K
-40	S1021A10-16	SCREW -----	2	K
-41	01	FILLER LFC -----	2	K
-42	C733001-0103	STOPPER -----	2	K
-43	1195-0061	CAP LFC -----	2	K
	10004-98	JACK POINT NOT ILLUSTRATED -----	1	L
	0441215-1	JACK PAD ASSY NOT ILLUSTRATED -----	1	M
	SEE FIG 14	CUP-FUEL SAMPLER -----	1	
<p>NOTE. THIS PART NUMBER MUST HAVE A SECOND DASH NUMBER ADDED TO DENOTE COLOR. REFER TO HOW TO ORDER INTERIOR PARTS - PAGE VII.</p> <p>A---150 SERIAL 15071129 THRU 15072628            F150 SERIAL F15000530 THRU F15000738            A150 SERIAL A1500001 THRU A1500276            FA150 SERIAL FA1500001 THRU FA1500166</p> <p>B---150 SERIAL 15072629 THRU 15074384            F150 SERIAL F15000739 THRU 15000943            A150 SERIAL A1500277 THRU A1500389            FA150 SERIAL FA1500167 THRU FA1500211</p> <p>C---150 SERIAL 15074385 &amp; ON            F150 SERIAL F15000944 &amp; ON            A150 SERIAL A1500390 &amp; ON            FA150 SERIAL FA1500212 &amp; ON</p> <p>D---150 SERIAL 15071129 THRU 15073658            F150 SERIAL F15000530 THRU F15000863            A150 SERIAL A1500001 THRU A1500342            FA150 SERIAL FA1500001 THRU FA1500166</p> <p>E---150 SERIAL 15073659 &amp; ON            F150 SERIAL F15000864 &amp; ON            A150 SERIAL A1500343 &amp; ON            FA150 SERIAL FA1500167 &amp; ON</p> <p>F---150 SERIAL 15071129 THRU 15072519            F150 SERIAL F15000530 THRU F15000738            A150 SERIAL A1500001 THRU A1500263            FA150 SERIAL FA1500001 THRU FA1500161</p> <p>G---150 SERIAL 15072520 &amp; ON            F150 SERIAL F15000739 &amp; ON            A150 SERIAL A1500264 &amp; ON            FA150 SERIAL FA1500162 &amp; ON</p> <p>H---150 SERIAL 15071129 THRU 15071649            F150 SERIAL F15000530 THRU F15000658            A150 SERIAL A1500001 THRU A1500135            FA150 SERIAL FA1500001 THRU FA1500081</p> <p>J---150 SERIAL 15071650 &amp; ON            F150 SERIAL F15000659 &amp; ON            A150 SERIAL A1500136 &amp; ON            FA150 SERIAL FA1500082 &amp; ON</p> <p>K---150 SERIAL 15071129 &amp; ON            A150 SERIAL A1500001 &amp; ON</p> <p>L---150 SERIAL 15071129 THRU 15072003            F150 SERIAL F15000530 THRU F15000658            A150 SERIAL A1500001 THRU A1500226            FA150 SERIAL FA1500001 THRU FA1500081</p> <p>M---150 SERIAL 15072004 THRU 15073284            F150 SERIAL F15000659 THRU F15000833            A150 SERIAL A1500227 THRU A1500324            FA150 SERIAL FA1500082 THRU FA1500166</p> <p>N---150 SERIAL 15072629 THRU 15077005            F150 SERIAL F15000739 THRU F15001248            A150 SERIAL A1500277 THRU A1500609            FA150 SERIAL FA1500122 THRU FA1500281</p> <p>P---150 SERIAL 15077006 THRU 15078505            F150 SERIAL F15001249 THRU F15001338            A150 SERIAL A1500610 THRU A1500684            FA150 SERIAL FA1500282 THRU FA1500311</p>				



FIGURE AND INDEX NO.	PART NUMBER	DESCRIPTION							UNITS PER ASSY	USABLE ON CODE
		1	2	3	4	5	6	7		
50A-		SEAT BELT & SHOULDER HARNESS INSTALLATION -----							NP	AK
- 1	S2029-1	SHOULDER HARNESS ASSY -----							2	A
- 2	0411936-2	HOOK-SHOULDER HARNESS -----							2	A
- 3	AN4-4A	BOLT -----							2	A
- 4	S2275F202 *	SHOULDER HARNESS ASSY FIESTA RED -----							2	B
	S2275H202 *	SHOULDER HARNESS ASSY HOLIDAY BLUE -----							2	B
	S2275G202 *	SHOULDER HARNESS ASSY PICNIC GREEN -----							2	C
	S2275W202 *	SHOULDER HARNESS ASSY CLOVE BROWN -----							2	D
	S2275A202 *	SHOULDER HARNESS ASSY TAHITIAN RED -----							2	E
	S2275L202 *	SHOULDER HARNESS ASSY BOGGOTA BLUE -----							2	F
	S2275C202 *	SHOULDER HARNESS ASSY CYPRUS GREEN -----							2	F
	S2275R202 *	SHOULDER HARNESS ASSY DRAGON RED -----							2	G
	S2275P202 *	SHOULDER HARNESS ASSY ROYAL BLUE -----							2	G
	S2275D202 *	SHOULDER HARNESS ASSY TAN -----							2	G
	S2275S202 *	SHOULDER HARNESS ASSY VELDT GOLD -----							2	G
	S2275W202 *	SHOULDER HARNESS ASSY JAVA GOLD -----							2	H
	S2275U202 *	SHOULDER HARNESS ASSY PEACOCK BLUE -----							2	H
	S2275Z202 *	SHOULDER HARNESS ASSY POPPEY RED -----							2	H
	S2275AA202 *	SHOULDER HARNESS ASSY GOLDEN OLIVE -----							2	H
	S2275AA202 *	SHOULDER HARNESS ASSY OLIVE GREEN -----							2	J
	S2275BB202 *	SHOULDER HARNESS ASSY COPEN BLUE -----							2	J
	S2275CC202 *	SHOULDER HARNESS ASSY CHESTNUT BROWN -----							2	J
	S2275DD202 *	SHOULDER HARNESS ASSY OLD GOLD -----							2	J
	S2275T202 *	SHOULDER HARNESS ASSY SUNSET RED -----							2	J
		ATTACHING PARTS								
- 5	NAS464P4A8	BOLT -----							1	L
- 6	S2074-1	SPACER -----							2	P
- 7	S2074-1	SPACER -----							3	M
- 8	NAS43HT4-22	SPACER -----							1	N
- 9	AN960-616	WASHER -----							2	N
-10	S2076-1	COVER -----							1	P
-11	0415010-1	COVER -----							1	Q
		-----*-----								

CONTINUED ON NEXT PAGE

Fuselage Equipment (Cont)

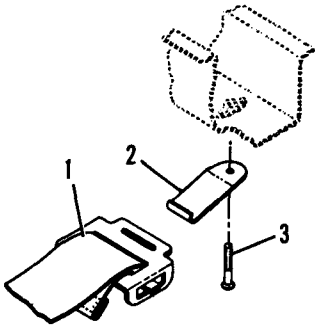

**CODE A**

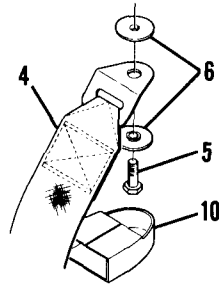

**CODE P**

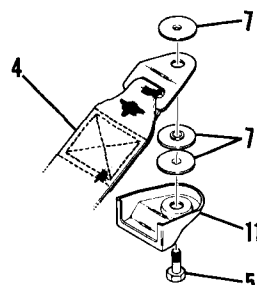

**CODE M**

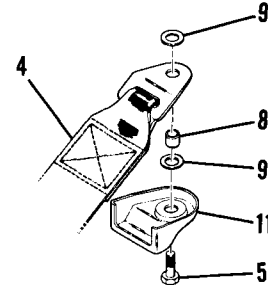

**CODE N**

150 & F150

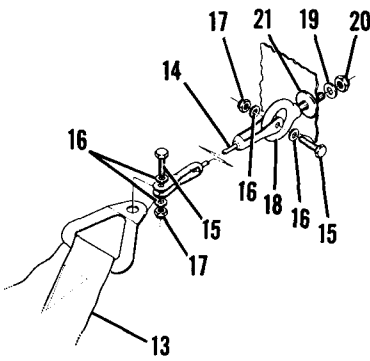

**A150 & FA150**

**Detail A**

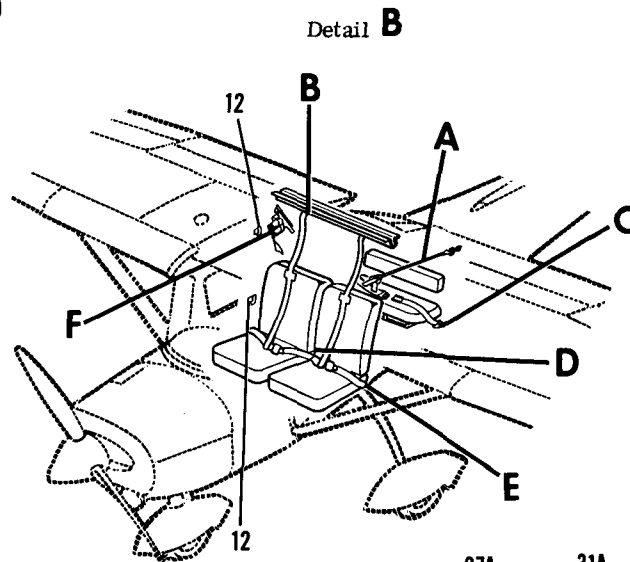

**Detail B**

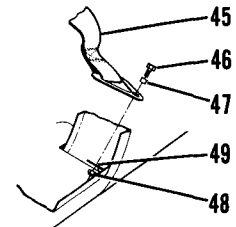

**Detail C**

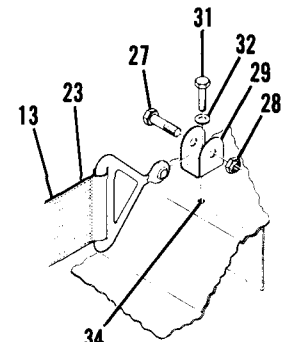

**1970 MODELS  
A150 & FA150**

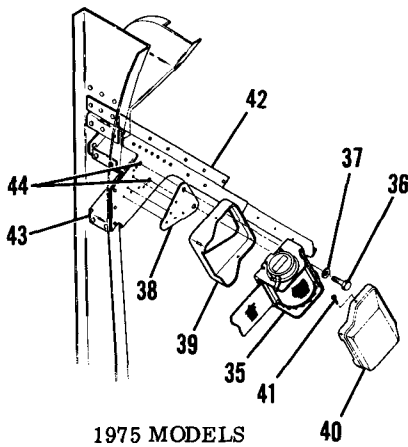

**1975 MODELS  
150 & F150**

**Detail F**

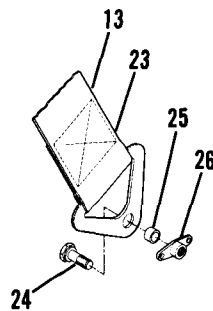

**Detail E**

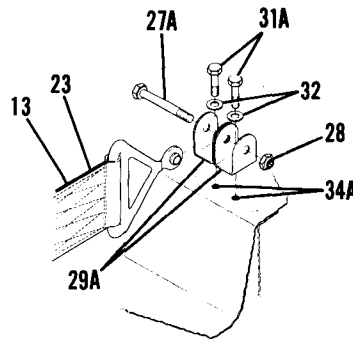

**1971 THRU 1975 MODELS  
150, F150, A150 & FA150**

**Detail D**

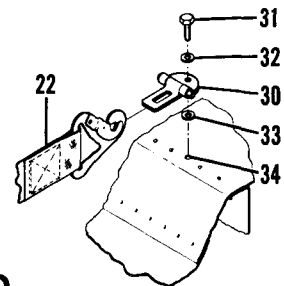

**1970 MODELS  
150 & F150**

**150 SERIAL 15071129 THRU 15077005  
F150 SERIAL F15000530 THRU F15001248  
A150 SERIAL A1500001 THRU A1500609  
FA150 SERIAL FA1500001 THRU FA1500281**

Figure 50A. Seat Belt & Shoulder Harness Installation

FIGURE AND INDEX NO.	PART NUMBER	DESCRIPTION	UNITS PER ASSY	USABLE ON CODE
50A-12	S2081-1	CLIP SHOULDER HARNESS STORAGE ATTACHING PARTS	4	R
	S2081-2	COVER	1	R
	0414032-1	DOUBLER	1	R
	S1023A6-8C	SCREW	1	R
		-----*		
-13	S1996-1	SHOULDER HARNESS & SEAT BELT ASSY AEROBAT	2	S
	S1996-7	SHOULDER HARNESS & SEAT BELT ASSY AEROBAT	2	T
-14	0414024-1	CABLE ASSY	2	U
	0414024-4	CABLE ASSY	2	V
-15	AN3-6A	BOLT	4	U
	AN5-7A	BOLT	4	V
-16	AN960-10	WASHER	8	U
	AN960-516L	WASHER	8	V
-17	MS21044N3	NUT	4	U
	MS21042L5	NUT	4	V
-18	0511165	EYEBOLT	2	W
-19	AN960-416	WASHER	2	W
-20	MS21042L4	NUT	2	W
-21	AN970-4	WASHER	2	X
-22	S162286	BELT ASSY-SEAT BLACK 150 ONLY	2	Y
	S1746815	BELT ASSY-SEAT BLACK F150 ONLY	2	Z
-23	S2275F104	BELT ASSY-SEAT FIESTA RED	2	B
	S2275H104	BELT ASSY-SEAT HOLIDAY BLUE	2	B
	S2275G104	BELT ASSY-SEAT PICNIC GREEN	2	C
	S2275W104	BELT ASSY-SEAT CLOVE BROWN	2	D
	S2275A104	BELT ASSY-SEAT TAHITIAN RED	2	E
	S2275L104	BELT ASSY-SEAT BOGOTA BLUE	2	F
	S2275C104	BELT ASSY-SEAT CYPRUS BLUE	2	F
	S2275R104	BELT ASSY-SEAT DRAGON RED	2	G
	S2275P104	BELT ASSY-SEAT ROYAL BLUE	2	G
	S2275D104	BELT ASSY-SEAT TAN	2	G
	S2275S104	BELT ASSY-SEAT VELDT GOLD	2	G
	S2275W104	BELT ASSY-SEAT JAVA GOLD	2	H
	S2275U104	BELT ASSY-SEAT PEACOCK BLUE	2	H
	S2275Z104	BELT ASSY-SEAT POPPY RED	2	H
	S2275AA104	BELT ASSY-SEAT GOLDEN OLIVE	2	H
	S2275AA104	BELT ASSY-SEAT OLIVE GREEN	2	J
	S2275BB104	BELT ASSY-SEAT COPEN BROWN	2	J
	S2275CC104	BELT ASSY-SEAT CHESTNUT BROWN	2	J
	S2275DD104	BELT ASSY-SEAT OLD GOLD	2	J
	S2275T104	BELT ASSY-SEAT SUNSET RED	2	J
-24	AN525-416R9	BOLT-SEAT BELT	2	AF
	AN4-5A	BOLT-SEAT BELT	2	AG
	NAS464-4-5	BOLT-SEAT BELT	2	AJ
-25	NAS43HT4-12	SPACER-SEAT BELT	2	AA
	0413496-2	BUSHING-SEAT BELT	2	W
-26	NAS1068A4	NUTPLATE-SEAT BELT	2	AB
	NAS696A4	NUTPLATE-SEAT BELT	2	AH
	NAS680A4	NUTPLATE-SEAT BELT	2	AJ
-27	AN5-11A	BOLT-SEAT BELT	1	U
-27A	AN5-21A	BOLT-SEAT BELT	1	AC
-28	MS21042L5	NUT-SEAT BELT	1	AD
-29	0413496-1	BRACKET-SEAT BELT ATTACH	1	U
-29A	0413496-1	BRACKET-SEAT BELT ATTACH	2	AH
	0414045-1	BRACKET ASSY-SEAT BELT ATTACH	1	AJ
-30	0711083-1	LATCH ASSY-SEAT BELT ATTACHING PARTS	1	A
-31	AN4-10A	BOLT	1	AB
-31A	AN4-7A	BOLT	1	AC
-32	AN960-416L	WASHER	1	
-33	AN960-4	WASHER	1	AB
-34	NAS698A4	NUTPLATE	1	AB
-34A	NAS696A4	NUTPLATE	1	AC
		-----*		

CONTINUED ON NEXT PAGE

FIGURE AND INDEX NO.	PART NUMBER	DESCRIPTION	UNITS PER ASSY	USABLE ON CODE
50A-		INERTIA REEL SEAT BELT & SHOULDER HARNESS INSTL -----	NP	K
-35	S2199-6	BELT ASSY-INERTIA REEL RH SEAT BLACK ONLY -----	1	
	S2199-5	BELT ASSY-INERTIA REEL LH SEAT BLACK ONLY -----	1	
		ATTACHING PARTS -----		
-36	NAS464P4A6	BOLT -----	2	
-37	AN960-416L	WASHER -----	2	
-38	0415015-1	SPACER -----	1	
-39	0415014-1	COVER-BOTTOM -----	1	
		-----*		
-40	0415014-2	COVER-TOP -----	1	
		ATTACHING PARTS -----		
-41	S102124-6	SCREW -----	2	
		-----*		
-42	0412018-2	REINFORCEMENT-RH -----	1	
	0412018-1	REINFORCEMENT-LH -----	1	
-43	0412017-2	BRACKET ASSY-RH -----	1	
	0412017-1	BRACKET ASSY-LH -----	1	
-44	NAS696A4	NUTPLATE -----	2	
-45	S1618B3	BELT ASSY-AUXILIARY SEAT BLACK -----	1	Y
	S1746B2	BELT ASSY-AUXILIARY SEAT BLACK -----	1	AE
	S1746F2	BELT ASSY-AUXILIARY SEAT FIESTA RED -----	1	B
	S1746H2	BELT ASSY-AUXILIARY SEAT HOLIDAY BLUE -----	1	B
	S1746G2	BELT ASSY-AUXILIARY SEAT PICNIC GREEN -----	1	C
	S1746W2	BELT ASSY-AUXILIARY SEAT CLOVE BROWN -----	1	D
	S1746A2	BELT ASSY-AUXILIARY SEAT TAHITIAN RED -----	1	E
	S1746L2	BELT ASSY-AUXILIARY SEAT BOGOTA BLUE -----	1	F
	S1746C2	BELT ASSY-AUXILIARY SEAT CYPRUS GREEN -----	1	F
	S1746R2	BELT ASSY-AUXILIARY SEAT DRAGON RED -----	1	G
	S1746P2	BELT ASSY-AUXILIARY SEAT ROYAL BLUE -----	1	G
	S1746D2	BELT ASSY-AUXILIARY SEAT TAN -----	1	G
	S1746S2	BELT ASSY-AUXILIARY SEAT VELDT GOLD -----	1	G
	S1746W2	BELT ASSY-AUXILIARY SEAT JAVA GOLD -----	1	H
	S1746U2	BELT ASSY-AUXILIARY SEAT PEACOCK BLUE -----	1	H
	S1746Z2	BELT ASSY-AUXILIARY SEAT POPPY RED -----	1	H
	S1746AA2	BELT ASSY-AUXILIARY SEAT GOLDEN OLIVE -----	1	H
	S1746AA2	BELT ASSY-AUXILIARY SEAT OLIVE GREEN -----	1	J
	S1746BB2	BELT ASSY-AUXILIARY SEAT COPEN BLUE -----	1	J
	S1746CC2	BELT ASSY-AUXILIARY SEAT CHESTNUT BROWN -----	1	J
	S1746DD2	BELT ASSY-AUXILIARY SEAT OLD GOLD -----	1	J
	S1746T2	BELT ASSY-AUXILIARY SEAT SUNSET RED -----	1	J
		ATTACHING PARTS -----		
-46	AN4-6A	BCLT -----	2	
-47	NAS43HT4-20	SPACER -----	2	
-48	MS21042L4	NUT -----	2	
		-----*		
-49	SEE FIG 29	LUG-SEAT BELT ATTACH -----	2	
<p>NOTE. *WHEN INITIALLY ORDERING THIS PART BOTH SEAT BELT &amp; SHOULDER HARNESS MUST BE ORDERED.</p> <p>A---150 SERIAL 15071129 THRU 15072003                      F150 SERIAL F15000530 THRU F15000658                      B---150 SERIAL 15072004 THRU 15072628                      C---150 SERIAL 15072004 THRU 15072628                      F150 SERIAL F15000659 THRU F15000738                      D---150 SERIAL 15072004 THRU 15073658                      F150 SERIAL F15000659 THRU F15000738                      E---150 SERIAL 15072629 THRU 15073658                      F---150 SERIAL 15072629 THRU 15073658                      F150 SERIAL F15000739 THRU F15000843                      G---150 SERIAL 15073659 THRU 15073966                      F150 SERIAL F15000864 THRU F15000943</p>				
<p>CONTINUED ON NEXT PAGE</p>				

FIGURE AND INDEX NO.	PART NUMBER	DESCRIPTION	UNITS PER ASSY	USABLE ON CODE
		<b>1 2 3 4 5 6 7</b>		
50A-		H---150 SERIAL 15073967 THRU 15074850 F150 SERIAL F15000944 THRU F15001013 J---150 SERIAL 15074851 THRU 15077005 F150 SERIAL F15001014 THRU F15001248 K---150 SERIAL 15075782 THRU 15077005 F150 SERIAL F15001144 THRU F15001248 L---150 SERIAL 15072004 THRU 15077005 F150 SERIAL F15000659 THRU F15001248 M---150 SERIAL 15075480 THRU 15075747 F150 SERIAL F15001134 THRU F15001143 N---150 SERIAL 15075748 THRU 15077005 F150 SERIAL F15001144 THRU F15001248 P---150 SERIAL 15072004 THRU 15075479 F150 SERIAL F15000659 THRU F15001133 Q---150 SERIAL 15075480 THRU 15077005 F150 SERIAL F15001144 THRU F15001248 R---150 SERIAL 15072004 THRU 15074850 F150 SERIAL F15000659 THRU F15001013 S---A150 SERIAL A1500001 THRU A1500342 FA150 SERIAL FA1500001 THRU FA1500166 T---A150 SERIAL A1500343 THRU A1500609 FA150 SERIAL FA1500167 THRU FA1500281 U---A150 SERIAL A1500001 THRU A1500226 FA150 SERIAL FA1500001 THRU FA1500081 V---A150 SERIAL A1500227 THRU A1500609 FA150 SERIAL FA1500082 THRU FA1500281 W---A150 SERIAL A1500001 THRU A1500609 FA150 SERIAL FA1500001 THRU FA1500281 X---A150 SERIAL A1500430 THRU A1500609 FA150 SERIAL FA1500212 THRU FA1500281 Y---150 SERIAL 15071129 THRU 15072003 Z---F150 SERIAL F15000530 THRU F15000658 AA---150 SERIAL 15071129 THRU 15077005 F150 SERIAL F15000530 THRU F15001248 AB---150 SERIAL 15071129 THRU 15072003 F150 SERIAL F15000530 THRU F15000658 A150 SERIAL A1500001 THRU A1500226 FA150 SERIAL FA1500001 THRU FA1500081 AC---150 SERIAL 15072004 THRU 15077005 F150 SERIAL F15000659 THRU F15001248 A150 SERIAL A1500227 THRU A1500609 FA150 SERIAL FA1500082 THRU FA1500281 AD---150 SERIAL 15072004 THRU 15077005 F150 SERIAL F15000659 THRU F15001248 A150 SERIAL A1500001 THRU A1500609 FA150 SERIAL FA1500001 THRU FA1500281 AE---150 SERIAL 15075782 THRU 15077005 F150 SERIAL F15000530 THRU F15000658, F15001144 THRU F15001248 A150 SERIAL A1500001 THRU A1500609 FA150 SERIAL FA1500001 THRU FA1500281 AF---150 SERIAL 15071129 THRU 15075781 F150 SERIAL F15000530 THRU F15001143 A150 SERIAL A1500001 THRU A1500276 F150 SERIAL FA1500001 THRU FA1500121 AG---A150 SERIAL A1500277 THRU A1500523 FA150 SERIAL FA1500122 THRU FA1500261 AH---150 SERIAL 15072004 THRU 15075781 F150 SERIAL F15000659 THRU F15001143 A150 SERIAL A1500227 THRU A1500523 FA150 SERIAL FA1500082 THRU FA1500261 AJ---150 SERIAL 15075782 THRU 15077005 F150 SERIAL F15001144 THRU F15001248 A150 SERIAL A1500524 THRU A1500609 FA150 SERIAL FA1500262 THRU FA1500281 AK---150 SERIAL 15071129 THRU 15077005 F150 SERIAL F15000530 THRU F15001248 A150 SERIAL A1500001 THRU A1500609 FA150 SERIAL FA1500001 THRU FA1500281		

Fuselage Equipment (Cont)

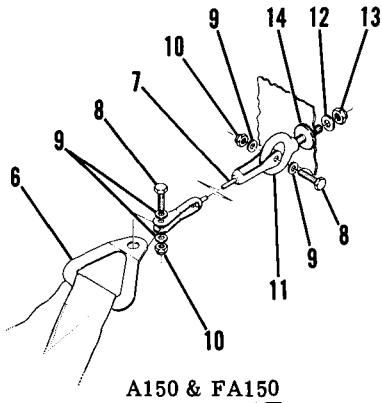

A150 & FA150

Detail **A**

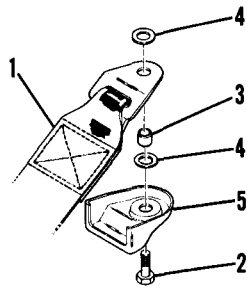

150 & F150

Detail **B**

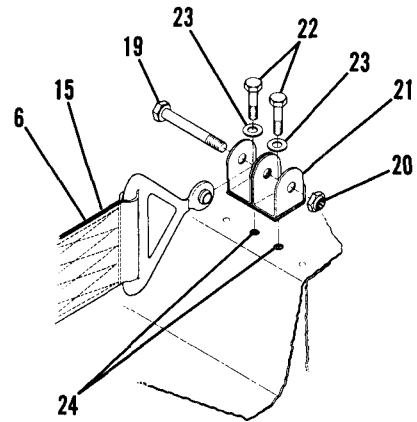

Detail **C**

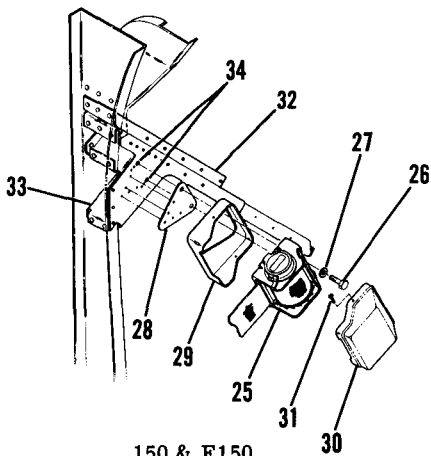
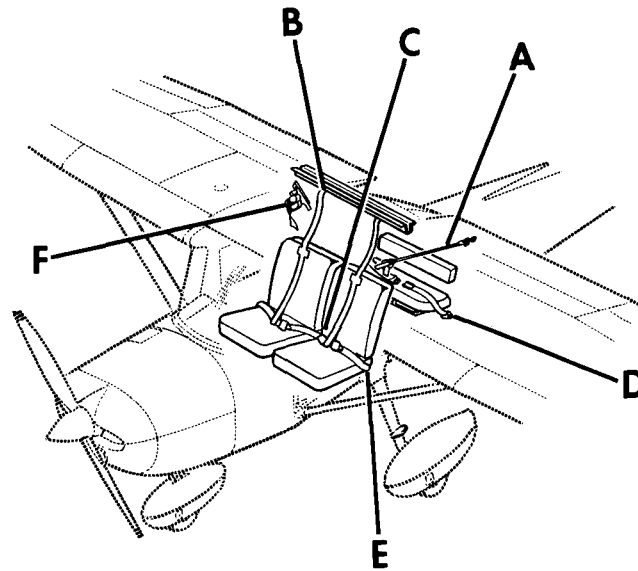

150 & F150

Detail **F**

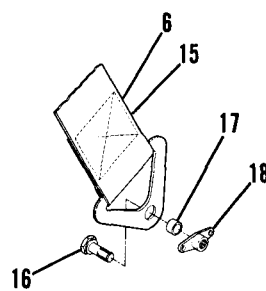

Detail **E**

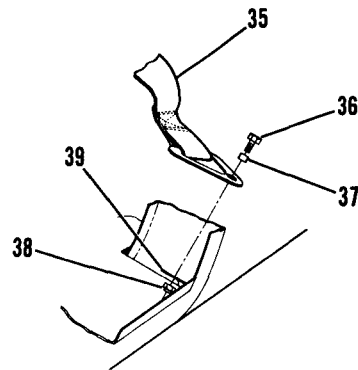

Detail **D**

**150 SERIAL 15077006 & ON  
 F150 SERIAL F15001249 & ON  
 A150 SERIAL A1500610 & ON  
 FA150 SERIAL FA1500282 & ON**

Figure 50B. Seat Belt & Shoulder Harness Installation

FIGURE AND INDEX NO.	PART NUMBER	DESCRIPTION	UNITS PER ASSY	USABLE ON CODE
		<b>1 2 3 4 5 6 7</b>		
508-		SEAT BELT & SHOULDER HARNESS INSTALLATION -----	NP	A
- 1	S2275GG202 *	SHOULDER HARNESS ASSY ORO GREEN -----	2	B
	S2275FF202 *	SHOULDER HARNESS ASSY SAPPHIRE BLUE -----	2	B
	S2275CC202 *	SHOULDER HARNESS ASSY CHESTNUT BROWN -----	2	B
	S2275HH202 *	SHOULDER HARNESS ASSY TOPAZ GOLD -----	2	B
	S2275EE202 *	SHOULDER HARNESS ASSY RUBY RED -----	2	B
		ATTACHING PARTS		
- 2	NAS464P4A8	BOLT -----	1	B
- 3	NAS43HT4-22	SPACER -----	1	B
- 4	AN960-616	WASHER -----	2	B
- 5	0415010-1	COVER -----	1	B
		*-----		
- 6	S1996-7	SHOULDER HARNESS & SEAT BELT ASSY AEROBAT -----	2	C
- 7	0414024-4	CABLE ASSY -----	2	C
- 8	AN5-7A	BOLT -----	4	C
- 9	AN960-516L	WASHER -----	8	C
-10	MS21042L5	NUT -----	4	C
-11	0511165	EYEBGLT -----	2	C
-12	AN960-416	WASHER -----	2	C
-13	MS21042L4	NUT -----	2	C
-14	AN970-4	WASHER -----	2	C
-15	S2275GG104 *	BELT ASSY-SEAT ORO GREEN -----	2	B
	S2275FF104 *	BELT ASSY-SEAT SAPPHIRE BLUE -----	2	B
	S2275CC104 *	BELT ASSY-SEAT CHESTNUT BROWN -----	2	B
	S2275HH104 *	BELT ASSY-SEAT TOPAZ GOLD -----	2	B
	S2275EE104 *	BELT ASSY-SEAT RUBY RED -----	2	B
-16	NAS464-4-5	BOLT-SEAT BELT -----	2	
-17	NAS43HT4-12	SPACER-SEAT BELT -----	2	B
	0413496-2	BUSHING-SEAT BELT -----	2	C
-18	NAS680A4	NUTPLATE-SEAT BELT -----	2	B
-19	AN5-21A	BOLT-SEAT BELT -----	1	
-20	MS21042L5	NUT-SEAT BELT -----	1	
-21	0414045-1	BRACKET ASSY-SEAT BELT ATTACH -----	1	C
		ATTACHING PARTS		
-22	AN4-7A	BOLT -----	2	
-23	AN960-416L	WASHER -----	2	
-24	NAS696A4	NUTPLATE -----	2	
		*-----		
-25	S2199-6	INERTIA REEL SEAT BELT & SHOULDER HARNESS INSTALLATION -----	NP	B
	S2199-5	BELT ASSY-INERTIA REEL RH SEAT BLACK ONLY -----	1	
		BELT ASSY-INERTIA REEL LH SEAT BLACK ONLY -----	1	
		ATTACHING PARTS		
-26	NAS464P4A6	BOLT -----	2	
-27	AN960-416L	WASHER -----	2	
-28	0415015-1	SPACER -----	1	
-29	0415014-1	COVER-BOTTOM -----	1	
		*-----		
-30	0415014-2	COVER-TOP -----	1	
		ATTACHING PARTS		
-31	S1021Z4-6	SCREW -----	2	
		*-----		
-32	0412018-2	REINFORCEMENT-RH -----	1	
	0412018-1	REINFORCEMENT-LH -----	1	
-33	0412017-2	BRACKET ASSY-RH -----	1	
	0412017-1	BRACKET ASSY-LH -----	1	
-34	NAS696A4	NUTPLATE -----	2	
-35	S1746B2	BELT ASSY-AUXILIARY SEAT BLACK -----	1	B
	S1746GG2	BELT ASSY-AUXILIARY SEAT ORO GREEN -----	1	B
	S1746FF2	BELT ASSY-AUXILIARY SEAT SAPPHIRE BLUE -----	1	B
	S1746CC2	BELT ASSY-AUXILIARY SEAT CHESTNUT BROWN -----	1	B
	S1746HH2	BELT ASSY-AUXILIARY SEAT TOPAZ GOLD -----	1	B
	S1746EE2	BELT ASSY-AUXILIARY SEAT RUBY RED -----	1	B
		ATTACHING PARTS		
-36	AN4-6A	BOLT -----	2	
-37	NAS43HT4-20	SPACER -----	2	
-38	MS21042L4	NUT -----	2	
		*-----		

CONTINUED ON NEXT PAGE

FIGURE AND INDEX NO.	PART NUMBER	DESCRIPTION	UNITS PER ASSY	USABLE ON CODE
508-39	SEE FIG. 29	<p><b>1 2 3 4 5 6 7</b></p> <p>LUG-SEAT BELT ATTACH -----</p> <p>NOTE. *WHEN INITIALLY ORDERING THIS PART FOR AIRCRAFT PRIOR TO SERIALS 15077380 &amp; F15001339 BOTH SEAT BELT &amp; SHOULDER HARNESS MUST BE ORDERED.</p> <p>A---150 SERIAL 15077006 &amp; ON                      F150 SERIAL F15001249 &amp; ON                      A150 SERIAL A1500610 &amp; ON                      FA150 SERIAL FA1500282 &amp; ON</p> <p>B---150 SERIAL 15077006 &amp; ON                      F150 SERIAL F15001249 &amp; ON</p> <p>C---A150 SERIAL A1500610 &amp; ON                      FA150 SERIAL FA1500282 &amp; ON</p>	2	



Fuselage Equipment (Cont)

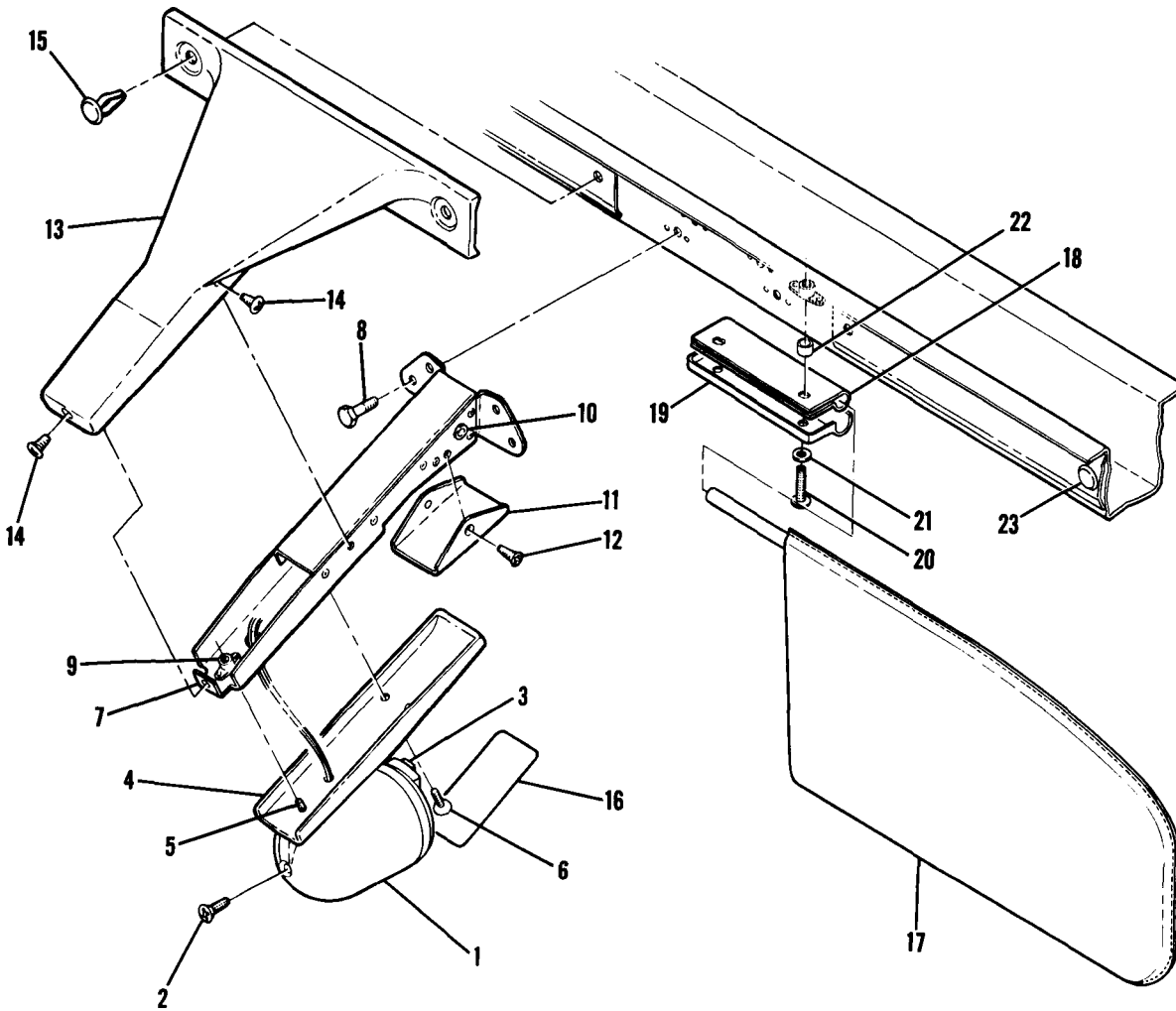

150 SERIAL 15071129 THRU 15073658  
F150 SERIAL F15000530 THRU F15000863  
A150 SERIAL A1500001 THRU A1500342  
FA150 SERIAL FA1500001 THRU FA1500166

Figure 51. Compass & Sun Visor Installation

FIGURE AND INDEX NO.	PART NUMBER	DESCRIPTION	UNITS PER ASSY	USABLE ON CODE
51 -		<b>1 2 3 4 5 6 7</b>		
- 1	C660501-0101	COMPASS & SUN VISOR INSTALLATION -----	NP	C
- 2	S1571-8-10	COMPASS ----- ATTACHING PARTS	1	
- 3	MS25237-330	SCREW -----	1	
- 4	0713813-1	-----*----- BULB-COMPASS -----	1	
- 5	AN51586R12	MOUNT-COMPASS -----	1	
- 6	AN96008	ATTACHING PARTS		
- 6	AN507B832R6	SCREW -----	1	
- 7	0413474-1	WASHER -----	1	
- 8	AN3-3A	SCREW -----	2	
- 9	NAS697A08	-----*----- SUPPORT ASSEMBLY-COMPASS MOUNT -----	1	
-10	S1291-2	ATTACHING PARTS		
-11	0413478-1	BOLT -----	4	
-12	S102226-6	-----*----- NUTPLATE -----	3	
-13	0413475-1	GROMMET -----	1	
-14	S102126-6	COVER-COMPASS MOUNT SUPPORT LOWER -----	1	
-15	S2090-1	ATTACHING PARTS		
-15	AN51586R10	SCREW -----	2	
-16	0713819-1	-----*----- COVER-COMPASS MOUNT SUPPORT -----	1	A
-17	1414087-13	ATTACHING PARTS		B
-18	1414087-15	SCREW -----	3	
-19	0413504-1	PLUG BUTTON UC -----	2	A
-20	AN525-10R14	SCREW -----	4	B
-21	AN960-10L	SCREW -----	4	B
-22	NAS43HT3-20	SPACER -----	2	B
-23	S1898-4	-----*----- CARD-COMPASS CORRECTION -----	1	
		SUN VISOR ASSEMBLY -----	2	
		CLAMP -----	1	
		COVER-SUN VISOR SUPPORT -----	1	
		ATTACHING PARTS		
		SCREW -----	2	
		WASHER -----	2	
		SPACER -----	2	
		-----*----- PLUG BUTTON UC -----	2	
		NOTE. #THIS PART NUMBER MUST HAVE A SECOND DASH NUMBER ADDED TO DENOTE COLOR. REFER TO HOW TO ORDER UPHOLSTERED PARTS-PAGE VI.		
		NOTE. □THIS PART NUMBER MUST HAVE A SECOND DASH NUMBER ADDED TO DENOTE COLOR. REFER TO HOW TO ORDER INTERIOR PARTS-PAGE VII.		
		A---150 SERIAL 15071129 THRU 15072628 F150 SERIAL F15000530 THRU F15000738 A150 SERIAL A1500001 THRU A1500276 FA150 SERIAL FA1500001 THRU FA1500121		
		B---150 SERIAL 15072629 THRU 15073658 F150 SERIAL F15000739 THRU F15000863 A150 SERIAL A1500277 THRU A1500342 FA150 SERIAL FA1500122 THRU FA1500166		
		C---150 SERIAL 15071129 THRU 15073658 F150 SERIAL F15000530 THRU F15000863 A150 SERIAL A1500001 THRU A1500342 FA150 SERIAL FA1500001 THRU FA1500166		

Fuselage Equipment (Cont)

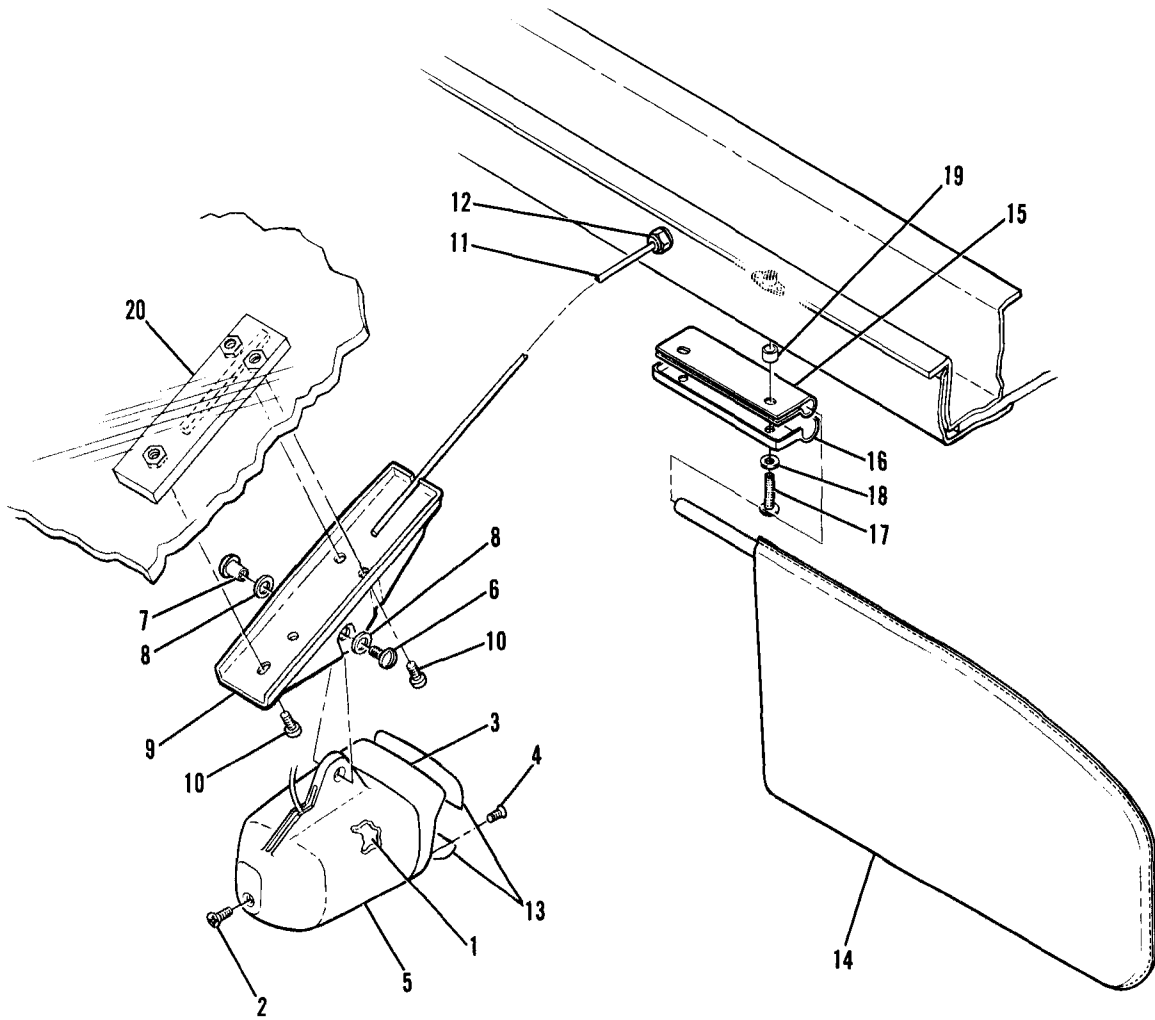

150 SERIAL 15073659 & ON  
F150 SERIAL F15000864 & ON  
A150 SERIAL A1500343 & ON  
FA150 SERIAL FA1500167 & ON

Figure 51A. Compass & Sun Visor Installation

FIGURE AND INDEX NO.	PART NUMBER	DESCRIPTION	UNITS PER ASSY	USABLE ON CODE
		<b>1 2 3 4 5 6 7</b>		
51A-		COMPASS & SUN VISOR INSTALLATION -----	NP	A
- 1	C660501-0101	COMPASS -----	1	
		ATTACHING PARTS -----		
- 2	AN5078832R14	SCREW -----	1	
		-----*		
	MS25237-330	BULB-COMPASS -----	1	
- 3	0413517-15	BEZEL-COMPASS -----	1	
		ATTACHING PARTS -----		
- 4	AN510B4R8	SCREW -----	2	
		-----*		
- 5	0413517-5	CUP-COMPASS -----	1	
		ATTACHING PARTS -----		
- 6	D366	SCREW -----	1	
- 7	D4023X.375	POST-SCREW -----	1	
- 8	AN960D10	WASHER -----	2	
		-----*		
- 9	0413517-3	BASE-COMPASS -----	1	
		ATTACHING PARTS -----		
-10	AN500B8-6	SCREW -----	3	
		-----*		
-11	0413441-1	TUBE ASSY -----	1	
		ATTACHING PARTS -----		
-12	S1216-3	NUT -----	1	
	AN936A416	WASHER -----	1	
	NAS620A416L	WASHER -----	1	
		-----*		
-13	0400213-6	PLACARD SET-COMPASS CORRECTION -----	1	
-14	1414087-13	SUN VISOR ASSEMBLY -----	1	
-15	1414087-15	CLAMP -----	1	
-16	0413504-1	COVER-SUN VISOR -----	1	
		ATTACHING PARTS -----		
-17	AN525-10R14	SCREW -----	2	
-18	AN960-10L	WASHER -----	2	
-19	NAS43HT3-20	SPACER -----	2	
		-----*		
-20	0413437-1	BASE PLATE ASSY-COMPASS MOUNT -----	1	
<p>NOTE. #THIS PART NUMBER MUST HAVE A SECOND DASH NUMBER ADDED TO DENOTE COLOR. REFER TO HOW TO ORDER UPHOLSTERED PARTS-PAGE VI.</p> <p>A---150 SERIAL 15073659 &amp; ON            F150 SERIAL F15000864 &amp; ON            A150 SERIAL A1500343 &amp; ON            FA150 SERIAL FA1500167 &amp; ON</p>				

Fuselage Equipment (Cont)

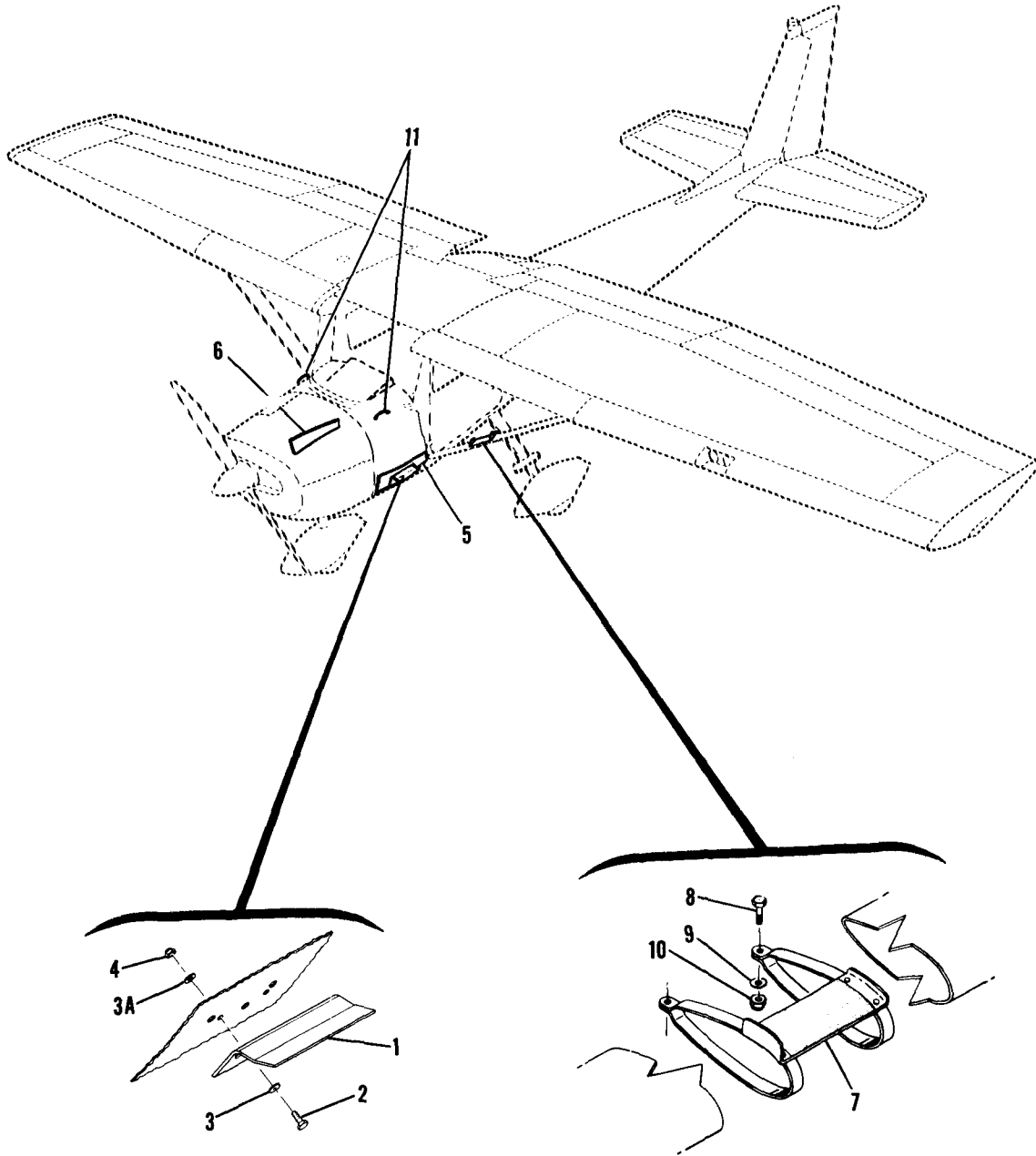
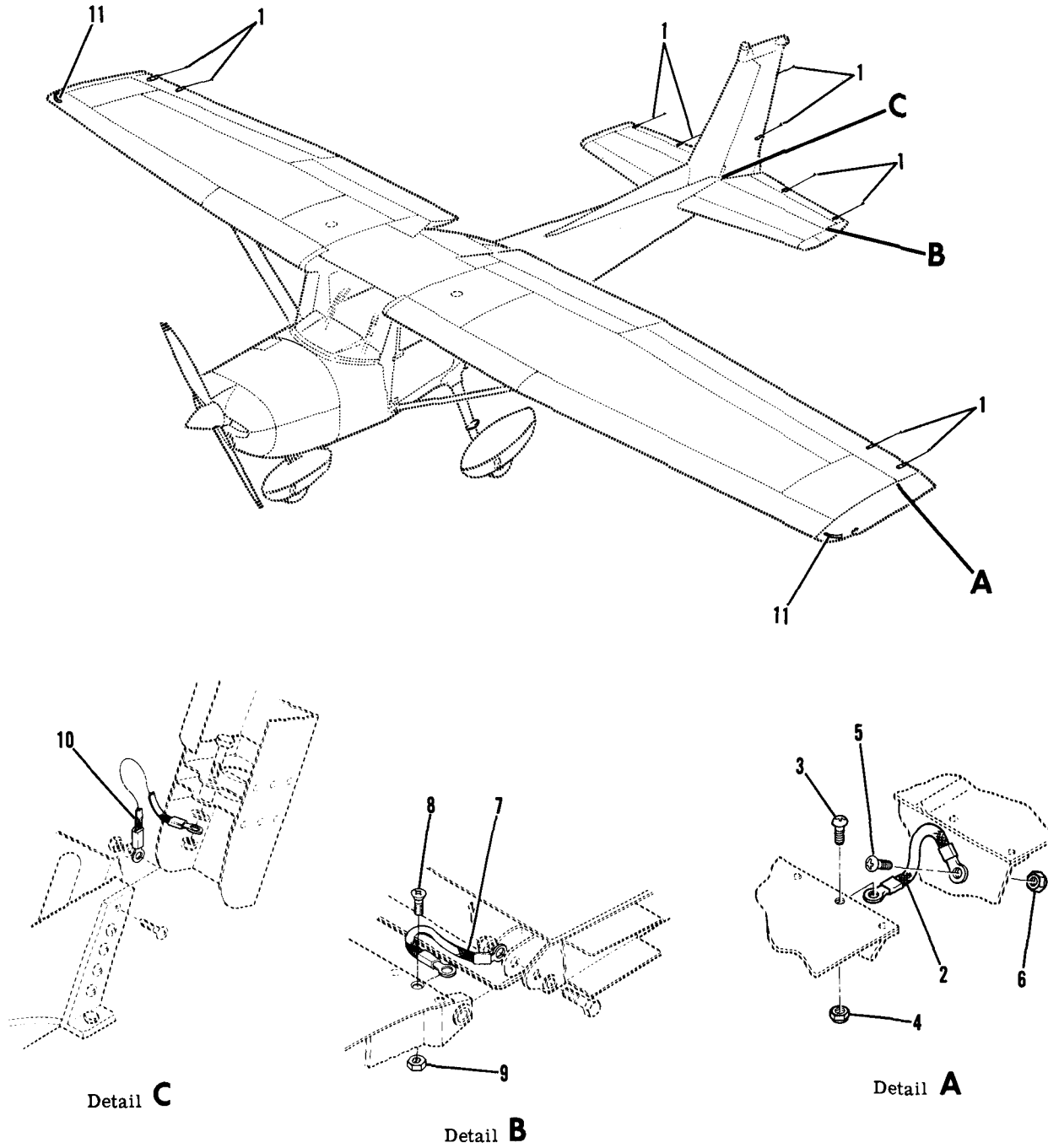

Figure 52. Refueling Step and Handle Installation

FIGURE AND INDEX NO.	PART NUMBER	DESCRIPTION	UNITS PER ASSY	USABLE ON CODE
		<b>1 2 3 4 5 6 7</b>		
52 -		REFUELING STEP & HANDLE INSTALLATION -----	NP	
- 1	0413399-1	STEP-LH -----	1	
	0413399-2	STEP-RH -----	1	
		ATTACHING PARTS		
- 2	AN3-5A	BOLT -----	2	
- 3	AN960D10L	WASHER -----	2	
- 3A	AN970-3	WASHER -----	2	
- 4	MS21044N3	NUT -----	2	
		---*---		
- 5	0413351-1	DOUBLER-LH -----	1	
- 6	0413351-2	DOUBLER-RH -----	1	
- 7	0500276-1	STEP ASSEMBLY-STRUT LH -----	1	A
	0500276-2	STEP ASSEMBLY-STRUT RH -----	1	A
	0500276-5	STEP ASSEMBLY-STRUT LH -----	1	B
	0500276-6	STEP ASSEMBLY-STRUT RH -----	1	B
		ATTACHING PARTS		
- 8	AN3-3A	BOLT -----	2	
- 9	AN960D10L	WASHER -----	2	
- 10	MS21044N3	NUT -----	2	
		---*---		
- 11	1613224-2	HANDLE-REFUELING -----	2	
		ATTACHING PARTS		
	S1450-4H12-050	WASHER UPPER -----	1	
	AN960-416L	WASHER LOWER -----	1	
	MS21042L4	NUT -----	1	
		---*---		
		A---150 SERIAL 15071129 & ON F150 SERIAL F15000530 & ON		
		B---A150 SERIAL A1500001 & ON FA150 SERIAL FA1500001 & ON		

Fuselage Equipment (Cont)



150 SERIAL 15077006 & ON  
F150 SERIAL F15001249 & ON  
A150 SERIAL A1500610 & ON  
FA150 SERIAL FA1500282 & ON

Figure 52A. Static Discharger Installation

FIGURE AND INDEX NO.	PART NUMBER	DESCRIPTION	UNITS PER ASSY	USABLE ON CODE
52A-		<b>1 2 3 4 5 6 7</b>		
- 1	C592001-0201	STATIC DISCHARGER INSTALLATION -----	NP	A
		WICK-STATIC DISCHARGE -----	10	
	S2230-1	ATTACHING PARTS -----		
		RIVET-BLIND -----	2	
		-----*		
- 2	1570102-19	STRAP ASSEMBLY-BONDED -----	2	
		ATTACHING PARTS -----		
- 3	AN515-8R6	SCREW -----	1	
- 4	MS21044N08	NUT -----	1	
- 5	AN525-10R6	SCREW -----	1	
- 6	MS21044N3	NUT -----	1	
		-----*		
- 7	1570102-20	STRAP ASSEMBLY-BONDED -----	2	
		ATTACHING PARTS -----		
- 8	AN515-8R6	SCREW -----	1	
- 9	MS21044N08	NUT -----	1	
		-----*		
-10	1570102-18	STRAP ASSEMBLY-BONDED -----	1	
-11	1570102-10	STRAP ASSEMBLY-BONDED -----	2	
		A---150 SERIAL 15077006 & ON F150 SERIAL F15001249 & ON A150 SERIAL A1500610 & ON FA150 SERIAL FA1500282 & ON		

Propeller

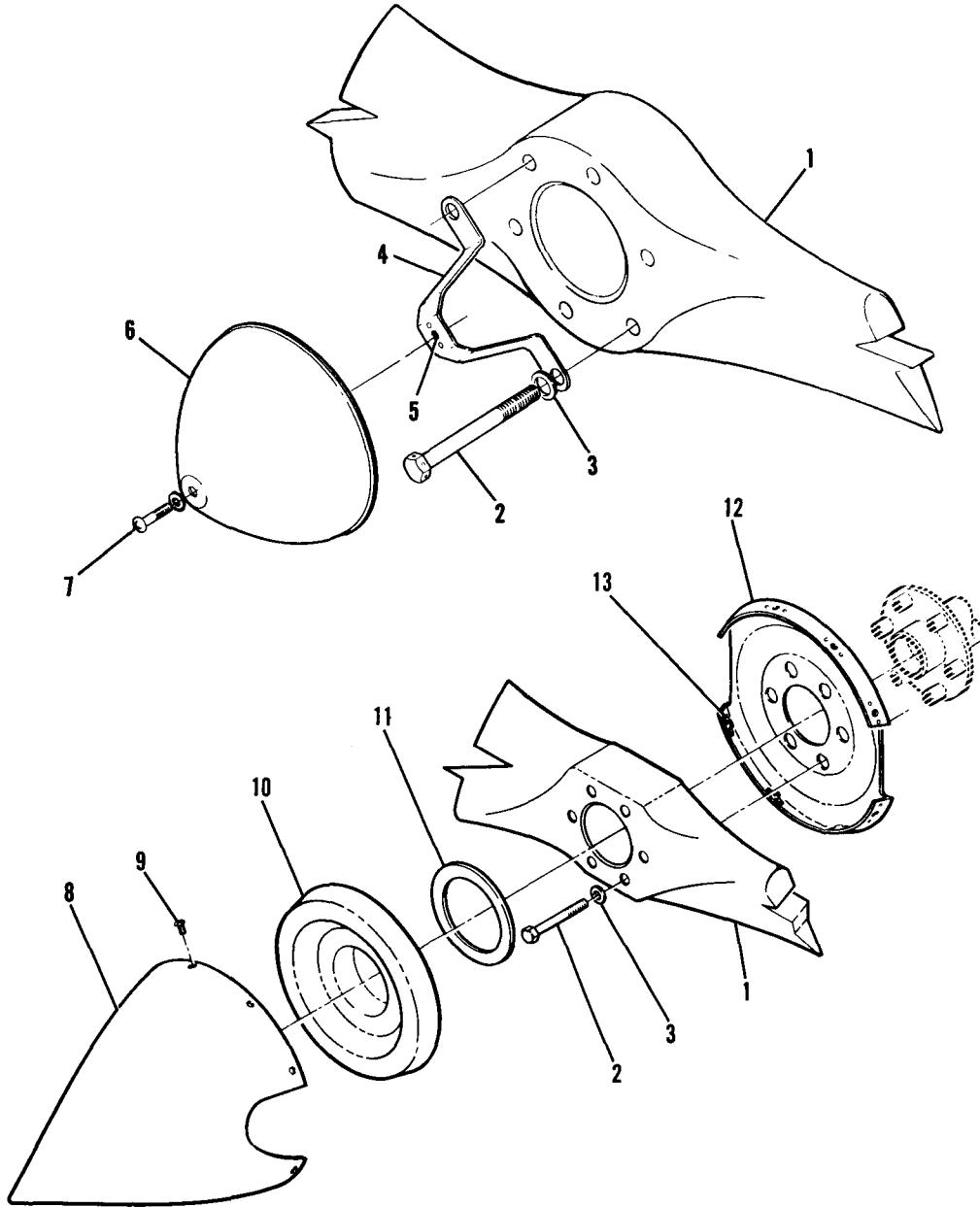

150 SERIAL 15071129 THRU 15072003  
F150 SERIAL F15000530 THRU F15000658  
A150 SERIAL A1500001 THRU A1500226  
FA150 SERIAL FA1500001 THRU FA1500081

Figure 53. Propeller and Spinner Installation

FIGURE AND INDEX NO.	PART NUMBER	DESCRIPTION	UNITS PER ASSY	USABLE ON CODE
53 -		PROPELLER & SPINNER INSTALLATION -----	NP	B
- 1	0450515-2 C161001-0203	PROPELLER-METAL 1A101/DCM6948 MCCAULEY ----- PROPELLER-FLOATPLANE 1A90/CF7535 MCCAULEY ----- ATTACHING PARTS -----	1 1 1	
- 2	A2513-8	BOLT MCL -----	6	
- 3	A1638-13	WASHER MCL -----	6	
	S1433-2	DECAL-CESSNA -----	1	
- 4	0450260	BRACKET ASSEMBLY-SPINNER -----	1	A
- 5	NAS680A08	NUTPLATE -----	1	A
- 6	0450516-1	SPINNER-PROPELLER ----- ATTACHING PARTS -----	1	A
- 7	AN515-8R14 AN96008	SCREW ----- WASHER -----	1 1	A A
		-----*		
- 8	0450027-12 *	SPINNER INSTALLATION-LARGE ----- SPINNER-PROPELLER ----- ATTACHING PARTS -----	NP 1	
- 9	AN525-832R7	SCREW -----	8	
		-----*		
-10	0450039-1 *	BULKHEAD-SPINNER FORWARD -----	1	
-11	0450039-2	SPACER -----	AR	
-12	0450040-1 *	BULKHEAD ASSEMBLY-SPINNER AFT -----	1	
-13	NAS680A08	NUTPLATE -----	8	
<p>NOTE. *WHEN INITIALLY ORDERING THESE PARTS FOR AIRCRAFT SERIALS 15071129 THRU 15071725, F15000530 THRU F15000595, A1500001 THRU A1500153, &amp; FA1500001 THRU FA1500026 REFER TO CESSNA SERVICE LETTER SE70-1.</p> <p>A---150 SERIAL 15071129 THRU 15072003            B---150 SERIAL 15071129 THRU 15072003            F150 SERIAL F15000530 THRU F15000658            A150 SERIAL A1500001 THRU A1500226            FA150 SERIAL FA1500001 THRU FA1500081</p>				

Propeller (Cont)

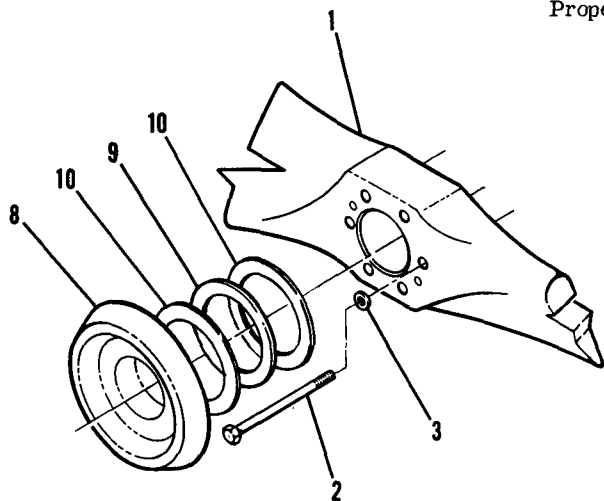

CODE J

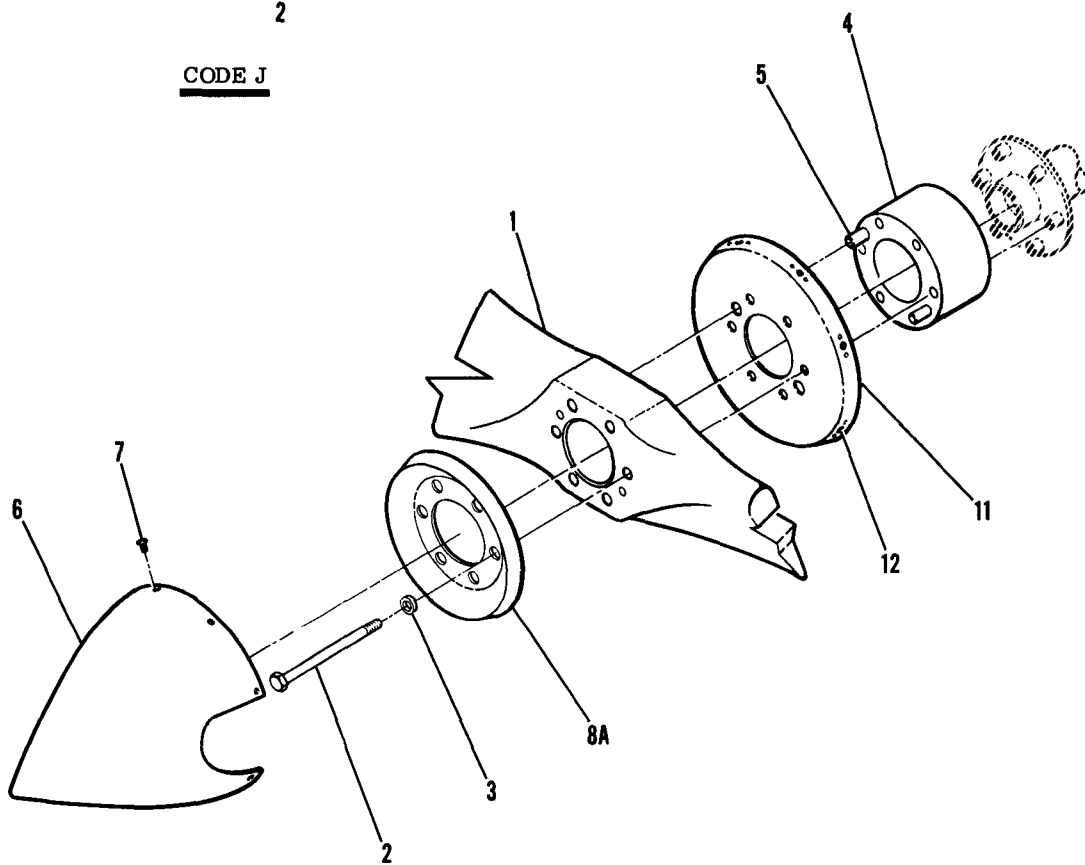

150 SERIAL 15072004 & ON  
F150 SERIAL F15000659 & ON  
A150 SERIAL A1500227 & ON  
FA150 SERIAL FA1500082 THRU FA1500121

Figure 53A. Propeller and Spinner Installation

FIGURE AND INDEX NO.	PART NUMBER	DESCRIPTION	UNITS PER ASSY	USABLE ON CODE
53A-		<b>PROPELLER &amp; SPINNER INSTALLATION</b> -----	NP	A
- 1	C161001-0401	PROPELLER ASSEMBLY 1A101/GCM6948 MCCAULEY -----	1	B
		WEU C161001-0402 -----		
	C161001-0402	PROPELLER ASSEMBLY 1A101/HCM6948 MCCAULEY -----	1	E
	C161001-0403	PROPELLER ASSEMBLY 1A102/OCM6948 MCCAULEY -----	1	G
	C161001-0404	PROPELLER ASSEMBLY 1A101/PCM6948 MCCAULEY -----	1	F
	C161001-0405	PROPELLER ASSEMBLY 1A101/HCM6948 MCCAULEY -----	1	F
		ALTERNATE FOR C161001-0404 -----		
		ATTACHING PARTS -----		
- 2	A2513-51	BOLT MCL USE WITH C161001-0401 ONLY -----	6	B
	A2513-52	BOLT MCL -----	6	C
- 3	A1638-14	WASHER MCL USE WITH C161001-0401 ONLY -----	6	B
	AN960-616L	WASHER MCL -----	6	C
		-----*		
- 4	B4304	SPACER-PROPELLER MCL USE WITH C161001-0401 ONLY -----	1	B
	B4351	SPACER-PROPELLER MCL USE WITH C161001-0402 & -----	1	C
		C161001-0405 ONLY -----		
	C4593	SPACER-PROPELLER MCL USE WITH C161001-0403 & -----	1	H
		C161001-0404 ONLY -----		
	C4513	SPACER-PROPELLER ALT MCL USE WITH -----	1	H
		C161001-0403 & C161001-0404 ONLY -----		
- 5	A2973-2	PIN-DOWEL MCL -----	2	
- 6	0450042-1	SPINNER-PROPELLER -----	1	
		ATTACHING PARTS -----		
- 7	AN525-832R7	SCREW -----	8	
		-----*		
- 8		BULKHEAD-SPINNER FWD FSO 0450050-1 SEE NOTE * -----	NP	J
- 8A	0450050-1	BULKHEAD-SPINNER FWD -----	1	K
- 9	0450039-2	SPACER NOT USED WITH 0450050-1 -----	AR	J
-10	0450039-5	SPACER NOT USED WITH 0450050-1 -----	2	J
-11	0450046-1	BULKHEAD ASSEMBLY-SPINNER AFT WEU 0450046-3 -----	1	D
	0450046-3	BULKHEAD ASSEMBLY-SPINNER AFT -----	1	H
-12	NAS680A08	NUTPLATE -----	8	
<p>NOTE. *WHEN INITIALLY ORDERING THESE PARTS FOR AIRCRAFT SERIALS 15072004 THRU 15075781, F15000659 THRU F15001143, A1500227 THRU A1500523 &amp; FA1500082 THRU FA1500121 REFER TO CESSNA SERVICE LETTER SE74-18.</p> <p>A---150 SERIAL 15072004 &amp; ON F150 SERIAL F15000659 &amp; ON A150 SERIAL A1500227 &amp; ON FA150 SERIAL FA1500082 THRU FA1500121</p> <p>B---150 SERIAL 15072004 THRU 15072472 F150 SERIAL F15000659 THRU F15000738 A150 SERIAL A1500227 THRU A1500258 FA150 SERIAL FA1500082 THRU FA1500121</p> <p>C---150 SERIAL 15072473 &amp; ON F150 SERIAL F15000739 &amp; ON A150 SERIAL A1500259 &amp; ON</p> <p>D---150 SERIAL 15072004 THRU 15074850 F150 SERIAL F15000659 THRU F15001013 A150 SERIAL A1500227 THRU A1500429 FA150 SERIAL FA1500082 THRU FA1500121</p> <p>E---150 SERIAL 15072473 THRU 15074850 F150 SERIAL F15000739 THRU F15001013 A150 SERIAL A1500259 THRU A1500429</p> <p>F---150 SERIAL 15074851 THRU 15075781 F150 SERIAL F15001014 THRU F15001143</p> <p>G---150 SERIAL 15075782 &amp; ON F150 SERIAL F15001144 &amp; ON A150 SERIAL A1500430 &amp; ON</p> <p>H---150 SERIAL 15074851 &amp; ON F150 SERIAL F15001014 &amp; ON A150 SERIAL A1500430 &amp; ON</p> <p>J---150 SERIAL 15072004 THRU 15075781 F150 SERIAL F15000659 THRU F15001143 A150 SERIAL A1500227 THRU A1500523 FA150 SERIAL FA1500082 THRU FA1500121</p> <p>K---150 SERIAL 15075782 &amp; ON F150 SERIAL F15001144 &amp; ON A150 SERIAL A1500524 &amp; ON</p>				

Winterization

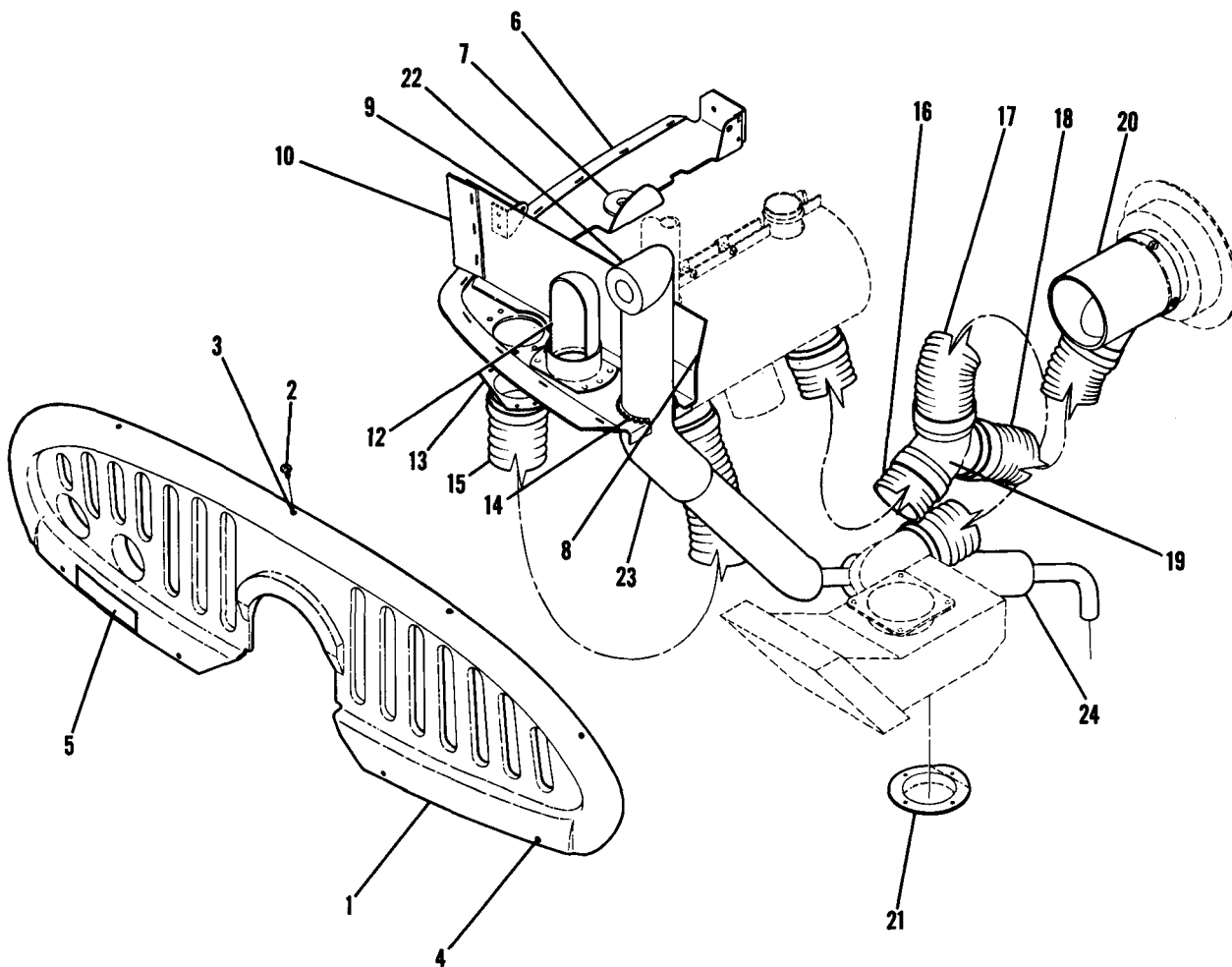

150 SERIAL 15071129 THRU 15072003  
F150 SERIAL F15000530 THRU F15000658  
A150 SERIAL A1500001 THRU A1500226  
FA150 SERIAL FA1500001 THRU FA1500081

Figure 54. Winterization Equipment Installation

FIGURE AND INDEX NO.	PART NUMBER	DESCRIPTION	UNITS PER ASSY	USABLE ON CODE
54 -		WINTERIZATION EQUIPMENT INSTALLATION -----	NP	A
- 1	0452007-2-791	COVER-COWL OPENING ----- ATTACHING PARTS -----	1	
- 2	S1021Z8-6	SCREW -----	9	
- 3	S1863-3	NUTPLATE -----	5	
- 4	S1862-2	NUTPLATE ----- -----*	4	
- 5	0552110-1	PLACARD-WINTERIZATION -----	1	
	0450502-39	BAFFLE ASSEMBLY-ENGINE -----	1	
- 6	0450502-13	SEAL -----	1	
- 7	MS35489-15	GROMMET -----	1	
- 8	0450302-1	BAFFLE ASSEMBLY-VERTICAL -----	1	
- 9	0450302-3	BRACKET -----	1	
-10	0450302-4	SEAL -----	1	
-11		DELETED -----		
-12	0450266-1	SCOOP ASSEMBLY -----	1	
-13	0450262	UNION -----	2	
-14	S1050-1	GROMMET-* IN LG BULK ITEM REF S1050-1-* -----	1	
-15	S1053K16T	HOSE-18.25 IN LG BULK ITEM REF S1053E16T-18.25 -----	1	
-16	S1053K16T	HOSE-10.00 IN LG BULK ITEM REF S1053K16T-10.00 -----	1	
-17	S1053K16T	HOSE-7.50 IN LG BULK ITEM REF S1053K16T-7.50 -----	1	
-18	S1053K16T	HOSE-11.50 IN LG BULK ITEM REF S1053K16T-11.50 ----- ATTACHING PARTS -----	1	
	NAS397-32	CLAMP ----- -----*	2	
-19	0450408-1	TUBE ASSEMBLY-DUAL HEATER -----	1	
-20	0453117-1	TEE ASSEMBLY-CABIN HEATER ----- ATTACHING PARTS -----	1	
	S1021Z8-6	SCREW ----- -----*	4	
-21	0452006-1	CAP-AIRBOX -----	1	
-22	0456004-1	VENT TUBE ASSY-WINTERIZATION -----	1	
-23	0456004-200	TUBE ASSEMBLY-INSULATING -----	1	
-24	0456004-6	TUBE-INSULATING -----	1	
<p>NOTE. *LENGTH TO BE DETERMINED LATER</p> <p>A---150 SERIAL 15071129 THRU 15072003            F150 SERIAL F15000530 THRU F15000658            A150 SERIAL A1500001 THRU A1500226            FA150 SERIAL FA1500001 THRU FA1500081</p>				

Winterization (Cont)

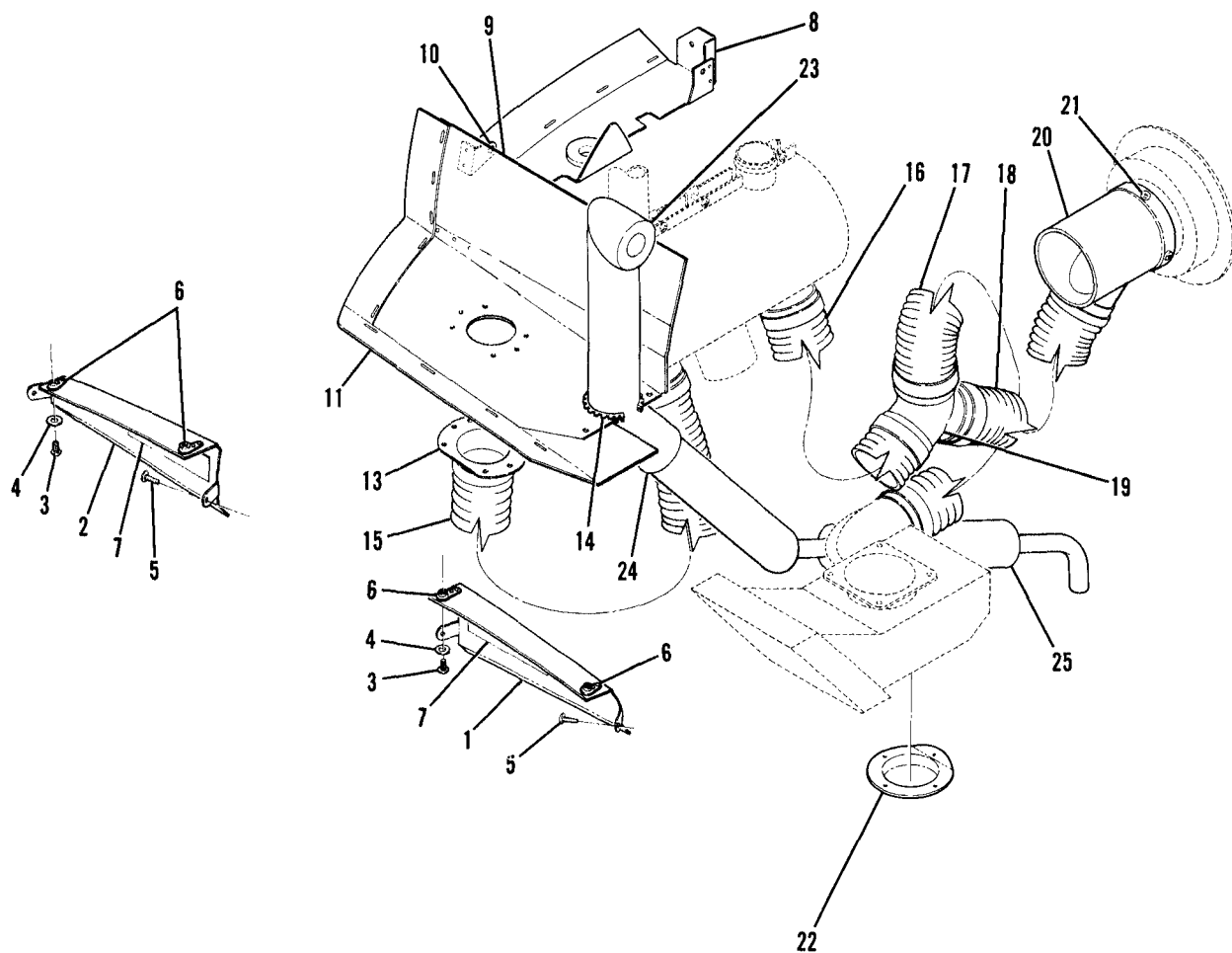

150 SERIAL 15072004 & ON  
F150 SERIAL F15000659 & ON  
A150 SERIAL A1500227 & ON  
FA150 SERIAL FA1500082 & ON

Figure 54A. Winterization Equipment Installation

FIGURE AND INDEX NO.	PART NUMBER	DESCRIPTION	UNITS PER ASSY	USABLE ON CODE
		<b>1 2 3 4 5 6 7</b>		
54A-		WINTERIZATION EQUIPMENT INSTALLATION -----	NP	A
- 1	0450409-1	COVER ASSEMBLY-NOSE CAP LH -----	1	
- 2	0450409-2	COVER ASSEMBLY-NOSE CAP RH -----	1	
		ATTACHING PARTS -----		
- 3	AN520-10R6	SCREW -----	2	
- 4	AN960D10L	WASHER -----	2	
- 5	S102128-8	SCREW -----	2	
		-----*		
- 6	NAS682A3K	NUTPLATE -----	2	
- 7	0552110-1	PLACARD WEU 0552110-3 -----	1	B
		PLACARD -----	1	C
- 8	SEE FIG 59A	BAFFLE ASSEMBLY-HORIZONTAL RH -----	1	
- 9	0455001-14	BAFFLE ASSEMBLY-VERTICAL RH -----	1	
-10	0450302-3	BRACKET -----	1	
-11	0455001-10	SEAL -----	1	
-12		DELETED, NEVER USED -----		
-13	0450262	UNION -----	1	
-14	S1050-1	GROMMET-* IN LG BULK ITEM REF S1050-1-* -----	1	
-15	S1053K16T	HOSE-18.25 IN LG BULK ITEM REF S1053K16T-18.25 -----	1	
-16	S1053K16T	HOSE-10.00 IN LG BULK ITEM REF S1053K16T-10.00 -----	1	
-17	S1053K16T	HOSE-7.50 IN LG BULK ITEM REF S1053K16T-7.50 -----	1	
-18	S1053K16T	HOSE-11.50 IN LG BULK ITEM REF S1053K16T-11.50 -----	1	
		ATTACHING PARTS -----		
	NAS397-22	CLAMP -----	2	
		-----*		
-19	0450408-1	TUBE ASSEMBLY-DUAL HEATER -----	1	
-20	0453117-1	TEE ASSEMBLY-CABIN HEATER -----	1	
		ATTACHING PARTS -----		
-21	S102128-6	SCREW -----	4	
		-----*		
-22	0452006-1	CAP-AIRBOX -----	1	
-23	0456004-1	VENT TUBE ASSY-WINTERIZATION -----	1	
-24	0456004-200	TUBE ASSEMBLY-INSULATING -----	1	
-25	0456004-6	TUBE-INSULATING -----	1	
		 NOTE. *LENGTH TO BE ADDED LATER		
		 A---150 SERIAL 15072004 & ON F150 SERIAL F15000659 & ON A150 SERIAL A1500227 & ON FA150 SERIAL FA1500082 & ON		
		B---150 SERIAL 15072004 THRU 15074850 FA150 SERIAL FA1500082 & ON A150 SERIAL A1500227 THRU A1500429 FA150 SERIAL FA1500082 THRU FA1500211		
		C---150 SERIAL 15074851 & ON F150 SERIAL F15001014 & ON A150 SERIAL A1500430 & ON FA150 SERIAL FA1500212 & ON		

Cowling

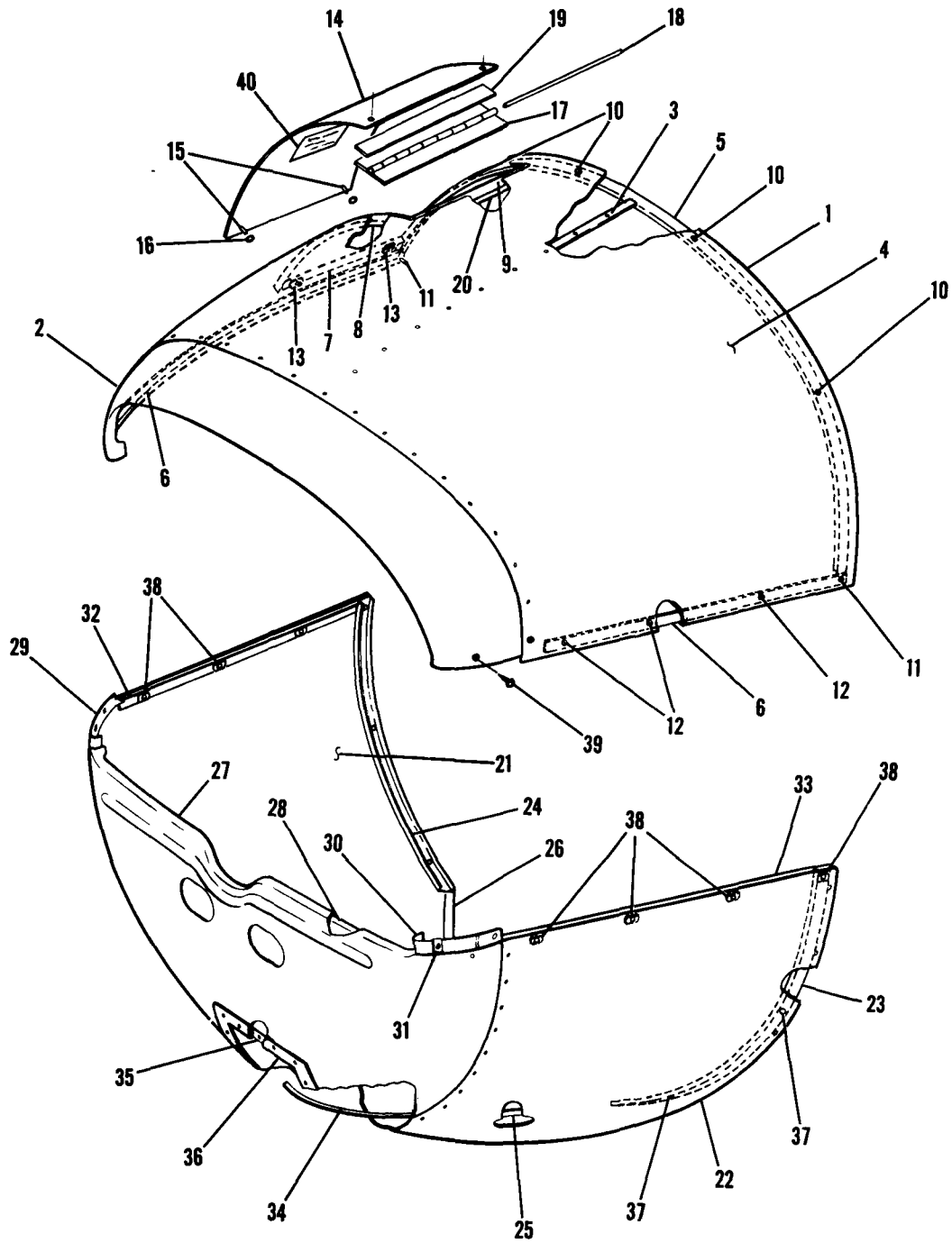

150 SERIAL 15071129 THRU 15072003  
F150 SERIAL F15000530 THRU F15000658  
A150 SERIAL A1500001 THRU A1500226  
FA150 SERIAL FA1500001 THRU FA1500081

Figure 55. Engine Cowling Assembly

FIGURE AND INDEX NO.	PART NUMBER	DESCRIPTION	UNITS PER ASSY	USABLE ON CODE
		<b>1 2 3 4 5 6 7</b>		
55 -		ENGINE COWL ASSEMBLY -----	NP	A
- 1	0452003-2	COWL ASSEMBLY-UPPER -----	1	
- 2	0452002-6	NOSECAP-UPPER CGWL -----	1	
- 3	0452003-14	ANGLE-UPPER COWL TOP -----	1	
- 4	0452003-4	SKIN ASSEMBLY-UPPER COWL -----	1	
- 5	0452003-11	CHANNEL-UPPER COWL -----	1	
- 6	0452003-17	DOUBLER-UPPER COWL LH -----	1	
	0452003-16	DOUBLER-UPPER COWL RH -----	1	
- 7	0452004-1	DOUBLER-DOOR LOWER -----	1	
- 8	0452003-28	DOUBLER-UPPER COWL -----	1	
- 9	0452003-25	DOUBLER-UPPER COWL DOOR OPENING -----	1	
-10	S1115-32	STUD PHILLIPS HEAD -----	4	
-11	S1115-35	STUD PHILLIPS HEAD -----	2	
-12	S1115-33	STUD PHILLIPS HEAD -----	6	
	S1115-9	RING ATTACH STUD -----	12	
-13	S1115-19	RECEPTACLE -----	2	
-14	0452003-20	DOOR ASSEMBLY-COWL ACCESS -----	1	
-15	S1115-21	STUD -----	2	
-16	S1115-9	RING ATTACH STUD -----	2	
-17	0452003-22	HINGE ASSEMBLY -----	1	
-18	MS20253-2-7.00	PIN-HINGE -----	1	
-19	0452003-27	SPACER BETWEEN HINGE & DOOR -----	1	
-20	0452003-15	ANGLE -----	1	
	0452003-3	COWL ASSEMBLY-LOWER -----	1	
-21	0452003-6	SKIN ASSEMBLY-LOWER COWL RH -----	1	
-22	0452003-7	SKIN ASSEMBLY-LOWER CGWL LH -----	1	
-23	0452003-13	CHANNEL-LOWER COWL LH -----	1	
-24	0452003-12	CHANNEL-LOWER COWL RH -----	1	
-25	0452002-29	DOUBLER-EXHAUST OPENING -----	1	
-26	0452003-26	DOUBLER-AFT LOWER -----	1	
-27	0452002-45	NOSECAP ASSEMBLY-LOWER COWL -----	1	
-28	0452002-43	DOUBLER-NOSECAP -----	1	
-29	0452002-16	DOUBLER-NOSECAP RH -----	1	
-30	0452002-17	DOUBLER-NOSECAP LH -----	1	
-31	NAS395-18-3	NUT -----	6	
-32	0452003-18	ANGLE-SIDE RH -----	1	
-33	0452003-19	ANGLE-SIDE LH -----	1	
-34	0452002-42	ANGLE-LOWER -----	1	
-35	0452002-30	DOUBLER-AIRSCOOP -----	1	
-36	0452200-1	FAIRING-AIR SCOOP -----	1	
-37	S1115-32	STUD PHILLIPS HEAD -----	6	
	S1115-9	RING ATTACH STUD -----	6	
-38	S1115-19	RECEPTACLE -----	8	
-39	S1021Z8-8	SCREW ATTACH UPPER TO LOWER NOSECAP -----	6	
-40	S1397-5	PLACARD-ENGINE OIL CHANGE -----	1	
<p>A---150 SERIAL 15071129 THRU 15072003            F150 SERIAL F15000530 THRU F15000658            A150 SERIAL A1500001 THRU A1500226            FA150 SERIAL FA1500001 THRU FA1500081</p>				

Cowling (Cont)

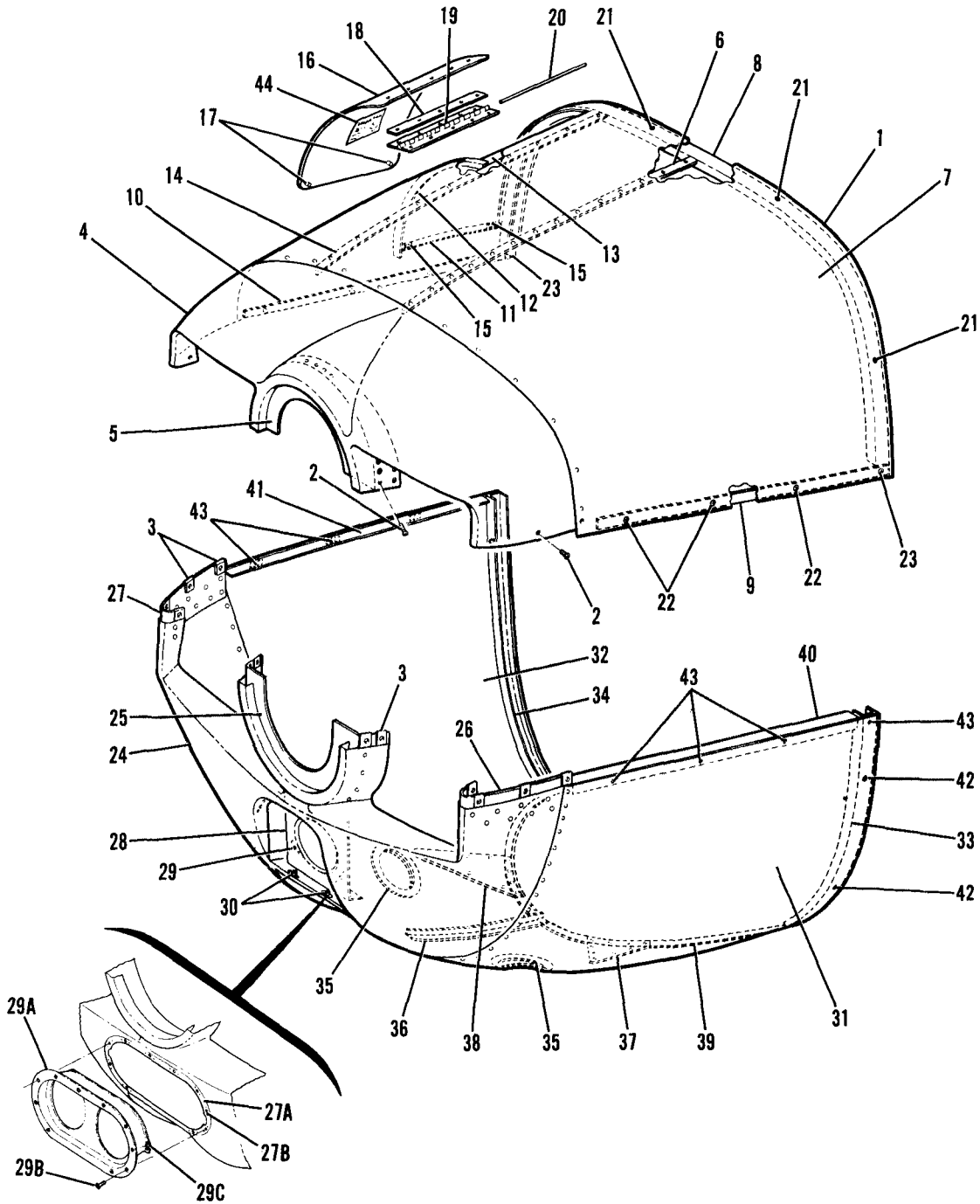

DUAL LANDING LIGHT

150 SERIAL 15072004 & ON  
 F150 SERIAL F15000659 & ON  
 A150 SERIAL A1500227 & ON  
 FA150 SERIAL FA1500082 & ON

Figure 55A. Engine Cowl Assembly

FIGURE AND INDEX NO.	PART NUMBER	DESCRIPTION	UNITS PER ASSY	USABLE ON CODE		
					1	2
55A-		ENGINE COWL ASSEMBLY -----	NP	A		
- 1	0452010-3	COWL ASSEMBLY-UPPER -----	1			
		ATTACHING PARTS -----				
- 2	S102128-8	SCREW -----	12			
- 3	NAS395-17-3	NUT -----	12			
		-----*				
- 4	0452011-2	NOSECAP ASSEMBLY-UPPER COWL -----	1			
- 5	0452012-1	STIFFENER-NOSECAP UPPER -----	1			
- 6	0452010-4	STIFFENER-UPPER COWL TOP -----	1			
- 7	0452003-4	SKIN ASSEMBLY-UPPER COWL -----	1			
- 8	0452003-11	CHANNEL-UPPER COWL -----	1			
- 9	0452003-17	DOUBLER-UPPER COWL LH -----	1			
-10	0452003-16	DOUBLER-UPPER COWL RH -----	1			
-11	0452004-1	DOUBLER-DOOR LOWER -----	1			
-12	0452003-28	DOUBLER-DOOR -----	1			
-13	0452003-25	DOUBLER-DOOR UPPER -----	1			
-14	0452010-9	STIFFENER -----	1			
-15	S1115-19	RECEPTACLE -----	2			
-16	0452003-20	DOOR ASSEMBLY-COWL ACCESS -----	1			
-17	S1115-21	STUD -----	2			
	S1115-9	RING ATTACH STUD -----	2			
-18	0452003-27	SPACER -----	1			
-19	0452003-22	HINGE ASSEMBLY -----	1			
-20	MS20253-2-7.00	PIN-HINGE -----	1			
-21	S1115-32	STUD -----	4			
-22	S1115-33	STUD -----	6			
-23	S1115-35	STUD -----	2			
	S1115-9	RING ATTACH STUD -----	12			
	0452010-2	COWL ASSEMBLY-LGWER WITHOUT LANDING LIGHT PROVISIONS -----	1			
	0452010-200	COWL ASSEMBLY-LOWER WITH SINGLE LANDING LIGHT PROVISIONS -----	1	B		
	0452010-201	COWL ASSEMBLY-LOWER WITH SINGLE LANDING LIGHT PROVISIONS -----	1	C		
	0452010-18	COWL ASSEMBLY-LOWER WITH DUAL LANDING LIGHT PROVISIONS -----	1	D		
-24	0452011-1	NOSECAP ASSEMBLY-LGWER WITHOUT LANDING LIGHT PROVISION -----	1			
	0452011-200	NOSECAP ASSY-LOWER WITH SINGLE LANDING LIGHT PROVISIONS -----	1	B		
	0452011-201	NOSECAP ASSY-LOWER WITH SINGLE LANDING LIGHT PROVISIONS -----	1	C		
	0452011-6	NOSECAP ASSY-LOWER WITH DUAL LANDING LIGHT PROVISIONS -----	1	D		
-25	0452012-2	STIFFENER-NOSECAP LOWER -----	1			
-26	0452012-5	DOUBLER ASSEMBLY-LH -----	1			
-27	0452012-6	DOUBLER ASSEMBLY-RH -----	1			
	S1863-2	NUTPLATE -----	1			
-27A	0452009-9	DOUBLER ASSY USED WITH DUAL LANDING LIGHT PROVISIONS -----	1	D		
-27B	NAS697A08	NUTPLATE -----	13	D		
-28	0452014-1	BRACKET ASSEMBLY-SINGLE LANDING LIGHT SUPPORT -----	1	B		
	0452018-5	BRACKET ASSEMBLY-SINGLE LANDING LIGHT SUPPORT -----	1	C		
-29	NAS680A08	NUTPLATE -----	3			
-29A	0452009-11	SUPPORT ASSY USED WITH DUAL LANDING LIGHT PROVISIONS -----	1	D		
		ATTACHING PARTS -----				
-29B	AN515-8R6	SCREW -----	13	D		
		-----*				
-29C	NAS697A08	NUTPLATE -----	6	D		
-30	NAS680A08	NUTPLATE USED WITH SINGLE LANDING LIGHT PROVISIONS -----	6			
-31	0452010-5	SKIN ASSEMBLY-LOWER COWL LH -----	1			
-32	0452010-6	SKIN ASSEMBLY-LOWER COWL RH -----	1			
-33	0452003-13	CHANNEL-LOWER COWL LH -----	1			
-34	0452003-12	CHANNEL-LOWER COWL RH -----	1			
-35	0452002-29	DOUBLER-EXHAUST OPENING -----	1			
-36	0452010-10	STIFFENER-LOWER -----	1			
-37	0452008-1	REINFORCEMENT-LH -----	1			
-38	0452008-2	REINFORCEMENT-RH -----	1			
-39	0452003-26	DOUBLER-AFT LOWER -----	1			
-40	0452010-11	STIFFENER-SIDE LH -----	1			
-41	0452010-12	STIFFENER-SIDE RH -----	1			
-42	S1115-32	STUD -----	6			
	S1115-9	RING ATTACH STUD -----	6			
-43	S1115-19	RECEPTACLE -----	8			

CONTINUED ON NEXT PAGE

FIGURE AND INDEX NO.	PART NUMBER	DESCRIPTION	UNITS PER ASSY	USABLE ON CODE
55A-44	S1397-5	<p>1 2 3 4 5 6 7</p> <p>PLACARD-ENGINE OIL CHANGE -----</p> <p>A---150 SERIAL 15072004 &amp; ON                      F150 SERIAL F15000659 &amp; ON                      A150 SERIAL A1500227 &amp; ON                      FA150 SERIAL FA1500082 &amp; ON</p> <p>B---150 SERIAL 15072004 THRU 15072628                      F150 SERIAL F15000659 THRU F15000738                      A150 SERIAL A1500227 THRU A1500276                      FA150 SERIAL FA1500082 THRU FA1500166</p> <p>C---150 SERIAL 15072629 &amp; ON                      F150 SERIAL F15000739 &amp; ON                      A150 SERIAL A1500277 &amp; ON                      FA150 SERIAL FA1500167 &amp; ON</p> <p>D---150 SERIAL 15074851 &amp; ON                      F150 SERIAL F15001014 &amp; ON                      A150 SERIAL A1500430 &amp; ON                      FA150 SERIAL FA1500212 &amp; ON</p>	1	



Engine

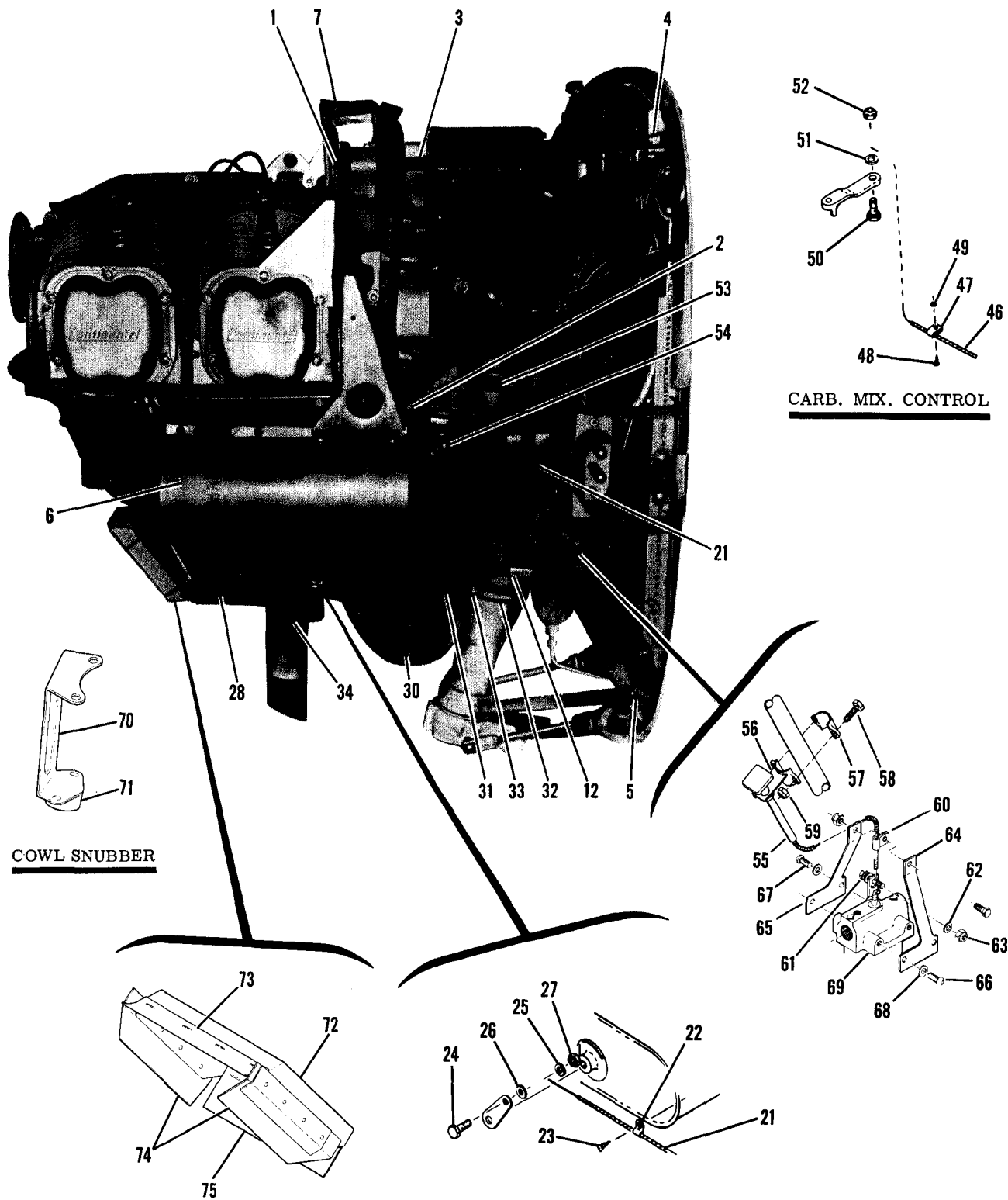

Figure 56. (Sheet 1 of 2) Engine Installation